



Ravenscroft Road, London, W4 5EQ

Cow & Co
LONDON



GUIDE PRICE £1,400,000-1,700,000. A rare opportunity to purchase this impressive property on one of Chiswick's most sought-after roads boasting period features throughout and a large private garden to the rear.

Currently divided into three separate flats, the attractive period architecture of the house immediately sets out the fabulous proportions and volumes found within.

This fantastic house comprises of three flats currently laid out as two one bedroom flats and one two bedroom flat, but is ready to be lovingly restored to an impressive family home in core Chiswick (STPP).

There is also a large cellar and a spacious back garden.

Ravenscroft Road is a pretty tree lined road and is convenient for Chiswick Park tube station (District Line) and the excellent array of shops and restaurants on Chiswick High Road.



- Chain free
- On the market for the first time in over forty years.
- Large garden
- Original features throughout
- Cellar/basement
- Bedford Park area
- Freehold property
- Potential to extend subject to planning permission

Denotes restricted head height

Ravenscroft Road , London, W4

Approximate Area = 2309 sq ft / 214.5 sq m

Limited Use Area(s) = 10 sq ft / 0.9 sq m

Total = 2319 sq ft / 215.4 sq m

For identification only - Not to scale

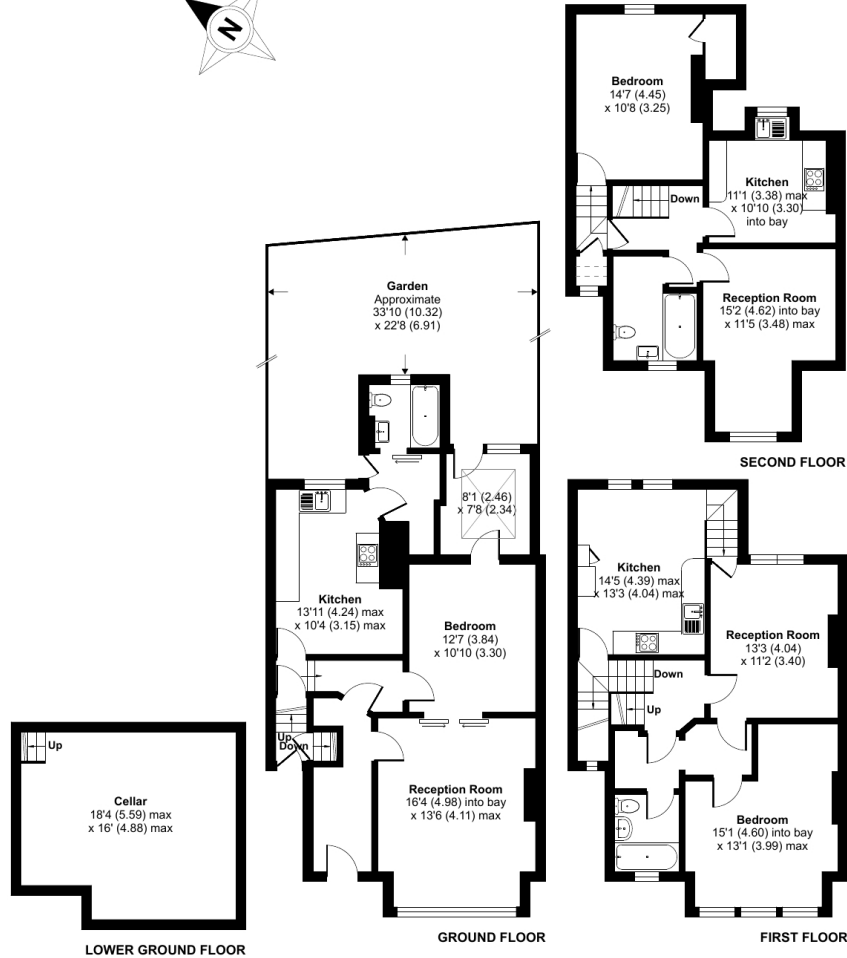

Floor plan produced in accordance with RICS Property Measurement Standards incorporating International Property Measurement Standards (IPMS2 Residential). © nchecom 2022. Produced for Cow & Co Properties Ltd. REF: 906300

Tel: 0208 065 0010
Email: thehub@cowandco-london.com
Web: cowandco-london.com

Agents note: All measurements are approximate and whilst every attempt has been made to ensure accuracy they are for general guidance only and must not be relied on. The fixture and fittings referred to have not been tested and therefore no guarantee can be given that they are in working order. Internal photographs are reproduced for general information and it must not be inferred that any item shown is included with the property.

Cow & Co

LONDON