

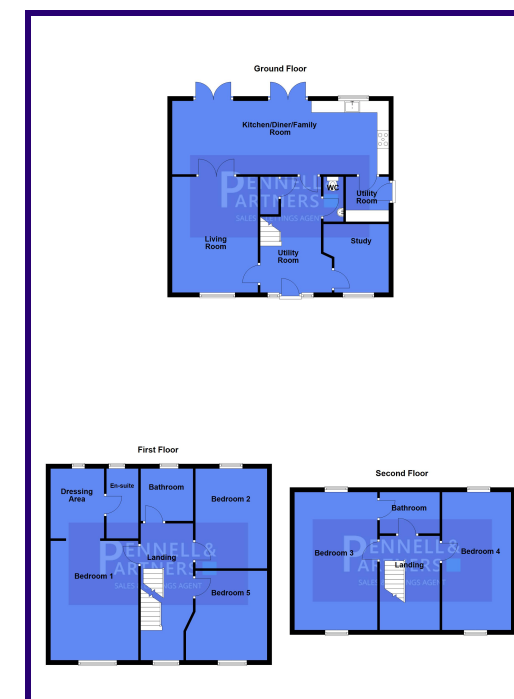

78 GLENFIELDS NORTH, WHITTLESEY, PETERBOROUGH, CAMBRIDGESHIRE. PE7 1FU

£555,000



**PENNELL & PARTNERS**

26, High Causeway, Peterborough, PE7 1AJ - 01733 209 222 -  
hello@pennellandpartners.co.uk



ABOUT THE PROPERTY

Looking for space, style and a fantastic family home? This five double bedroom detached townhouse on the ever-popular Glenfields North in Whittlesey ticks all the boxes!

Spread across three floors, this home has room for everyone – and then some! Downstairs you’ll find a bright lounge, a handy study/home office, and a stunning open-plan kitchen/diner/family room that’s perfect for entertaining, relaxing, or just day-to-day life. There's also a utility room to keep the laundry tucked away.

Upstairs, there are five genuine double bedrooms, including a luxurious master suite with its own dressing area and en-suite bathroom. You'll also find two further family bathrooms – no more morning queues!

Outside, the south-facing rear garden is mainly laid to lawn and surrounded by timber fencing, offering a safe and sunny spot for kids, pets, or a chilled BBQ with friends.

To the side, there's a double garage and driveway parking for several cars – ideal for growing families or guests.

Set in a quiet, sought-after part of Whittlesey, you’re close to local schools, shops and great transport links – but with plenty of peace and space at home.

Don’t miss this one – properties like this don’t hang around for long. Get in touch to book your viewing today!

EPC Rating: B (87)

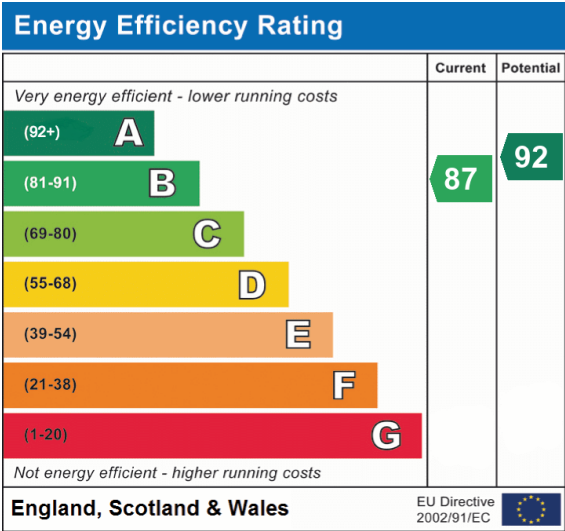

ENTRANCE HALL

LOUNGE

3.71m x 4.99m (12' 2" x 16' 4")

STUDY

2.82m x 2.99m (9' 3" x 9' 10")

KITCHEN/DINER/FAMILY ROOM

9.35m x 3.19m (30' 8" x 10' 6")

UTILITY ROOM

1.86m x 1.59m (6' 1" x 5' 3")

WC

FIRST FLOOR

BEDROOM ONE

3.74m x 5.00m (12' 3" x 16' 5") plus Dressing Room

ENSUITE BATHROOM

BEDROOM TWO

3.19m x 4.74m (10' 6" x 15' 7")

BEDROOM FIVE

3.46m x 2.79m (11' 4" x 9' 2")

SECOND FLOOR

BEDROOM THREE

3.29m x 5.74m (10' 10" x 18' 10") Jack and Jill Bathroom access

BEDROOM FOUR

3.31m x 5.74m (10' 10" x 18' 10")