

Important Notice: These Particulars have been prepared for prospective purchasers for guidance only. They are not part of an offer or contract. Whilst some descriptions are obviously subjective and information is given in good faith, they should not be relied upon as statements or representative of fact. If the property has been extended, or altered, we may not have seen evidence of planning consent or building regulation approval, although we will have made enquiries about these matters with the Vendor.

Made with Magicplan ©2025

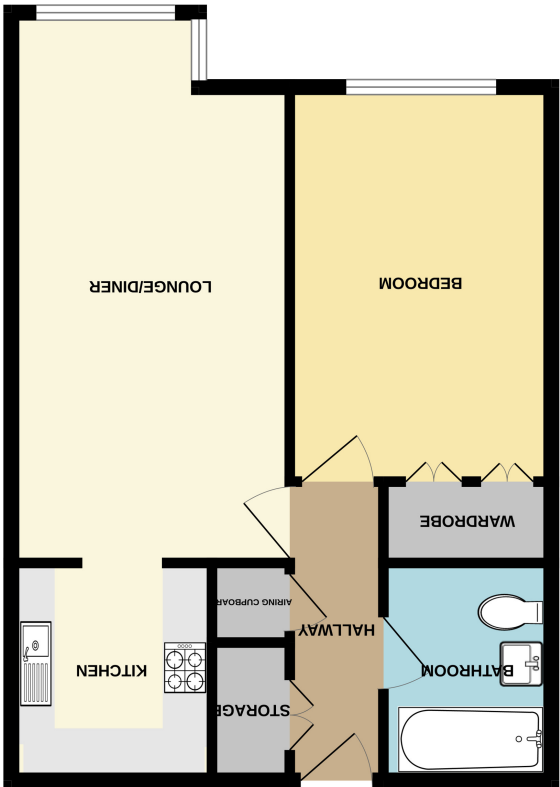

FIRST FLOOR RETIREMENT APARTMENT

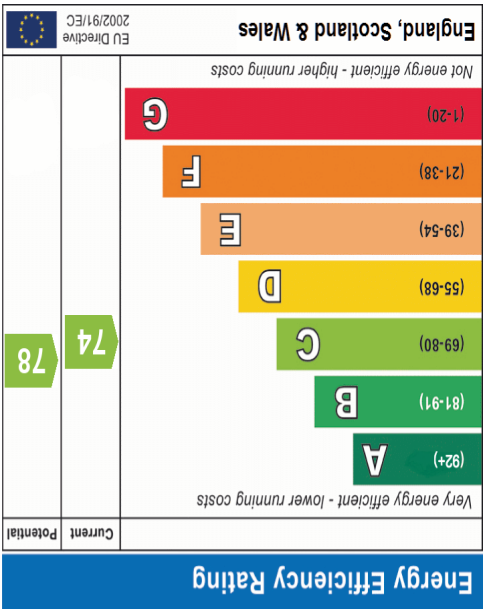



HALLWAY

10' 11" x 3' 0" (3.33m x 0.91m) Entrance hallway benefits from two large built-in storage cupboards, each measuring 3ft x 3ft; Carpeted Flooring; Loft Access; Storage Heater; Intercom Entry System; Emergency Pull Cord. Doors to; Bathroom; Bedroom; Living Room.

LIVING/DINING

19' 10" x 10' 0" (6.05m x 3.05m) A lovely light and bright living room with dining area to the box bay window, boasting uninterrupted views. Carpeted Flooring Throughout; Electric Modern Feature Fireplace; Curtains and Vertical Blinds to Double Glazed Window; Emergency Pull Cord; Ceiling Light Fitting. Entry to Kitchen.

KITCHEN

8' 0" x 7' 0" (2.44m x 2.13m) Ample wall and base units to include: Glass Display Cabinets; Corner Cabinet with Display Shelves; Drawers. Integrated Appliances to include: Electric Oven and Grill; Electric Hob; Extractor Fan; Stainless Steel Sink and Drainer; Chrome Mixer Taps. Lino Flooring; Ceiling Spot Lights.



BEDROOM

13' 10" plus built-in-robres x 9' 1" (4.22m x 2.77m) Spacious double bedroom boasting: Uninterrupted Views; Built-in Robes; Three Matching Chest of Drawers, Dresser & Mirror, Bedside Cabinets. Carpeted Flooring; Curtains and Vertical Blinds to Double Glazed Window; Ceiling Light Fitting; Emergency Pull Cord.

BATHROOM

7' 1" x 6' 0" (2.16m x 1.83m) Spacious bathroom with three-piece suite comprising of: Panelled Bath with Hot and Cold Taps; Electric Shower Over Bath; WC; Pedestal Wash Basin. Wall-Mounted Chrome Towel Radiator; Extractor Fan; Emergency Pull Cord; Shaver Socket; Wall-Mounted Mirror; Fully Tiled Walls; Non-Slip Lino Flooring; Ceiling Light Fittings.

ADDITIONAL INFORMATION

Lease Term Remaining 963 Years
Service Charge & Maintenance £255 PCM
Managing Agent - Anchor Homes
On-Site Manager
Council Tax Band B
Rochford Council

