



Bedford Road

Maples Court | Bedford Road | Hitchin | Hertfordshire | SG5 1HF

www.stonegate-estates.co.uk



BEDFORD ROAD

Property Description

We are delighted to offer for sale this well positioned one bedroomed retirement apartment situated on the first floor of this sought after town centre development.

The apartment has numerous benefits and has undergone improvement and modernisation to include a refitted kitchen, a refitted shower room, a modern electric heating upgrade, dual aspect views from the lounge and a window to the kitchen.

The development has a communal lounge and laundry facility, a development manager, gardens and parking and is ideally located within easy access to the town centre and local amenities.

Hitchin town provides a broad range of shops and a regular traditional market, together with a good selection of restaurants, bars and pubs within its historic centre. The town also provides a swimming centre, theatres and a library, whilst the commuter is served by the main line railway station (Kings Cross - 30 minutes) and direct links to the A1(M).

£170,000 Leasehold





Floor Plan

Approx. 41.6 sq. metres (448.3 sq. feet)

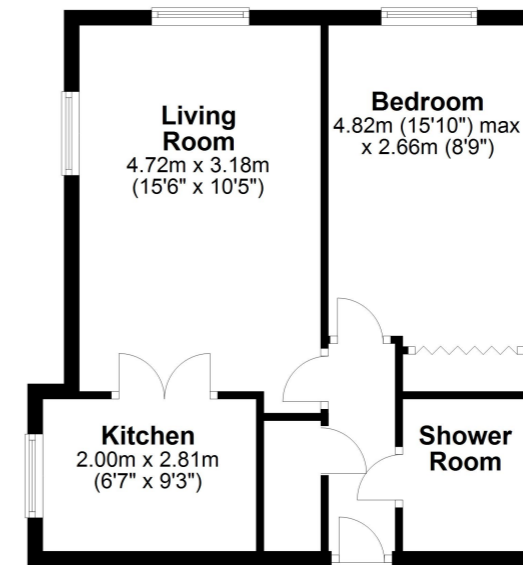

Total area: approx. 41.6 sq. metres (448.3 sq. feet)

All measurements shown are approximate and for guidance only. Garages and workshops are not included in any gross floor areas unless integral to the main building where they will be included. Plan produced using PlanUp.



- One Bedroom Retirement Apartment
- Town Centre Location
- Development Manager on Site
- Communal Gardens
- Parking
- Dual Aspect Living Room
- Window to Kitchen
- Refitted Shower Room
- Modern Kitchen

EPC Rating: C

Stonegate Estate Agents

01462 438979

sales@stonegate-estates.co.uk | www.stonegate-estates.co.uk

