



16 Malvern Road, Douglas, Isle of Man. IM2 5AR

Spacious mid-terraced 2 bed townhouse with attic room and outbuilding, priced for modernisation



£196,000 Freehold

PROPERTY DESCRIPTION

Situated at 16 Malvern Road in Douglas, this charming two-bedroom townhouse enjoys a central location just off Bray Hill. The ground floor is thoughtfully designed with a separate lounge, dining room, and kitchen, providing distinct spaces for relaxation, dining, and culinary activities. Upstairs, the home offers two spacious double bedrooms and a well-appointed four-piece bathroom. An additional staircase on the landing leads to a fully boarded attic room with Velux windows, ideal for use as an extra living space or storage.

Outside, the backyard houses the oil-fired boiler and oil tank, along with an outbuilding perfect for a small workshop or additional storage needs. While the property requires some work, it is competitively priced, presenting a fantastic opportunity for buyers looking to personalize and add value to their home. Its central location and ample potential make it a promising investment in the heart of Douglas.

INCLUSIONS As seen

RATES For latest rateable value please contact the Rates Office on 685661.

FEATURES

- Mid Terraced Home
- Price for Modernisation
- Convenient Location
- Lounge, Dining Room plus Kitchen
- 2 Double Bedrooms
- 4 Piece Bathroom
- Oil Central Heating
- Small Yard To Rear



Property Images



FLOORPLAN



GROUND FLOOR
447 sq.ft. (41.6 sq.m.) approx.

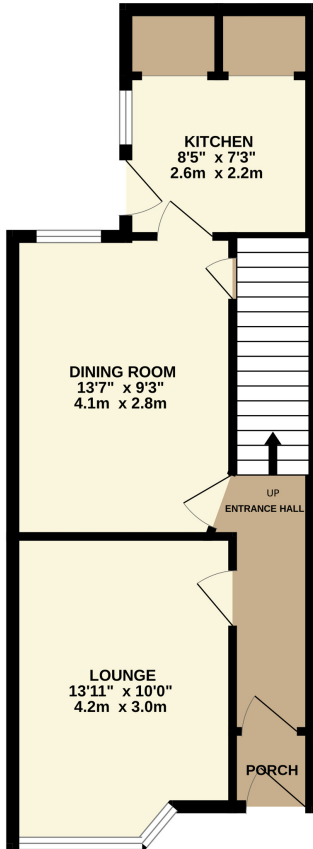

1ST FLOOR
447 sq.ft. (41.6 sq.m.) approx.

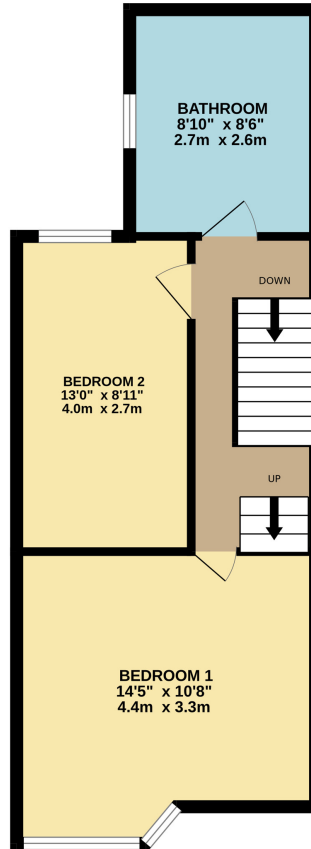

2ND FLOOR
151 sq.ft. (14.1 sq.m.) approx.

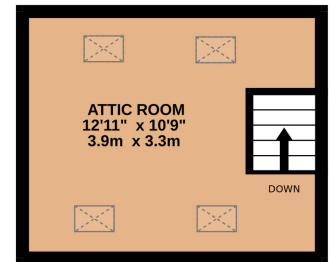

TOTAL FLOOR AREA : 1046 sq.ft. (97.2 sq.m.) approx.

Whilst every attempt has been made to ensure the accuracy of the floorplan contained here, measurements of doors, windows, rooms and any other items are approximate and no responsibility is taken for any error, omission or mis-statement. This plan is for illustrative purposes only and should be used as such by any prospective purchaser. The services, systems and appliances shown have not been tested and no guarantee as to their operability or efficiency can be given.
Made with Metropix ©2024

DISCLAIMER: Whilst Manxmove Ltd believe that these details are correct, neither Manxmove Ltd or their clients guarantee their accuracy in any way. Consequently, these details are not to be used to form part of any legally binding contract. Prospective purchasers or tenants are advised to visit this property to satisfy themselves as to the correctness of these details. Please note, we use wide angle camera lenses in order to show as much of each room as possible. This is not intended to mislead any prospective purchasers or tenants in any way and an honest verbal description is always available prior to viewing if required.