





Fantastic opportunity to purchase your first home in the highly sought after Maypole Road. This perfect first time buy is ideal for commuters. Taplow train station (Elizabeth Line), M4 junction 7 are both just a stones throw away. This delightful studio is spacious and bright throughout with a modern décor. At the front of the property you will find a fully tiled bathroom with a shower, sink and W.C. The main room offers a great space for living and sleeping and leads to a modern and bright kitchen. This property also offers allocated parking



Property Information

-  GROUND FLOOR
-  EXCELLENT CONDITION THROUGHOUT
-  86 YEARS LEASE
-  0.6 MILES TO TAPLOW STATION (CROSSRAIL)
-  IDEAL FIRST TIME BUY
-  ALLOCATED PARKING

					
x1	x1	x1	x1	N	N
Bedrooms	Reception Rooms	Bathrooms	Parking Spaces	Garden	Garage

Lease Details

From information provided to us by the vendor we understand the lease details to be as below:

Current remaining lease length - 86 Years Remaining
Current yearly service charge - £3048
Current yearly ground rent - £0

Transport Links

NEAREST STATIONS:

Taplow (0.5 miles)
Burnham (1.2 miles)
Maidenhead (2.2 miles)

The M4 (jct 7) is approximately 2 miles distant, as is the M40 (jct 2) and these in turn provide access to the M25, M3 and Heathrow Airport. British Rail connections to Paddington are available from Burnham and Maidenhead. Direct train links in to London Waterloo are available from Windsor & Eton Riverside station.

Floor Plan

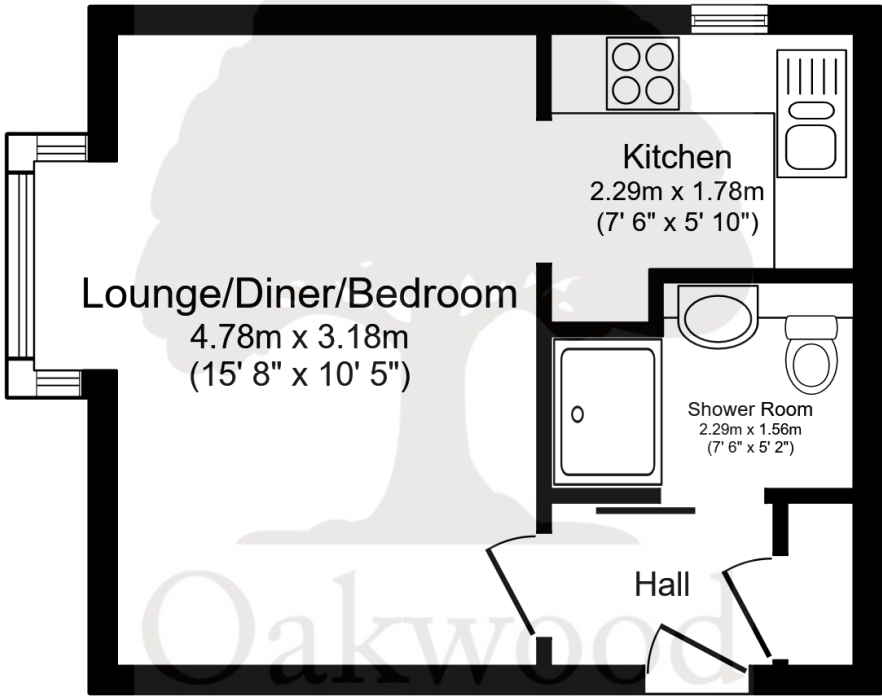

Floor Plan
Floor area 27.6 m² (297 sq.ft.)

TOTAL: 27.6 m² (297 sq.ft.)

This floor plan is for illustrative purposes only. It is not drawn to scale. Any measurements, floor areas (including any total floor area), openings and orientations are approximate. No details are guaranteed, they cannot be relied upon for any purpose and do not form any part of any agreement. No liability is taken for any error, omission or misstatement. A party must rely upon its own inspection(s). Powered by [www.Propertybox.io](#)

Prospective purchasers should be aware that these sales particulars are intended as a general guide only and room sizes should not be relied upon for carpets or furnishing. We have not carried out any form of survey nor have we tested any appliance or services, mechanical or electrical. All maps are supplied by Goview.co.uk from Ordnance Survey mapping. Care has been taken in the preparation of these sales particulars, which are thought to be materially correct, although their accuracy is not guaranteed and they do not form part of any contract.

