



Three Bedroom Terraced House

Walsingham Close, Parkwood, Rainham, Gillingham, Kent, ME8 9SJ

Guide Price £260,000

Freehold

Walsingham Close, Parkwood, Rainham, Gillingham, Kent, ME8
9SJ

Guide Price £260,000

Freehold

Description

**Guide Price £260,000 - £280,000 **

This fantastic three bedroom family home is chain free, conveniently located at the top end of Parkwood making it ideal for local primary schools, shops and great access to the M2/M20 motorway links to London and the coastal towns of Kent. The accommodation offers a spacious lounge, separate dining room, well appointed kitchen, large conservatory overlooking a low maintenance garden with a brick built outbuilding and gated rear access. Upstairs there are three good size bedrooms with the primary benefitting from built in wardrobes and a modern family shower room with a fabulous rainfall shower. This will be popular, so call the Greyfox Sales and Lettings Team in Rainham to book your viewing and avoid disappointment now.

Key Features

- No Onward Chain
- Popular Parkwood Location
- Three Bedrooms
- Modern Shower Room
- Spacious Lounge
- Large Conservatory
- Separate Dining Room
- Low Maintenance Garden With Rear Access

Local Area

Parkwood is located on the southern side of Rainham with good road links to the M2/M20 and is served by Rainham Station into central London. Parkwood offers a variety of schools and amenities and enjoys a pleasant position on the edge of rural Kent.

GROUND FLOOR
501 sq.ft. (46.6 sq.m.) approx.

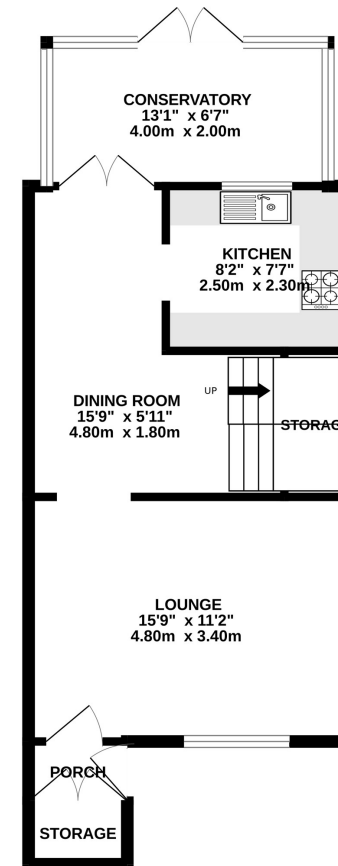

1ST FLOOR
387 sq.ft. (35.9 sq.m.) approx.

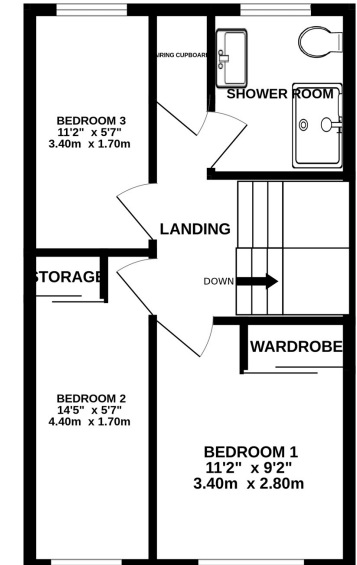

TOTAL FLOOR AREA : 888 sq.ft. (82.5 sq.m.) approx.

Whilst every attempt has been made to ensure the accuracy of the floorplan contained here, measurements of doors, windows, rooms and any other items are approximate and no responsibility is taken for any error, omission or mis-statement. This plan is for illustrative purposes only and should be used as such by any prospective purchaser. The services, systems and appliances shown have not been tested and no guarantee as to their operability or efficiency can be given.

Made with Metropix ©2023



Property Location

Walsingham Close, Parkwood, Rainham, Gillingham, Kent, ME8 9SJ

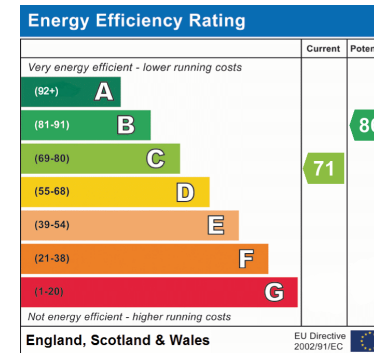
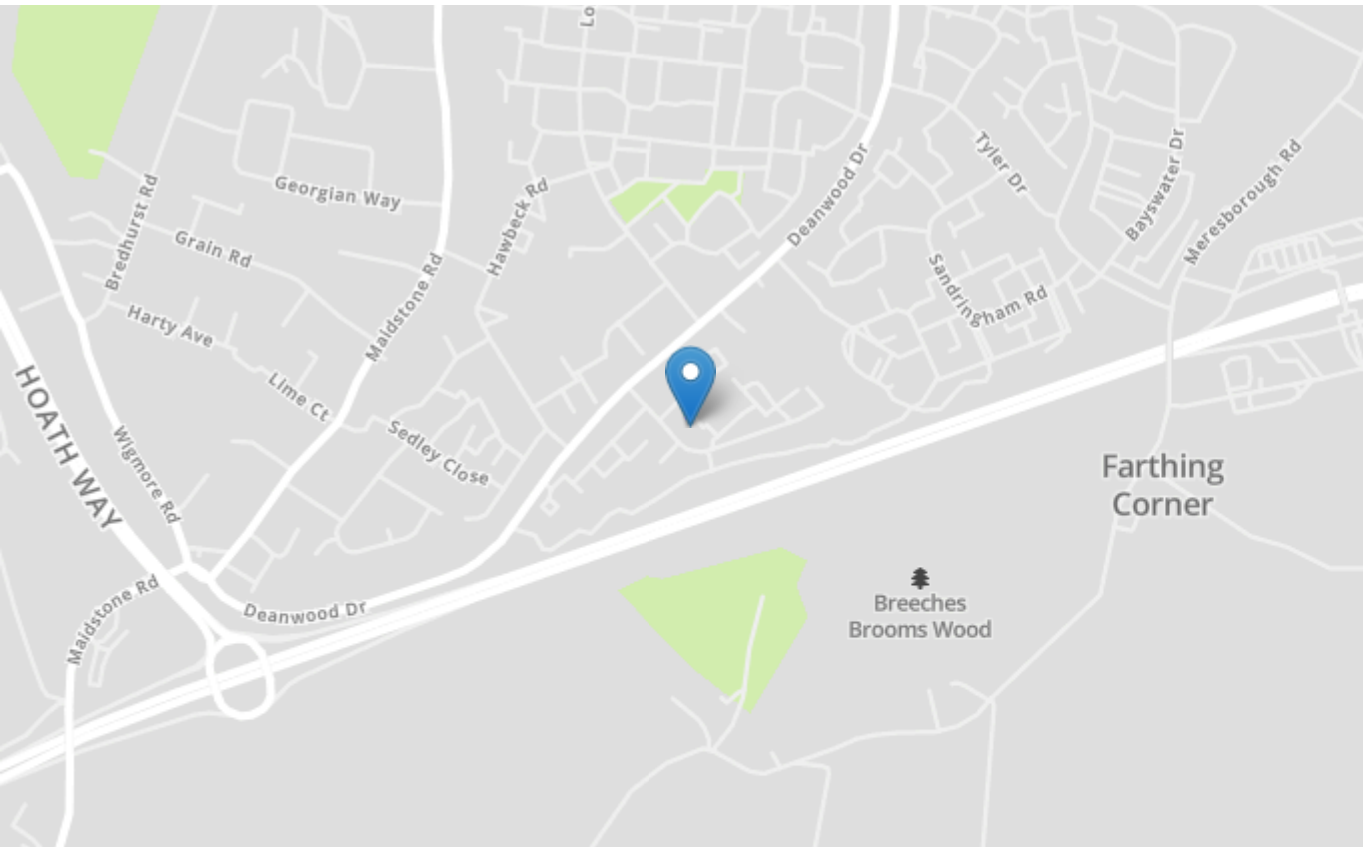

Tenure	Freehold
Lease Term	N/A
Ground Rent	N/A
Service Charge	N/A
Local Authority	Medway
Council Tax	Band B

Greyfox Walderslade

Unit 2, Thetford House
Walderslade Village Centre
Walderslade Road
Chatham
Kent
ME5 9LR
Tel: 01634 672227 Email:
walderslade@greyfox.co.uk

Greyfox Rainham

67C High Street
Rainham
Kent
ME8 7HS
Tel: 01634 377737 Email:
rainham@greyfox.co.uk

Agent Notes

These particulars are prepared as a general guide to a broad description of the property and should not be relied upon as a statement or representation of fact and do not constitute part of an offer or contract. The seller does not make or give nor do our employees or Greyfox have authority to make or give any representation or warranty to the property. We have not carried out a structural survey and the services, appliances and specific fittings have not been tested. All photographs, measurements, floorplans and distances referred to are given as a guide only and should not be relied upon for the purchase of carpets or any other fixtures or fittings. Lease details, service charges and ground rent (where applicable) and council tax are given as a guide only and should be checked and confirmed by you on inspection and your solicitor prior to exchange of contracts. If there are any points of particular importance to you we will be pleased to check the information for you and to confirm that the property remains available. This is particularly important should you be travelling some distance to view and where statements have been made by us to the effect that the information has not been verified. The copyright of all details, photographs and floorplans remain exclusive to Greyfox. For details of our privacy policy and referral fee arrangements with any of our selected partner companies please visit <https://www.greyfox.co.uk/legal/privacy> and <https://www.greyfox.co.uk/referral-fees>.