

Buttons Yard

Warminster, BA12 9NZ

COOPER
AND
TANNER



£99,999 Leasehold

🛏 1 🛋 1 🚿 1 EPC D

Description

Cooper and Tanner are pleased to offer this one bedroom ground floor apartment which is situated close to the town center and a great opportunity for first time buyers or a low-maintenance investment. The accommodation comprises entrance hallway, doors to kitchen, lounge/diner and one bedroom. This apartment also has its own allocated parking space plus visitor spaces, communal gardens and intercom system.

Agent Note

Please be advised that this property would achieve £675 - £695 pcm in the rental market.

Buttons Yard, Warminster, BA1

Approximate Area = 438 sq ft / 40.7sq m

For identification only - Not to scale

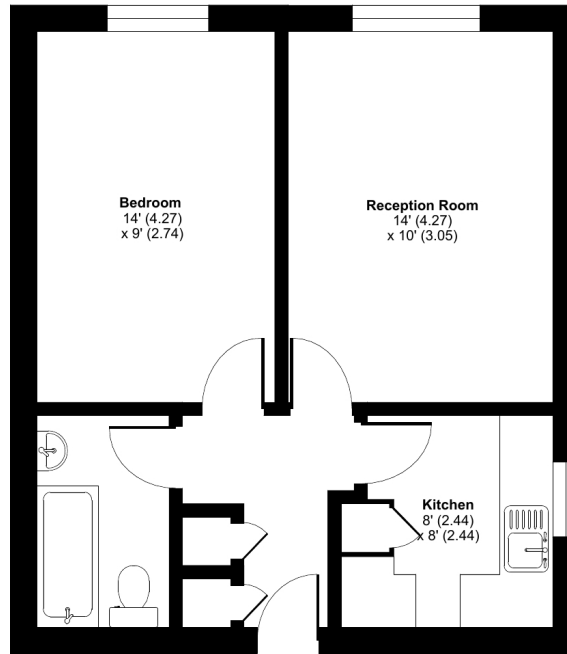

GROUND FLOOR



Floor plan produced in accordance with RICS Property Measurement Standards incorporating International Property Measurement Standards (IPMS2 Residential). © nichecom 2024. Produced for Cooper and Tanner. REF: 1100542



Features

- Ground Floor Apartment
- Kitchen
- Lounge/Diner
- Shower Room
- One Bedroom
- Intercom system
- Communal Gardens
- Parking for one car
- Visitor parking

Local Information

- Council Tax Band A
- Tenure Leasehold
- EPC Rating D

WARMINSTER OFFICE

Telephone 01985 215579

48-50, Market Place, Warminster, Wiltshire BA12 9AN

warminster@cooperandtanner.co.uk

**COOPER
AND
TANNER**

Important Notice: These particulars are set out as a general outline only for the guidance of intended purchasers and do not constitute, nor constitute part of, an offer or contract. All descriptions, dimensions, reference to condition and necessary permissions for use and occupation, warranties and other details are given without responsibility and any intending purchasers should not rely on the m as statements or rep representations of fact but must satisfy themselves by inspection or otherwise as to the correctness of each of them.

