

Truuli



Church Road, London, SE19

£435,000 Share of Freehold

- Period conversion
- Plantation Shutters
- Located in the heart of Crystal Palace
- Large entertaining space with dining
- Chatsworth Bakewell & Subway porcelain tiles
- Dulwich style roll top bath
- Victorian style heated towel rack
- Good natural light throughout

2, Lansdowne Road, Croydon, London, CR9 2ER

Tel: 0330 043 0002

Email: save@truuli.co.uk Web: www.truuli.co.uk

Church Road, London, SE19

£435,000 Share of Freehold

Please click to read vendor comments and book a viewing for this ideally located two bed property.

First Floor
835 sq.ft. (77.6 sq.m.) approx.

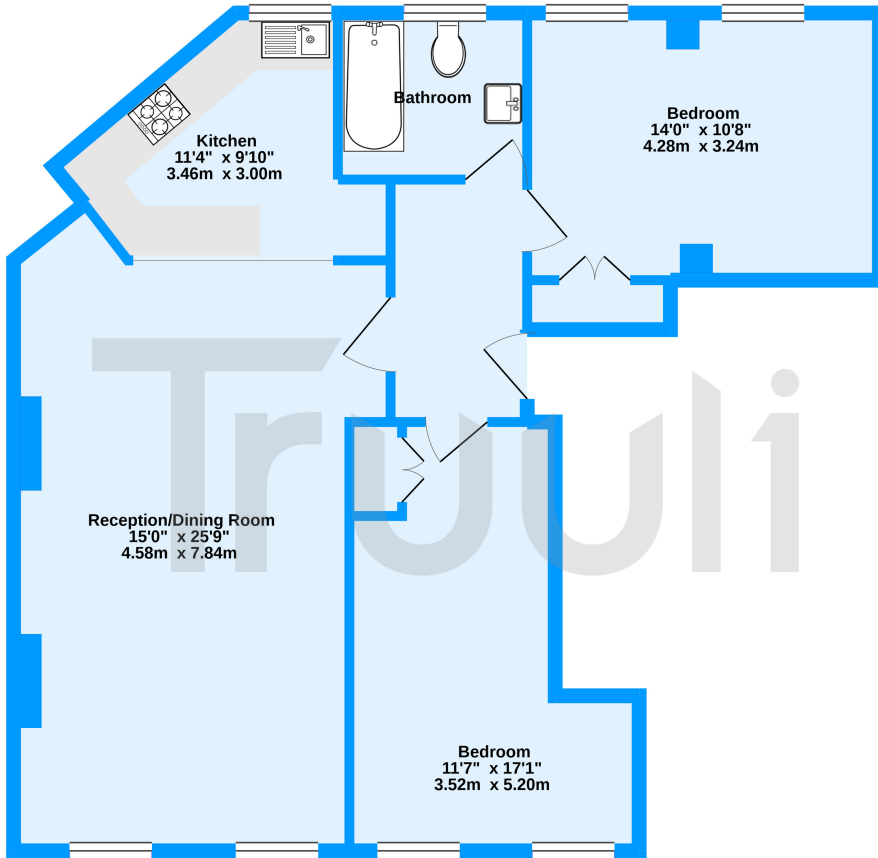

Church Road, London SE19

TOTAL FLOOR AREA : 835 sq.ft. (77.6 sq.m.) approx.

Whilst every attempt has been made to ensure the accuracy of the floorplan contained here, measurements of doors, windows, rooms and any other items are approximate and no responsibility is taken for any error, omission or mis-statement. This plan is for illustrative purposes only and should be used as such by any prospective purchaser. The services, systems and appliances shown have not been tested and no guarantee as to their operability or efficiency can be given.
Made with Metropix ©2020

Energy Efficiency Rating		Environmental Impact (CO ₂) Rating	
Current	Potential	Predicted	
Very energy efficient - lower running costs		Very environmentally friendly - lower CO ₂ emissions	
(92 to 100) A		(92 to 100) A	
(81 to 91) B		(81 to 91) B	
(69 to 80) C		(69 to 80) C	
(55 to 68) D		(55 to 68) D	
(39 to 54) E		(39 to 54) E	
(21 to 38) F		(21 to 38) F	
(1 to 20) G		(1 to 20) G	
	70 → 76		0
Not energy efficient - higher running costs		Not environmentally friendly - higher CO ₂ emissions	
EU Directive 2002/91/EC		EU Directive 2002/91/EC	
England, Wales & N.Ireland		England, Wales & N.Ireland	

