



108 New Writtle Street, Chelmsford, Essex, CM2 0RR

- TWO BEDROOM APARTMENT
- GROUND FLOOR
- CLOSE TO CITY AND STATION
- GAS CENTRAL HEATING
- DOUBLE GLAZED WINDOWS
- AVAILABLE NOW



PROPERTY DESCRIPTION

Located behind gated access is this two bedroom, ground floor apartment. Situated close to the city centre and well within walking distance to Chelmsford Mainline Station. The property benefits from Gas Central Heating, a modern kitchen and bathroom.



ROOM DESCRIPTIONS

PROPERTY INFORMATION

Communal Entrance Hall

Main to door to ground floor entrance hall, with stairs rising to upper floors.

Lounge

Front door leading through to lounge with entry phone system, bay window to front, additional window to front, two radiators

Kitchen

Fitted with a range of matching base and eye level units with complementary work surface over inset one-and-a-half bowl sink unit, built-in oven, inset hob with extractor over, window to front aspect, cupboard housing boiler.

Bathroom

Panelled bath with shower attachment over, vanity wash hand basin, built-in shelving unit, low level wc, radiator, part tiled walls, extractor.

Bedroom 1

Window to rear aspect, radiator,

Bedroom 2

Window to rear, radiator.

Outside

There is communal grounds with security entrance gate. Permit Parking to the front of the development.



FLOORPLAN

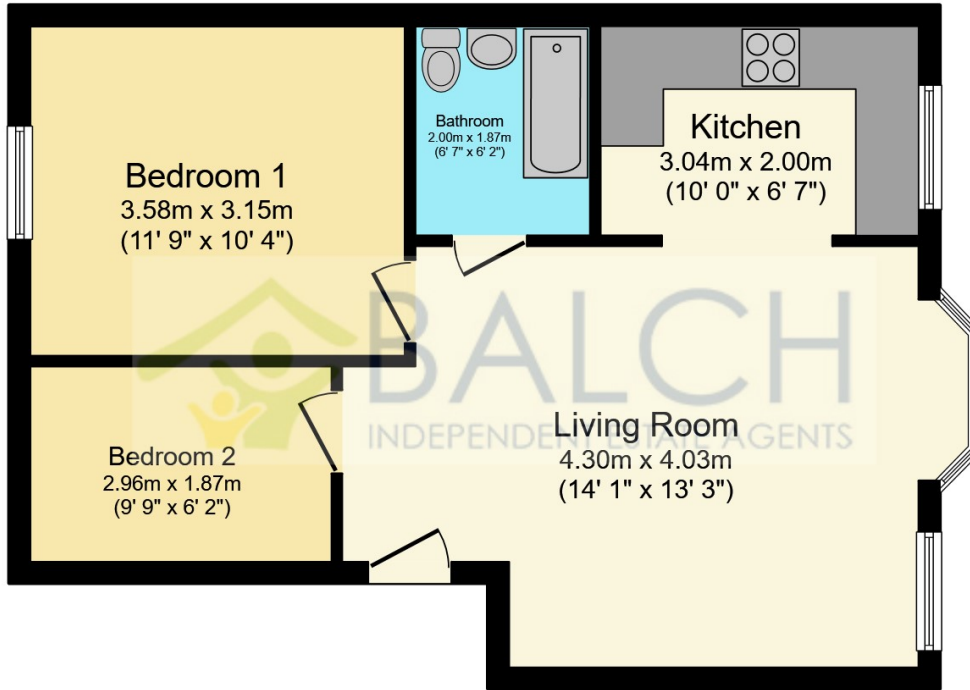

Ground Floor

Floor area 48.2 sq.m. (518 sq.ft.) approx

Total floor area 150.0 sq. m. (1,615 sq. ft.) approx

This Floor Plan is for illustration purposes only and may not be representative of the property. The position and size of doors, windows and other features are approximate. Unauthorized reproduction prohibited. © PropertyBOX