

Top Floor Flat, 4 Grove Avenue, London, N3 1QP

Guide Price £550,000

SHARE OF FREEHOLD We are pleased to offer this bright two double bedroom, two bathroom first floor flat in a house conversion. The property benefits from an open plan reception/kitchen with fitted appliances, modern bathroom and en-suite and hardwood floors. Conveniently located just 0.1 miles to the local shops, amenities and transport links of Finchley Central and just 0.3 miles from Finchley Central Underground Station. Council Tax Band D.



- Two Double Bedrooms
- Open Plan Reception/Kitchen
- 0.3 miles to Finchley Central Underground Station
- Share of Freehold
- Two Bathrooms (One En Suite)
- Hardwood Flooring
- Council Tax Band D





Approx Gross Internal Area
77 sq m / 829 sq ft

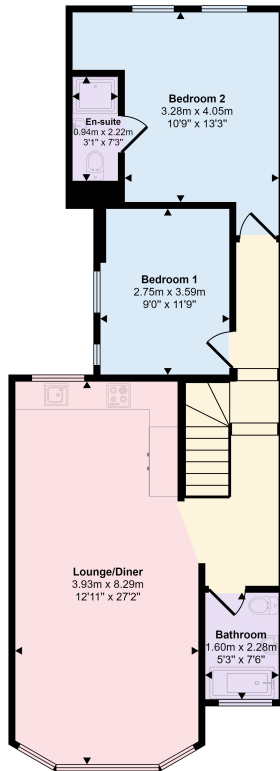

First Floor

This floorplan is only for illustrative purposes and is not to scale. Measurements of rooms, doors, windows, and any items are approximate and no responsibility is taken for any error, omission or mis-statement. Icons of items such as bathroom suites are representations only and may not look like the real items. Made with Made Snappy 360.

Energy Efficiency Rating		Current	Potential
<i>Very energy efficient - lower running costs</i>			
(92+)	A		
(81-91)	B		
(69-80)	C		
(55-68)	D		56
(39-54)	E	42	
(21-38)	F		
(1-20)	G		
<i>Not energy efficient - higher running costs</i>			
England, Scotland & Wales		EU Directive 2002/91/EC	

When you are considering a property we recommend that you instruct a surveyor to ensure the property is in sound structural order and that equipment, fitting, services, etc are in working order and/or fit for their purpose and a solicitor to verify tenure and title of the property. We can give no assurances in this regard nor can we verify accuracy of measurements or distance.

Jeremy Leaf & Co., for themselves and for their client, whose agent they are, give notice that:

- Under the terms of the Anti Money Laundering Act 2007, intending purchasers will be asked to produce identification documentation at a later stage and we would ask for your cooperation in order that there will be no delay in agreeing the sale.
- These particulars do not constitute any part of an offer or a contract.
- All statements contained in these particulars are made without responsibility on the part of Jeremy Leaf & Co or their client.
- None of the statements contained in these particulars is to be relied upon as a statement, warranty or representation of fact.
- Please note we have not tested the services or any of the equipment or appliances in this property, accordingly we strongly advise prospective buyers to commission their own survey or service reports before finalising their offer to purchase.
- Any intending purchaser or tenant must satisfy himself by inspection, or otherwise as to the correctness of each of the statements contained in these particulars.
- No person in the employment of Jeremy Leaf & Co has any authority to make any representation or warranty whatsoever in relation to this property.
- Unless otherwise stated, all prices and rents are quoted exclusive of Value Added Tax (VAT). Any intending purchasers or lessees must satisfy themselves independently as to the incidents of VAT in respect of any transaction.
- This document is not intended for distribution and may not be reproduced or further distributed or published for any purpose. In particular, any tenants detailed in this property should not be approached without prior written permission.