



Tel: 01242 676767

www.cotswoldestateagents.co.uk

41a Church Road, Bishops Cleeve, Cheltenham, GL52 8LP

2a, Ashfield Close
Bishops Cleeve GL52 8LG

£420,000



SOLD STC

Set in a small-cul-de-sac in a desirable village location is this spacious individually built three/four bedroom detached house. The comfortable well planned living accommodation features cloakroom, generous living room, dining room/bed four and kitchen/breakfast room. On the first floor there are three good size bedrooms and a family bathroom with separate shower. To the exterior there is a blocked driveway offering ample parking for three vehicles leading to an integral garage and an attractive enclosed south facing rear garden. * NO ONWARD CHAIN *

Entrance hall with doors to integral garage, cloakroom, lounge, dining room and kitchen/breakfast room and stairs to landing and first floor living accommodation. Cloakroom: window to front aspect, wash hand basin and WC. Lounge: bay window to front aspect, feature stone fireplace fitted with gas coal effect living flame fire. Dining room/bed four: window to rear garden. Kitchen/breakfast room: fitted with a matching range of eye and base level storage units and appliance space and door to rear garden.

First floor: galleried landing, window to front aspect and built-in airing cupboard, doors to family bathroom and bedrooms one, two and three. Bathroom: window to side aspect, bath with tiled splashbacks, built-in separate shower, wash hand basin and WC. Bedroom one: window to front aspect, storage cupboards, trap to loft space and built-in wardrobes. Bedroom two: window to front aspect, trap to loft space. Bedroom three: window to rear aspect.

Exterior: Front garden: partly enclosed with hedging and fencing with block paved driveway offering hardstanding for approximately three vehicles leading to integral garage, stocked with various flowers and shrub borders, side access either side of property leading to rear garden. Rear garden: south facing being enclosed with wooden panel fencing and mainly laid to lawn with patio.







Ground Floor

Approx. 84.6 sq. metres (910.9 sq. feet)

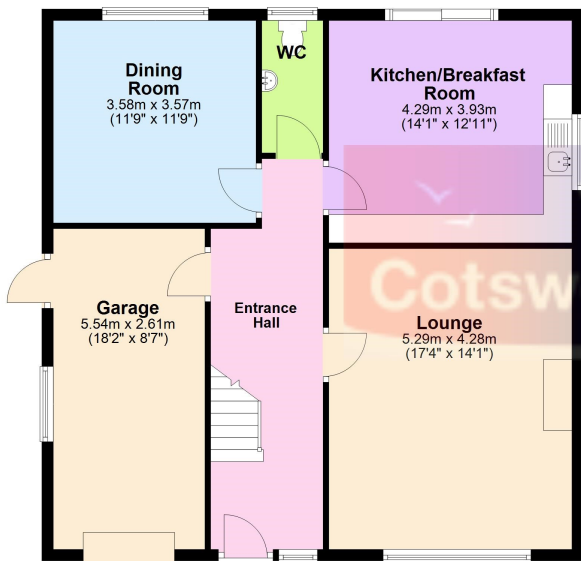

First Floor

Approx. 52.0 sq. metres (559.4 sq. feet)

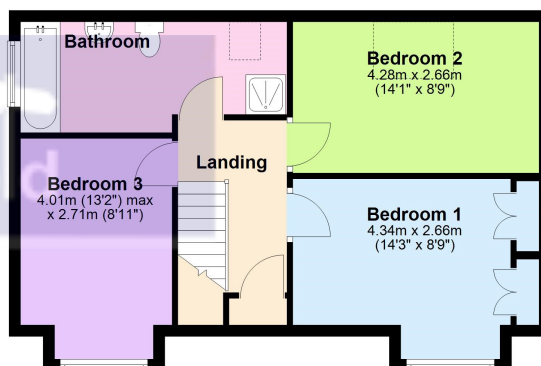

Total area: approx. 136.6 sq. metres (1470.3 sq. feet)

