



**GREGORY BROWN**  
RESIDENTIAL SALES & LETTINGS

£275,000 Leasehold

**FOR SALE**



## **Fairfield Avenue, Staines- upon-Thames, Surrey, TW18 4DN**

STUNNING ONE BEDROOM APARTMENT SITUATED WITHIN SOUGHT AFTER DEVELOPMENT IDEALLY LOCATED WITHIN MOMENTS OF STAINES TOWN CENTRE & MAINLINE TRAIN STATION. The property benefits from a spacious lounge/diner with private balcony, luxury fitted kitchen, large double bedroom, modern white bathroom suite, secure allocated parking and a long lease. Viewings Highly Recommended!

**Gregory Brown**

127a, High Street, Staines-upon-Thames, TW18 4PD

01784 451458

staines@gregory-brown.co.uk

## ROOM DESCRIPTIONS

---

# FLOORPLAN

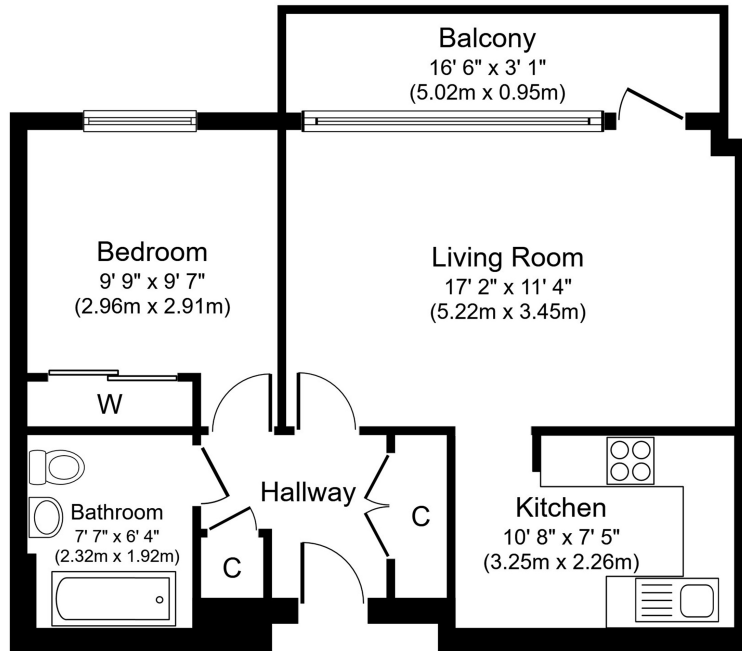

**Approximate Floor Area**  
**502 sq. ft.**  
**(46.6 sq. m.)**

Whilst every attempt has been made to ensure the accuracy of the floor plan contained here, measurements of doors, windows, rooms and any other items are approximate and no responsibility is taken for any error, omission, or mis-statement. The measurements should not be relied upon for valuation, transaction and/or funding purposes. This plan is for illustrative purposes only and should be used as such by any prospective purchaser or tenant. The services, systems and appliances shown have not been tested and no guarantee as to their operability or efficiency can be given.  
Copyright V&B Ltd 2024 | www.houseviz.com

127a, High Street, Staines-upon-Thames, TW18 4PD

01784 451458

staines@gregory-brown.co.uk