

FOR SALE

£549,950

Conway Crescent, Perivale Greenford. UB6



Peter Gamble & Co. offer to the market this 3 bedroom END OF TERRACE home. Offered as a chain free sale this freehold property offers 2 separate reception rooms and separate galley kitchen. To the first floor are the 3 bedrooms and bathroom with separate w/c. Conway Crescent is a quiet tree lined residential street in the ever popular Medway Village close to highly regarded local schools and Perivale's Central line tube station.

- * Gas central heating
- * Driveway

CALL TODAY TO BOOK YOUR VIEWING!

ground floor

Reception

Reception

Kitchen

first floor

Bedroom

Bedroom

Bedroom

Bathroom





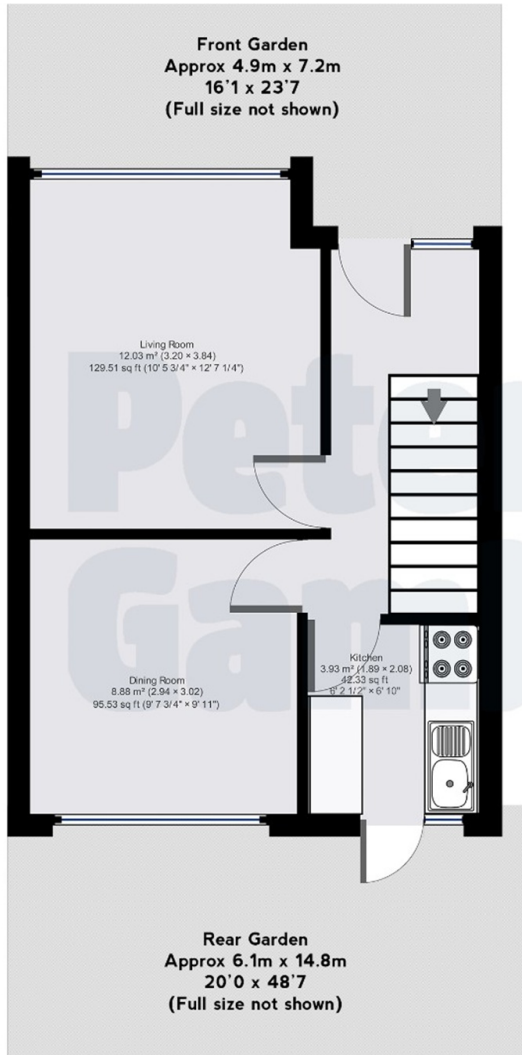

Conway Crescent

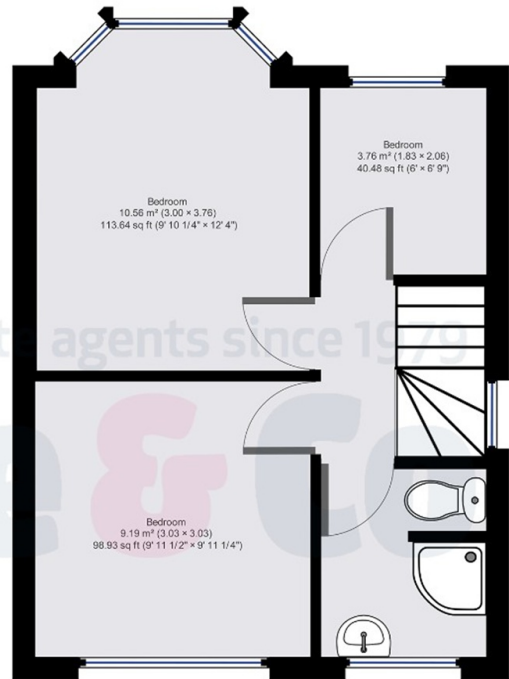

APPROX. GROSS INTERNAL FLOOR AREA: 65.2 sq. m / 702 sq.ft

WHILST EVERY ATTEMPT HAS BEEN MADE TO ENSURE THE ACCURACY OF THE FLOOR PLAN CONTAINED HERE,
 MEASUREMENTS OF DOORS, WINDOWS, ROOMS AND ANY OTHER ITEMS ARE APPROXIMATE AND NO
 RESPONSIBILITY IS TAKEN FOR ANY ERROR, OMISSION OR MIS-STATEMENT. THIS PLAN IS FOR ILLUSTRATIVE
 PURPOSES ONLY AND SHOULD BE USED AS SUCH, BY ANY PROSPECTIVE PURCHASER. THE SERVICES, SYSTEMS
 AND APPLIANCES SHOWN HAVE NOT BEEN TESTED AND NO GUARANTEE AS TO THEIR OPERABILITY OR EFFICIENCY
 CAN BE GIVEN

© Avasmo Energy