

Rent
Me



Whittlewood Close, Birchwood.

£725 pcm

Two Bedroom Mid Mews | New Bathroom And Kitchen | Gas Central Heating | Lovely Rear Garden |
Allocated Parking Space | Local Amenities | Great Transport Links |



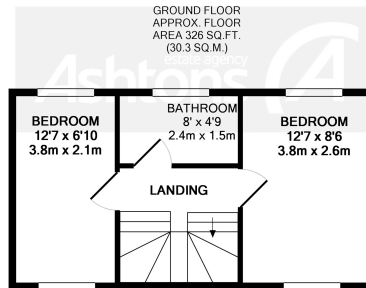
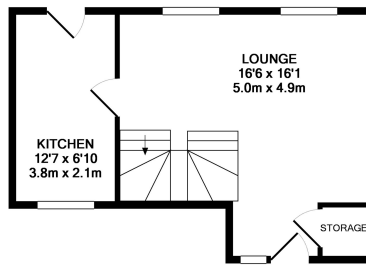

GROUND FLOOR
APPROX. FLOOR
AREA 326 SQ.FT.
(30.3 SQ.M.)

1ST FLOOR
APPROX. FLOOR
AREA 294 SQ.FT.
(27.3 SQ.M.)

TOTAL APPROX. FLOOR AREA 620 SQ.FT. (57.6 SQ.M.)

Whilst every attempt has been made to ensure the accuracy of the floor plan contained here, measurements of doors, windows, rooms and any other items are approximate and no responsibility is taken for any error, omission, or mis-statement. This plan is for illustrative purposes only and should be used as such by any prospective purchaser. The services, systems and appliances shown have not been tested and no guarantee as to their operability or efficiency can be given

Made with Metropix ©2017

Located in the ever popular Birchwood area of Warrington is this attractive mid mews property. The property has recently undergone a complete refurbishment. The house boasts a gorgeous front and back garden and allocated parking to the rear of the property.

In brief the property comprises; living room with storage cupboard, brand new kitchen with access to the rear garden. To the first floor you will find two good sized bedrooms and a newly fitted bathroom, with bath and over head shower. Situated close to local amenities and Risley Moss. The area benefits from excellent transport links including; motorway, train station and bus routes. Available from early October unfortunately no pets. Available from Mid August.



Contact your local office to arrange a viewing:

- Padgate: 01925 479334
- Great Sankey: 01925 454300
- Winwick: 01925 232146
- Stockton Heath: 01925 453400
- St.Helens: 01744 754120
- Wigan: 01942 498862
- Culcheth: 01925 764744
- Ashton-In-Makerfield: 01942 364446
- Newton-Le-Willows: 01925 907770
- Commercial Office: 01925 907709
- Lettings Head Office: 01925 873533
- Financial Services: 01925 221234

Viewing Arrangements
Viewing is strictly by appointment only through Ashtons Estate Agency.

Disclaimer Property Details
These particulars, whilst being believed to be accurate are set out as a general outline only for guidance and do not constitute any part of an offer or contract. Intending purchasers should not rely on them as statements of representation of fact, but must satisfy themselves by inspection or otherwise as to their accuracy. We have not carried out a detailed survey nor tested the services, appliances and specific furnishings. The measurements given are approximate. No person in this firm's employment has the authority to make or give any representation or warranty in respect of the property.

All details, photographs and floorplans are the copyright of Ashtons Estate Agency.

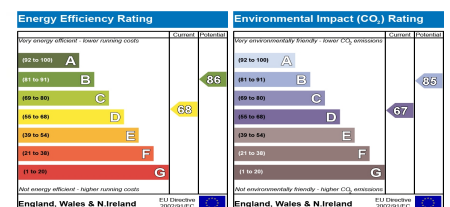

How much you can borrow?
Speak to a mortgage expert in your local office.

Ashtons Financial Services



Ashtons.net rightmove

PrimeLocation.com Zoopla.co.uk