



Day & Co  
ESTATE AGENTS

28 Cavendish Street  
Keighley  
BD21 3RG



30 Hebden Road, Haworth,  
Keighley, West Yorkshire, BD22  
8RE

£99,995

T: 01535 664609

W: [www.dayandcoestateagents.co.uk](http://www.dayandcoestateagents.co.uk)

E: [keighley@dayandcoestateagents.co.uk](mailto:keighley@dayandcoestateagents.co.uk)

- EPC Rating Is D
- Two Double Bedrooms & A Study
- Accommodation Over Three Floors

- Well Presented Mid Terrace
- Modern Fitted Kitchen & Bathroom
- Sought After Village Location Of Haworth/NO CHAIN

## SUMMARY

\*\*A SUPERBLY PRESENTED STONE BUILT MID TERRACE, 2 BEDROOMS & A STUDY - SOUGHT AFTER HISTORIC VILLAGE OF HAWORTH!!\*\* Having accommodation over 3 floors, modern fitted kitchen & bathroom, gas central heating & double glazing - OFFERED FOR SALE WITH NO ONWARD CHAIN!! EPC rating is D.

## FULL DESCRIPTION

Of interest to a variety of buyers is this well presented mid terrace having two bedrooms and a study, situated in the sought after historic village of Haworth with excellent access to local amenities. The three storey accommodation comprises of an open plan living kitchen having a range of modern base and wall mounted units, integrated oven, hob and extractor fan, radiator, double glazed window to the front, access to a useful utility cellar. To the first floor there is a double bedroom, a study (currently used as a third bedroom), and the bathroom which has a modern three piece suite in white comprising of a bath with shower over, WC, wash hand basin. To the second floor a further double bedroom with fitted wardrobes, double glazed window to the front and a radiator. Offered for sale with no onward chain, EPC rating is D.

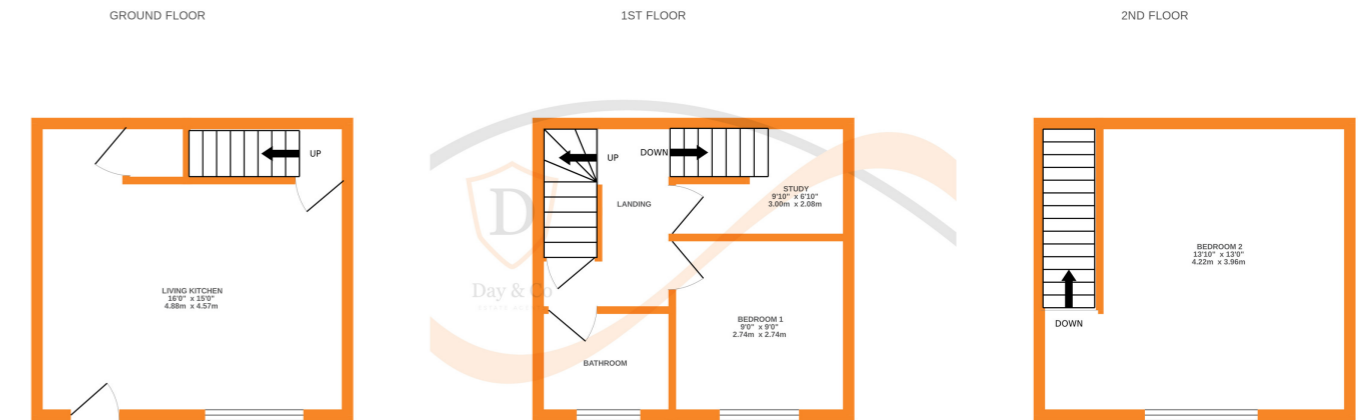

Whilst every attempt has been made to ensure the accuracy of the floorplan contained here, measurements of doors, windows, rooms and any other items are approximate and no responsibility is taken for any error, omission or mis-statement. This plan is for illustrative purposes only and should be used as such by any prospective purchaser. The services, systems and appliances shown have not been tested and no guarantee as to their operability or efficiency can be given.  
Made with Metropix ©2023