



**Three Bedroom Semi-Detached House**  
Crosier Court, Upchurch, Sittingbourne,, Kent, ME9 7AR

**Guide Price £375,000**  
**Freehold**



# Crosier Court, Upchurch, Sittingbourne,, Kent, ME9 7AR

Guide Price £375,000

Freehold

## Description

Guide Price £375,000 - £400,000

If you are looking for a spacious family home in a fantastic village, then this is the one for you! Situated in popular Upchurch in a lovely cul-de-sac, with views over the fields and country walks on your doorstep, this extended family home is a must see! Decorated to high standard throughout, you could simply unpack and put your feet up. You are welcomed into a spacious hallway and the ground floor accommodation offers a separate generous lounge, and an impressive well-appointed shaker style kitchen complete with island, pantry and separate dining area, adjacent a downstairs bathroom and the garage has been converted to create a home office/study while the front part provides a handy storage space with electric doors for extra security, the stunning conservatory with roof lantern flooding the space with natural light completes the expansive ground floor living space. On the first floor you have the family shower room and three good size bedrooms with sliding fitted wardrobes to the main. To the front there's a driveway with ample parking, and electric charging point. To the rear, a low-maintenance garden boasts two patios, perfect for al fresco dining, plus your very own bar for entertaining friends and family!

This home truly has it all – space, charm, and those finishing touches that make a house feel special. Don't miss out – call the Greyfox Sales Team in Rainham today to arrange your viewing before it's gone!

## Key Features

- Extended Three Bedroom Semi Detached Family Home
- Sought After Semi Rural Village of Upchurch
- Well Appointed Shaker Style Kitchen With Island & Spacious Dining Area
- Stunning Conservatory With Roof Lantern
- Driveway For Multiple Vehicles & Electric Charging Point
- Catchment For Popular Holywell Primary School
- Downstairs Family Bathroom & Upstairs Shower Room
- Fantastic Garden Measuring approx. 43 x 18ft

## Local Area

Upchurch is a semi-rural village is situated on the banks of the River Medway and is surrounded by beautiful countryside. The village has a post office, a convenience store, and a number of pubs and restaurants. There is also a day nursery and the highly regarded Holywell Primary school, making Upchurch a popular choice for families with children. There is a vibrant diverse community represented by the website upchurchmatters.co.uk which is well worth a visit, a railway service to London from nearby Rainham and good links to the A2/M2 and onto the M25, Ebbsfleet & Ashford international and the channel tunnel.

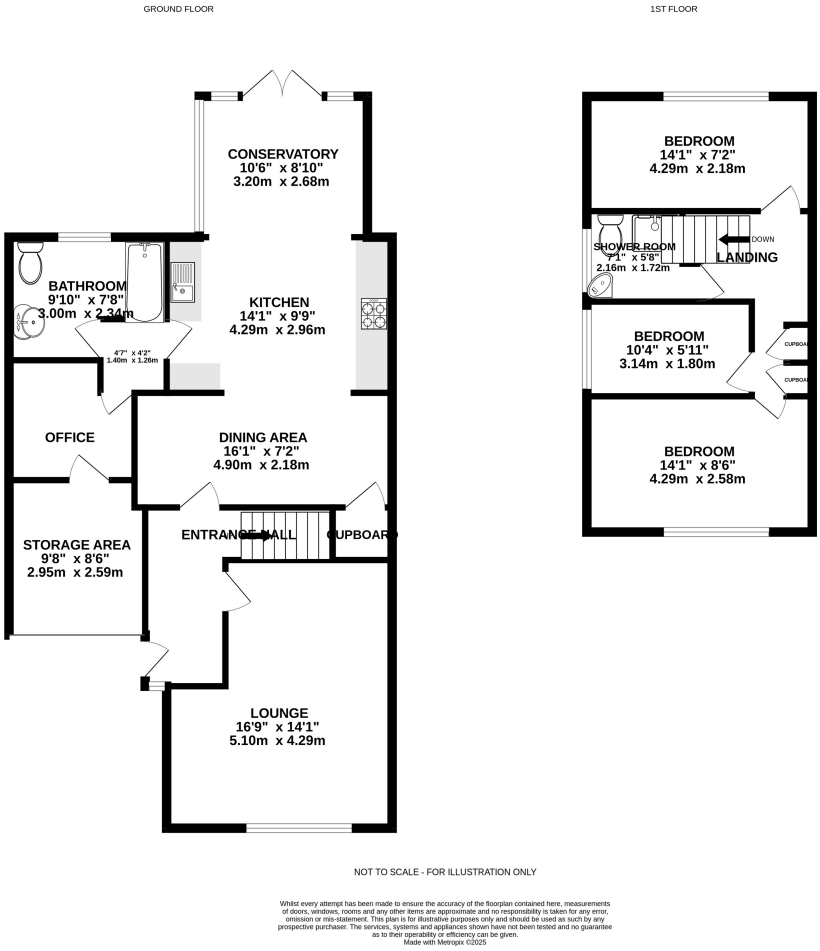



## Property Location

Crosier Court, Upchurch, Sittingbourne,, Kent, ME9 7AR

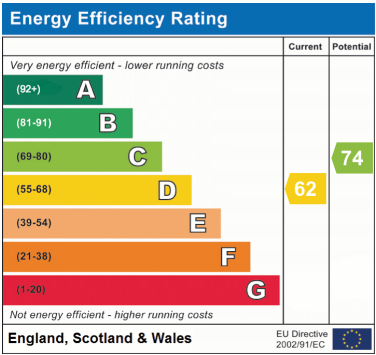

Tenure	Freehold
Lease Term	N/A
Ground Rent	N/A
Service Charge	N/A
Local Authority	2207.33
Council Tax	Band D

**Greyfox Walderslade**  
Unit 2, Thetford House  
Walderslade Village Centre  
Walderslade Road  
Chatham  
Kent  
ME5 9LR  
Tel: 01634 672227 Email:  
walderslade@greyfox.co.uk

**Greyfox Rainham**  
67C High Street  
Rainham  
Kent  
ME8 7HS  
Tel: 01634 377737 Email:  
rainham@greyfox.co.uk

**Agent Notes**  
These particulars are prepared as a general guide to a broad description of the property and should not be relied upon as a statement or representation of fact and do not constitute part of an offer or contract. The seller does not make or give nor do our employees or Greyfox have authority to make or give any representation or warranty to the property. We have not carried out a structural survey and the services, appliances and specific fittings have not been tested. All photographs, measurements, floorplans and distances referred to are given as a guide only and should not be relied upon for the purchase of carpets or any other fixtures or fittings. Lease details, service charges and ground rent (where applicable) and council tax are given as a guide only and should be checked and confirmed by you on inspection and your solicitor prior to exchange of contracts. If there are any points of particular importance to you we will be pleased to check the information for you and to confirm that the property remains available. This is particularly important should you be travelling some distance to view and where statements have been made by us to the effect that the information has not been verified. The copyright of all details, photographs and floorplans remain exclusive to Greyfox. For details of our privacy policy and referral fee arrangements with any of our selected partner companies please visit <https://www.greyfox.co.uk/legal/privacy> and <https://www.greyfox.co.uk/referral-fees>.