



5/2 Westfield Road, Edinburgh, EH11 2QT

Light & Well-Presented, One-Bedroom, South-Facing, Ground-Floor Flat

Up to date price and viewing info at mov8realestate.com/property

espc rightmove  **Zoopla**
find your happy

Property Description

Light and well-presented, one-bedroom, south-facing, ground-floor flat with a garden, forming part of a traditional stone-built tenement. Conveniently located in the popular and vibrant Gorgie, south-west of Edinburgh city centre.

Comprises an entrance hall, living/dining room, kitchen, double bedroom, and a wet-room style shower room.

An ideal starter home or buy-to-let, with appliances and a selection of furnishings available for inclusion in the sale.

Features include continuous contemporary flooring, tall ceilings, period cornice work, double glazing and gas central heating. In addition, there is a secure entry system, an allocated storage cupboard in the communal stairs, a private garden to the front, and a well-maintained and secluded shared garden to the rear.

A welcoming entrance hall affords access throughout the property, including two convenient storage cupboards. Wood-effect flooring continues from the hall into a generous living/dining room, enjoying plenty of natural light from its south-facing aspect, while ample space is available for both lounge and dining furniture. Set off the lounge, a fitted kitchen has wall and base units, a sink, and includes a range of freestanding appliances: gas cooker, fridge/freezer and washing machine.

The bright double bedroom features carpeted flooring, a central light fitting and a built-in wardrobe with mirrored doors. While completing the accommodation, the shower room has a wet-style shower, tiled splash walls and flooring, and a ladder-style radiator.

A 360 Virtual Tour is available online.



5/2 Westfield Road, Edinburgh, EH11 2QT

Approximate Gross Internal Area: (398 sq ft - 37 sq m.)

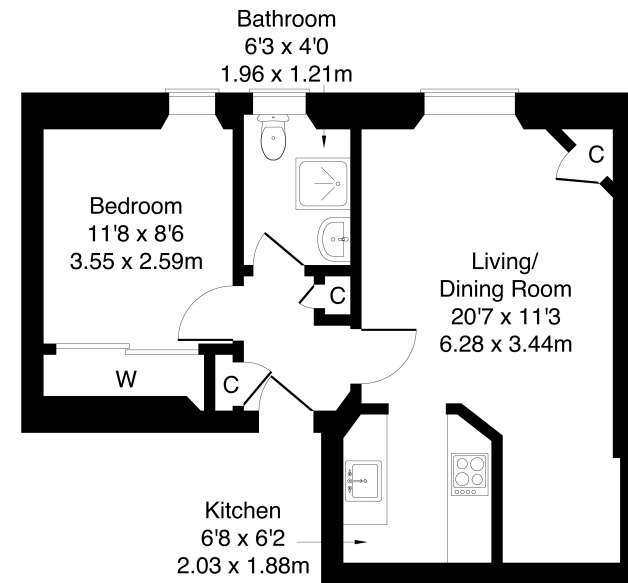
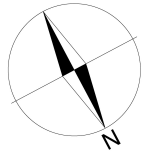

Legal Disclaimer : Floor-plan and measurements are for illustrative guidance only, and not intended to form part of any contract.

Area Description

Located just west of Edinburgh's city centre, Gorgie is a vibrant and historic district known for its traditional stone-built tenements and strong sense of community. The bustling Gorgie Road offers a wide range of local amenities, including Sainsbury's and ALDI, with a 24-hour ASDA superstore nearby at Chesser for added convenience. The area is home to Heart of Midlothian Football Club and offers various leisure options such as

Gorgie Farm, Dalry Swimming Pool, Craiglockhart Sports Centre, and Fountain Park, which features a multi-screen cinema, gym, and a variety of restaurants. Excellent transport links include frequent bus services along Gorgie Road and easy access to Haymarket Station. Gorgie is also well-placed for students, with Napier University, Heriot-Watt University, and Edinburgh College all within close proximity.





Our Services

-  Free pre-sale property valuations
-  Great value fixed estate agency fees
-  Extensive buyer matching database
-  Purchase and sale conveyancing

Contact Us

0345 646 0208

sales@mov8realestate.com

www.mov8.com

Head Office

6 Redheughs Rigg, Edinburgh, EH12 9DQ

Glasgow Office

77 Renfrew Street, Glasgow, G2 3BZ



Estate Agents and Solicitors



These particulars do not form part of any contract and the statements or plans contained herein are not warranted nor are they to scale. All descriptions, dimensions, areas, reference to condition and necessary permissions for use and occupation and other details are given in good faith, and are believed to be correct, but any prospective purchaser should not rely on them as statements or representations of fact, and any prospective purchaser must satisfy themselves by inspection or otherwise as to the correctness of each of them. The Seller shall not be bound to accept the highest or any offer nor to accept a full offer of the Fixed Price where this is applicable. Approximate measurements have been taken by sonic device and measurements are most often taken to the widest point of any room or space. Services and appliances have not been tested for efficiency or safety and no warranty is given as to their compliance with any Regulations. Offers should be made using the Combined Standard Clauses.