

Paper Mill Lane, Bramford, Ipswich

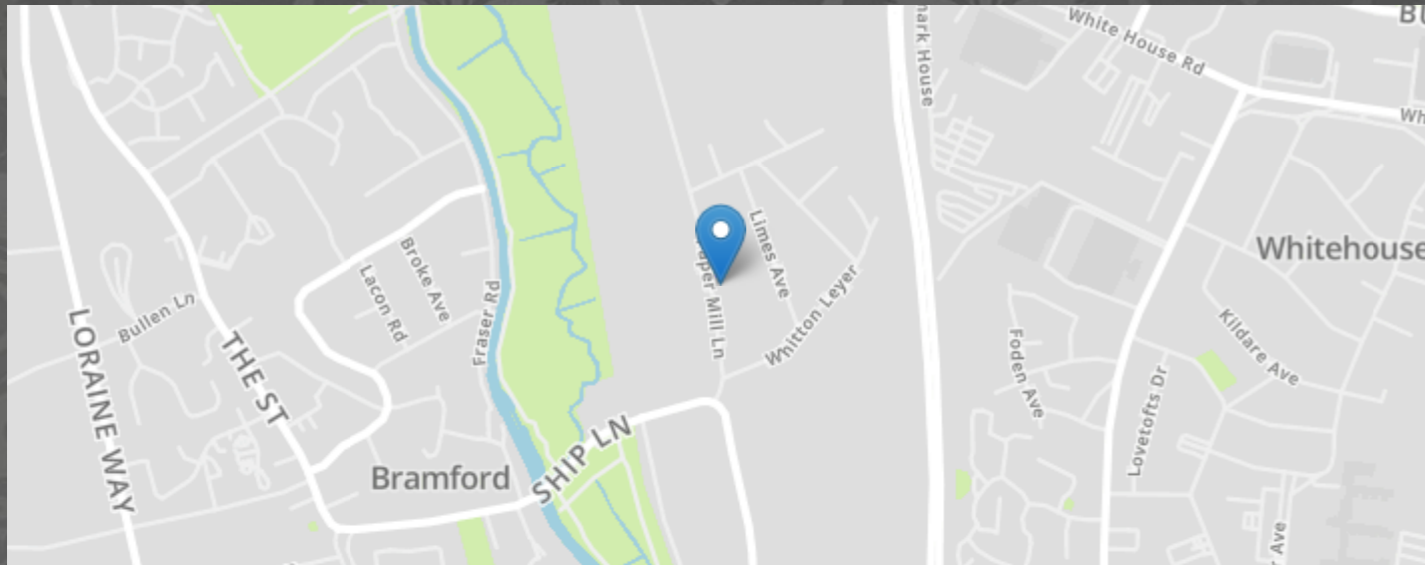

- DETACHED
- GAS CENTRAL HEATING
- FOUR BEDROOMS
- UTILITY & DOWNSTAIRS WC
- DOUBLE GLAZED
- GARDEN
- NEW CARPETS AND FLOORING
- FAMILY BATHROOM

MARKS & MANN

99-101 Penshurst Rd, Ipswich, Suffolk, IP3 8QB.

01473 396 296

contactipswich@marksandmann.co.uk

Website www.marksandmann.co.uk

MARKS & MANN



Paper Mill Lane, Bramford, Ipswich

Marks and Mann are delighted to marketing this well kept and well presented four bedroom detached home for sale. Positioned in an ideal location close to schools and amenities.

Internally the property benefits from, on the ground floor: Porch, entrance hall, living room, kitchen, dining room, cloakroom/utility and conservatory. To the first floor: Landing, bedroom one, bedroom two, bedroom three, bedroom four/office and the family bathroom. Externally the property benefits from off road parking for multiple vehicles and a well presented garden to the rear which features a patio/pathway, green house and lawn.

Call now to register your interest and arrange a private first hand viewing.

£390,000

Paper Mill Lane, Bramford, Ipswich

Porch

Front door, storage cupboard.

Entrance hall

Window to side aspect, radiator.

Living room

3.64m x 5.54m (11' 11" x 18' 2")

Fire place, dual window to front and side aspect, sliding doors to conservatory, wall mounted light x2, radiator.

Kitchen

2.99m x 3.01m (9' 10" x 9' 11")

Electric integrated cooker, gas hob, sink/draining board, window to rear aspect, extractor/hood, wine rack.

Dining room

2.99m x 2.41m (9' 10" x 7' 11")

Window to front aspect, radiator.

Conservatory

2.83m x 3.00m (9' 3" x 9' 10")

French doors to rear aspect.

Cloakroom/Utility

1.91m x 2.40m (6' 3" x 7' 10")

Low level w/c, basin, work top, storage, boiler, window to rear aspect.

Landing

Storage cupboard x2

Bedroom

3.04m x 3.65m (10' 0" x 12' 0")

Built in wardrobe, window to front aspect, radiator.

Bedroom

2.73m x 3.63m (8' 11" x 11' 11")

Window to rear aspect, radiator.

Paper Mill Lane, Bramford, Ipswich

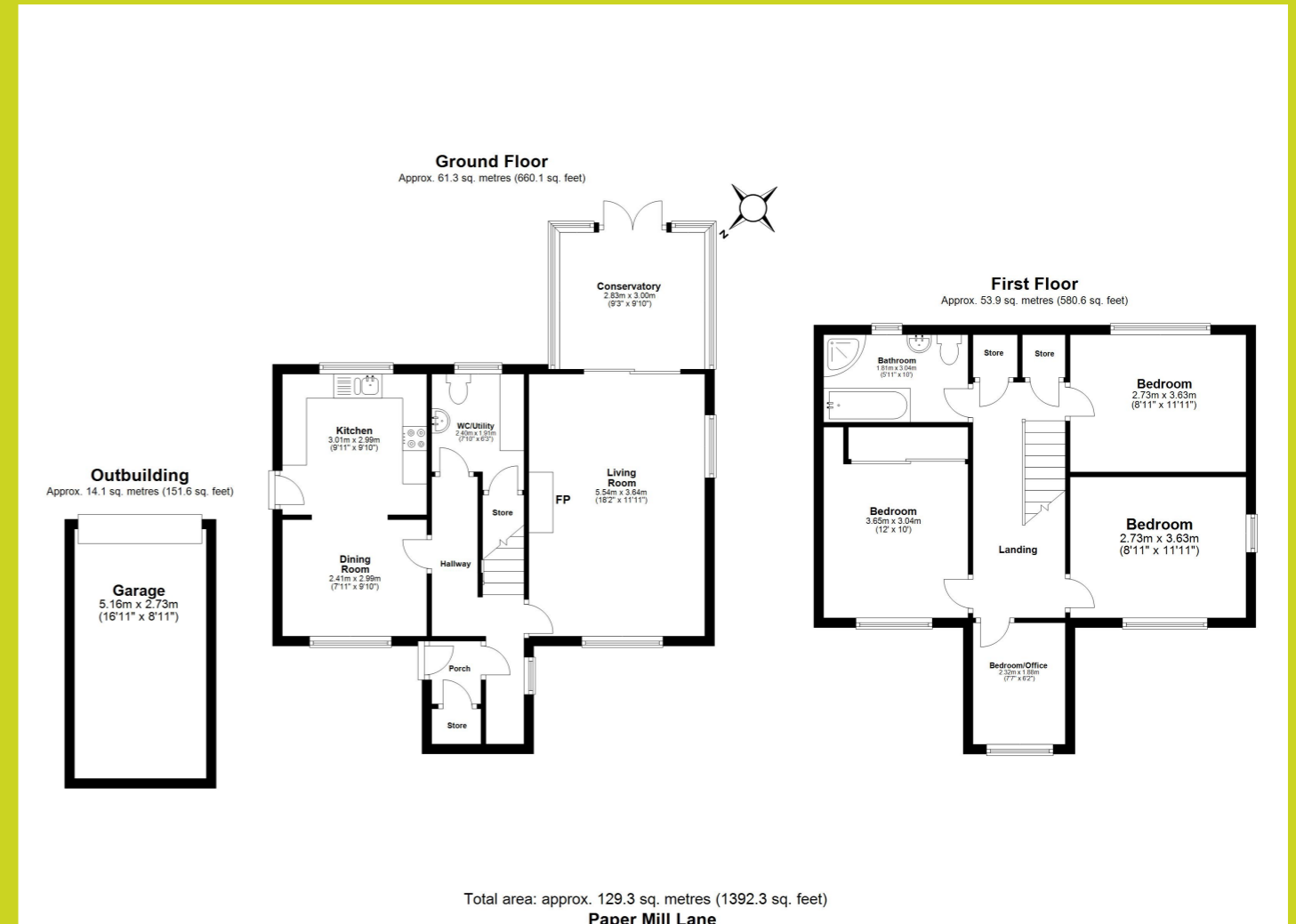

The above floor plans are not to scale and are shown for indication purposes only.

