



Mill Street  
Hereford  
HR1 2NX

Offers In Excess Of £225,000

bettermove

## Mill Street Hereford

Bettermove are proud to present this 2 bedroom terraced house in Hereford (available with no forward chain).

The property benefits from double glazing, gas central heating throughout.

The council tax band is B.

The interior of this beautifully presented property comprises a spacious living room, dining room and fitted kitchen on the ground floor. The first floor consists of 2 bedrooms, an en-suite and the bathroom. The exterior boasts a private rear garden, perfect for enjoying the summer months.

Located in the popular city of Hereford, the property is close to a range of amenities, including shops, supermarkets, restaurants and pubs. Excellent transport connections can be found from the A438, Hereford train station and many local bus routes.

This exciting opportunity should not be missed! All enquiries can be made through Bettermove on 0330 004 0050.



### Cellar

Approx. 12.7 sq. metres (136.3 sq. feet)

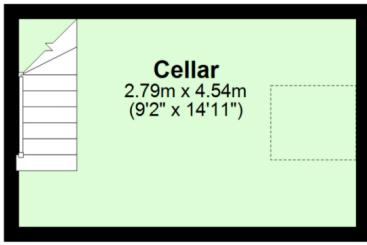

### Ground Floor

Approx. 30.1 sq. metres (323.5 sq. feet)

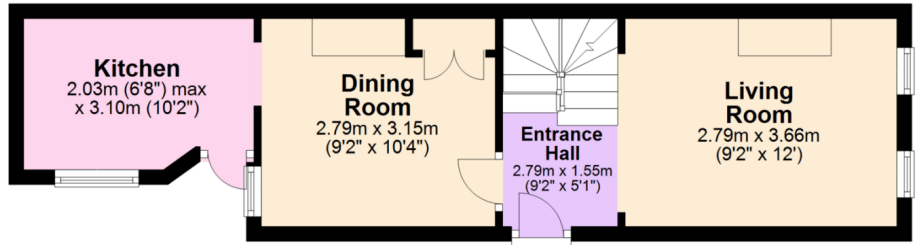

### First Floor

Approx. 36.4 sq. metres (392.2 sq. feet)

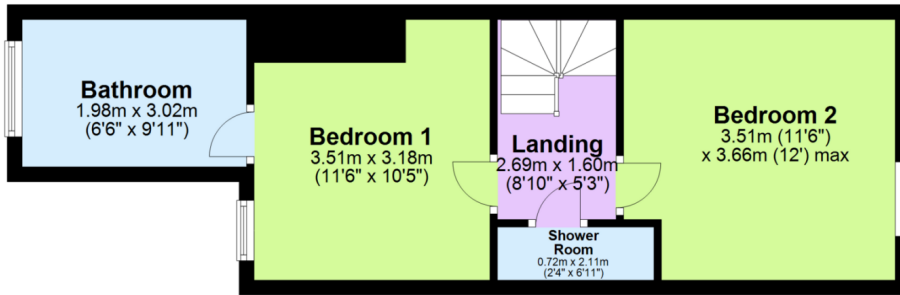

Total area: approx. 79.2 sq. metres (852.1 sq. feet)

FOR IDENTIFICATION PURPOSES ONLY - NOT TO SCALE  
Plan produced using PlanUp.

Energy Efficiency Rating		Current	Potential
Very energy efficient - lower running costs			
(92+)	<b>A</b>		
(81-91)	<b>B</b>		
(69-80)	<b>C</b>		<b>79</b>
(55-68)	<b>D</b>		
(39-54)	<b>E</b>	<b>54</b>	
(21-38)	<b>F</b>		
(1-20)	<b>G</b>		
Not energy efficient - higher running costs			
<b>England, Scotland &amp; Wales</b>		EU Directive 2002/91/EC	



20-22 Bridge End, Leeds, LS1 4DJ  
t: 0330 004 0050 e: hello@bettermove.co.uk  
[www.bettermove.co.uk](http://www.bettermove.co.uk)