



Meadow Close, Bourne, PE10

£675 pcm

EPC Rating: TBC



x2



x1



x1



x0



Tel 01778 369369 sales@beebysproperties.co.uk
<http://www.beebysproperties.co.uk>

Floor plans

Ground Floor

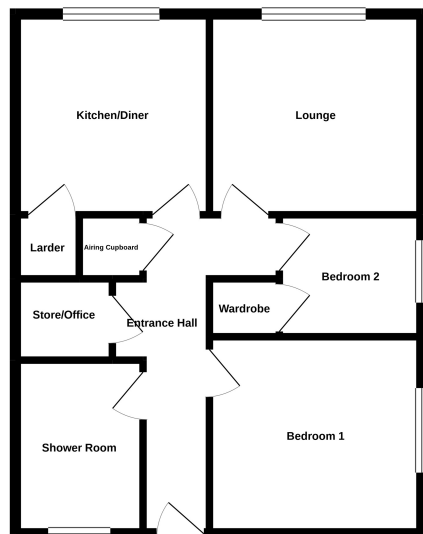

One Floor, Two Bedrooms
Made with MESH 4/2021

Description

****TWO BEDROOM GROUND FLOOR APARTMENT IN THE HEART OF BOURNE TOWN CENTRE!**** Beebys Property Services are excited to offer this ground floor two bedroom apartment within easy walking distance to the local amenities. With one parking space, this apartment briefly comprises of entrance hall, shower room, large storage cupboard which is big enough to be used as an office area, airing cupboard, large fitted kitchen/diner with larder, electric oven and fridge/freezer, lounge, single bedroom with wardrobe and double master bedroom. There is a shared garden with washing lines which can be used and one parking space. Currently there is ramp into the apartment for wheel chair access. The property is furnished including appliances and TV. Please call the office to arrange your viewing.

Energy Proficiency Certificate

Interested in this property

Further information and image gallery available on our website at beebysproperties.co.uk.
Simply contact us for further information or to arrange a viewing:

Tel 01778 369369
sales@beebysproperties.co.uk

The small print

Viewing note

If you wish to view this property then please contact Beebys Properties Ltd directly as viewings are strictly by appointment only.

Important notice

In accordance with the Property Misdescriptions Act (1991) these sales particulars are to be taken as a general description of the property and are not part of any offer or contract. All text, measurements and photos are for guidance only and should not be relied upon as fact. None of the services or appliances have been tested by Beebys Properties Ltd. It is the duty of the purchaser to carry out any inspections, surveys and checks of the property. The copyright of all details, photographs and floor plans are exclusive to Beebys Properties Ltd.