



FOR SALE

Millais Gardens, Edgware, Greater London HA8

Mischa & Co is pleased to present this 3 bedroom extended family home situated on a quiet residential road, ideally located near Krishna Avanti Primary School.

The ground floor features a through lounge along with a fully equipped extended kitchen/diner. The first floor of the property benefits from three generously sized bedrooms and a family bathroom.

Additional benefits include off street parking and a rear garden as well as a brick built garage to the rear of the property with WC and kitchenette – ideal for a office space.

The property is also conveniently located close to Queensbury tube station as well as Edgware Town Centre. This property would make an ideal purchase for first time buyers as well as investors.

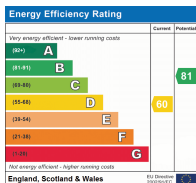

£549,950 Freehold

Floorplan

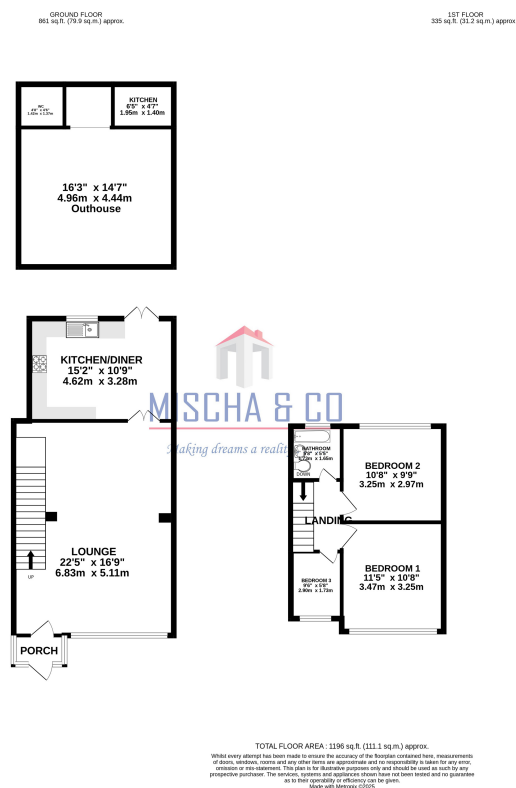

NB: Please note that all fittings, kitchen appliances and heating systems have not been tested by Mishca & Co Sales & Lettings. Whilst we endeavour to make our sales details accurate and reliable. Room sizes should not be relied upon for carpets and furnishings. If there is any point, which is of particular important to you, please contact our office and we will be pleased to verify any information for you. Do so particularly if contemplating travelling some distance to view this property.