



Flat 1, 43 Wickham Avenue, Bexhill-on-Sea,
East Sussex, TN39 3ES

£274,950



- Spacious Victorian garden flat
- Two good size double bedrooms
- South facing lounge with patio doors
- Modern fitted kitchen breakfast room
- Immaculate decoration throughout
- Modern shower room & W.C
- Central heating and double glazed throughout
- Sough After & Convenient Location
- Close to town centre and amenities.
- Easy walking distance to the beach
- Long lease and share of freehold
- Well maintained with low outgoings
- Offered for sale with no onward chain



GROUND FLOOR

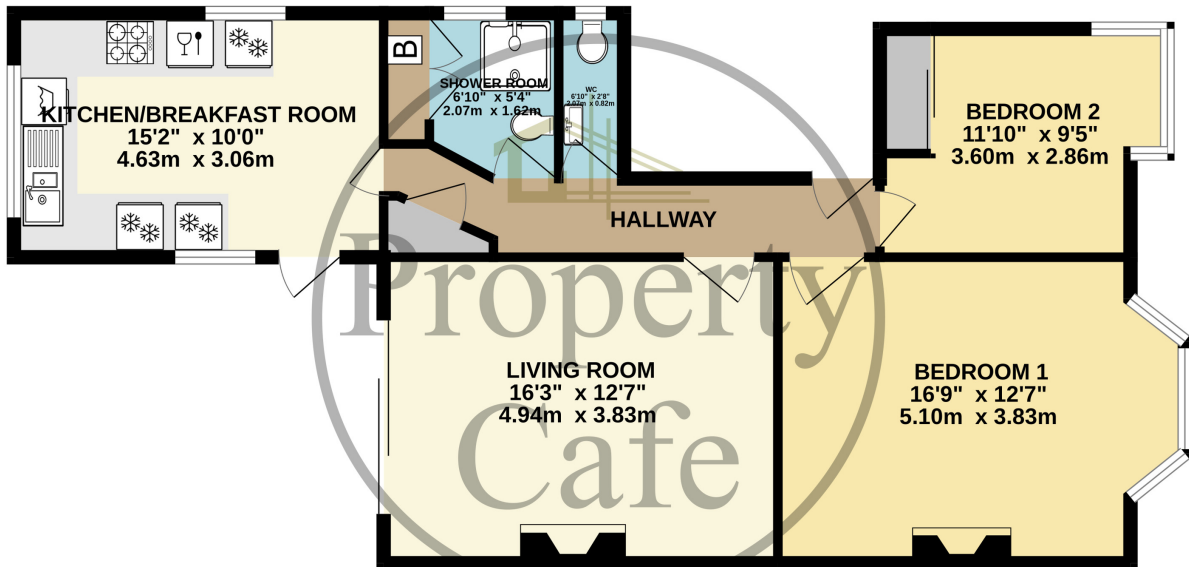

Whilst every attempt has been made to ensure the accuracy of the floorplan contained here, measurements of doors, windows, rooms and any other items are approximate and no responsibility is taken for any error, omission or mis-statement. This plan is for illustrative purposes only and should be used as such by any prospective purchaser. The services, systems and appliances shown have not been tested and no guarantee as to their operability or efficiency can be given.
Made with Metropix ©2024