

REDUCED

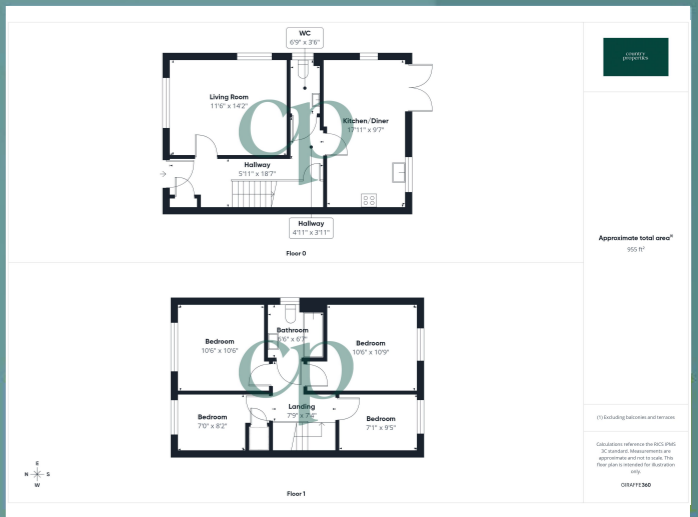

Hampshire Road, Royston. SG8 9FU Leasehold - 65% Shared Ownership £311,750

- Type: Semi-Detached House
- Reception Rooms: 1
- Tenure: Leasehold
- Council Tax: Band D
- Bedrooms: 4
- Service Charge: £659.00
- EPC Rating: B
- Bathrooms: 1
- Ground Rent: £0.00



01763 245121 | royston@country-properties.co.uk