



Day & Co
ESTATE AGENTS

28 Cavendish Street
Keighley
BD21 3RG



12 Queen Street, Haworth,
Keighley, West Yorkshire, BD22
8QB

£198,000

T: 01535 664609

W: www.dayandcoestateagents.co.uk

E: keighley@dayandcoestateagents.co.uk

- CHARACTER COTTAGE
- POPULAR VILLAGE OF HAWORTH
- NO ONWARD CHAIN

- ACCOMMODATION OVER 3 FLOORS
- INTERNALVIEWING ESSENTIAL !
- EPC RATING D

SUMMARY

** STUNNING CHARACTER COTTAGE, ACCOMMODATION OVER THREE FLOORS, FABULOUS MIX OF CHARACTER FEATURES & MODERN BENEFITS, SOUGHT AFTER HISTORIC VILLAGE LOCATION OF HAWORTH NOT FAR FROM MAIN STREET, NO ONWARD CHAIN, EPC RATING D **

FULL DESCRIPTION

Of interest to a variety of buyers is this stunning one bedroom character cottage, situated in the sought after historic village of Haworth with excellent access to village amenities and attractions including the famous cobbled main street and the Bronte Parsonage Museum. The three storey accommodation briefly comprises

Ground Floor - Of an entrance lobby, the lounge has a wood burning stove, radiator, double glazed windows to both front and rear aspect. There is a rear lobby with stone staircase leading to the lower ground floor.

Lower Ground Floor - On this level is the spacious dining kitchen which is a real feature of this property having a range of base and wall mounted units, integrated oven, hob, extractor fan, dishwasher and washer, double glazed window and door to the rear. There is a separate WC also on this level.

To the first floor there is a double bedroom, and the bathroom which has a three piece suite comprising of a bath with shower over, WC, wash hand basin.

Gas Central Heating & Double Glazing.

Outside - Garden area to the front. Offered for sale with no onward chain.

EPC rating D.

LOWER GROUND FLOOR

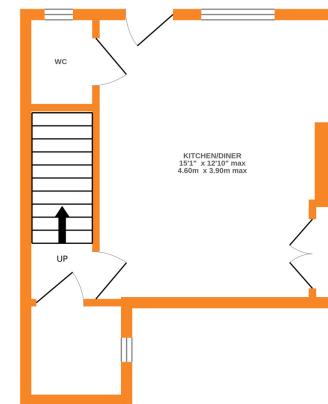

GROUND FLOOR

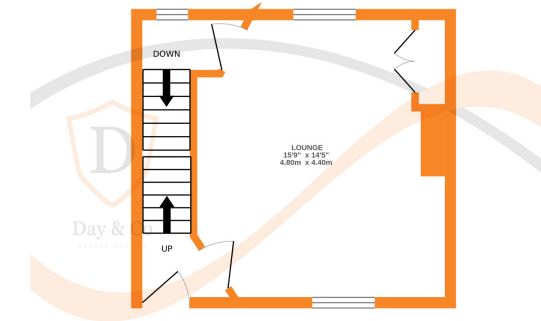

1ST FLOOR

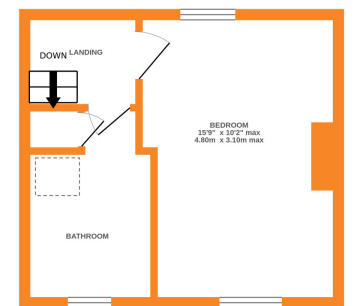

Whilst every attempt has been made to ensure the accuracy of the floorplan contained here, measurements of doors, windows, rooms and any other items are approximate and no responsibility is taken for any error, omission or mis-statement. This plan is for illustrative purposes only and should be used as such by any prospective purchaser. The services, systems and appliances shown have not been tested and no guarantee as to their operability or efficiency can be given.
Made with Metropix ©2024