



3 Hazelbank Walk, Airdrie, North Lanarkshire, ML6 0JZ

Beautifully Presented, Three-Bedroom, Semi-Detached Home with Gardens, Driveway & Garage

Up to date price and viewing info at [mov8realestate.com/property](https://www.mov8realestate.com/property)

espc rightmove  Zoopla
find your happy

Property Description

Beautifully presented, three-bedroom, semi-detached home, with gardens, driveway and garage. Located in a quiet cul-de-sac adjacent to open parkland, near Airdrie and Coatbridge.

Comprises an entrance hall, living/dining room, kitchen, two double bedrooms, a single bedroom and a bathroom.

Tastefully finished with light modern decor, highlights include a fitted kitchen, a stylish bathroom, HIVE gas central heating and double glazing. In addition, there is good storage including a walk-in hall store, a loft, and a generous garage with power and lighting.

Externally, there is a lawn to the front with a driveway continuing to the side; whilst the large rear garden includes a patio and a lawn.

A welcoming entrance features a deep storage cupboard, and affords access to the stairs leading to the upper hall and the dual-aspect living room with wood effect flooring continuing from the hall, a dining area to the rear and French patio doors accessing the southerly-facing garden. Set to the rear, with further garden access, the tastefully finished kitchen is fitted with wall and base units, wood effect worktops, a tiled surround, a sink with drainer; an integrated oven and gas hob; and a freestanding fridge and freezer.

On the upper floor, bedroom one is set to the front with wood effect flooring and a central light fitting; whilst bedrooms two and three are set to opposite aspects, similarly well finished, with bedroom three featuring two built-in storage cupboards. Completing the accommodation, the stylish bathroom is fitted with a modern three-piece suite including an electric shower over the bath, and tiled splash walls and flooring.



3 Hazelbank Walk, Airdrie, ML6 0JZ

Approximate Gross Internal Area: (1076 sq ft - 100 sq m.)

Bathroom
6'4 x 5'10
1.92 x 1.77m

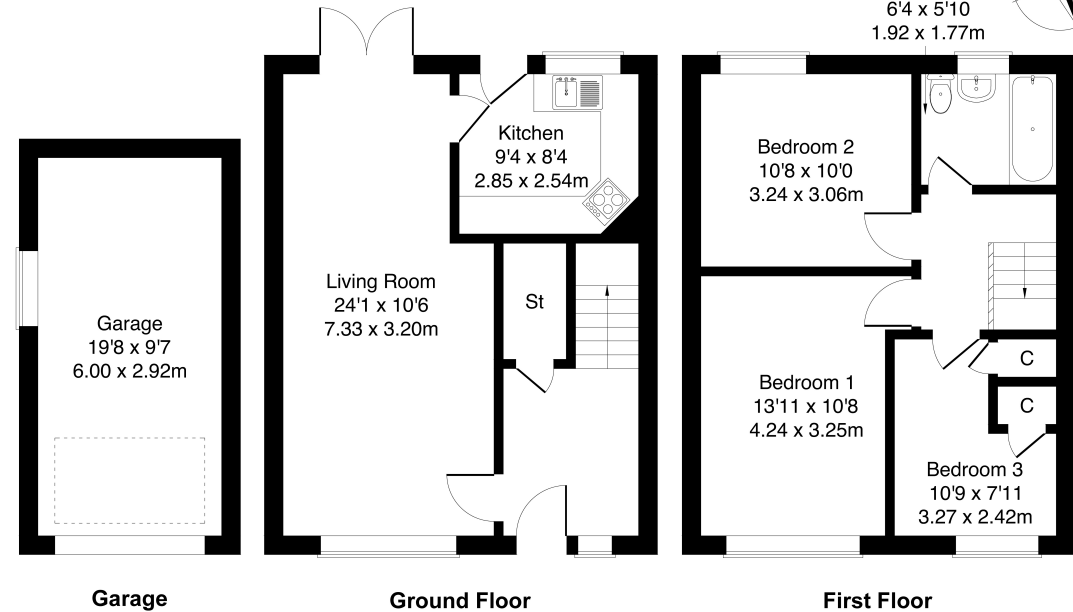

Legal Disclaimer : Floor-plan and measurements are for illustrative guidance only, and not intended to form part of any contract.

Area Description

Located in North Lanarkshire, Airdrie has the majority of everyday shopping needs including Morrisons and Tesco supermarkets, with many high street names in the town centre, as well as a great choice of restaurants, bistros and pubs. Whilst nearby Coatbridge offers a further varied range of shopping, as well as large retail parks, restaurants, bars and nightlife in the greater area; together, with a cinema, leisure and sports centres, parks, and golf courses; plus the Time Capsule Leisure Centre and Summerlee Scottish Museum of Industrial Heritage. Airdrie has a good range

of schools from nursery up to high school level and a range of health services, including dentists, medical centres and opticians. For those commuting by public transport, there are regular bus and train services from Coatdyke, Airdrie and Coatbridge railway stations to the surrounding towns and cities including Glasgow and Edinburgh. The M8 and M74 motorways provide excellent access to the central belt, and with Glasgow lying ten minutes, and Edinburgh approximately thirty minutes away.





Our Services

- Free pre-sale property valuations
- Great value fixed estate agency fees
- Extensive buyer matching database
- Purchase and sale conveyancing

Contact Us

0345 646 0208

sales@mov8realestate.com

www.mov8.com

Head Office

6 Redheughs Rigg, Edinburgh, EH12 9DQ

Glasgow Office

77 Renfrew Street, Glasgow, G2 3BZ



Estate Agents and Solicitors

