



## Atlantis Court, Brunswick Park Road, London, N11

£1,525  
pcm



## Atlantis Court, Brunswick Park Road, London, N11

A luxury one bedroom apartment positioned on the ground floor of this recently built development offering circa 530 sq ft (49 sq M) of internal space and a allocated parking space.

This superb flat benefits from a stylish open plan kitchen/reception room area, a fully carpeted bedroom and a contemporary bathroom. Further key features include an allocated parking space and ample storage.

### Features

- Circa 530 sq ft
- Recently Built Development
- Ground Floor Flat
- Allocated Parking Space
- Open Plan Kitchen/Reception
- Modern Apartment
- Spacious Bedroom With Ample Storage Space
- One Bedroom
- Contemporary Bathroom



Atlantis Court,  
Brunswick Park  
Road, London, N11

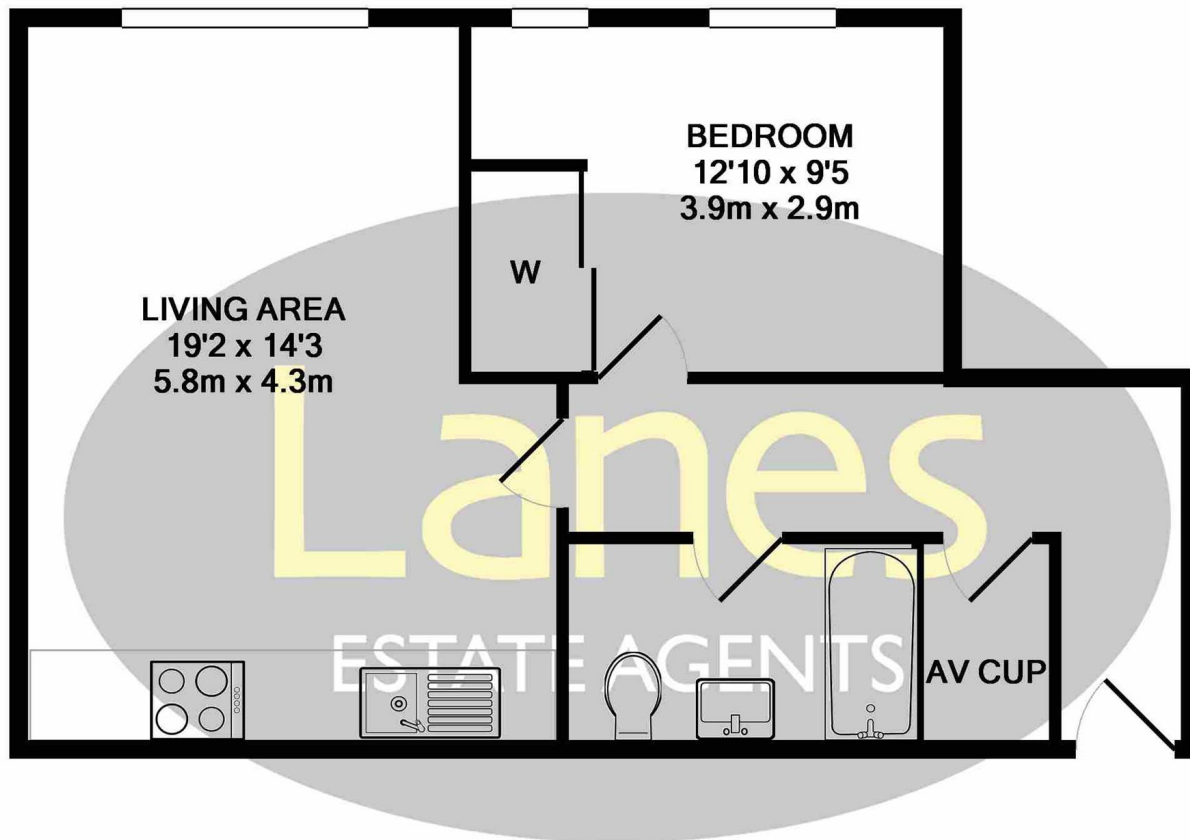

2 ATLANTIS COURT  
TOTAL APPROX. FLOOR AREA 531 SQ.FT. (49.3 SQ.M.)

Whilst every attempt has been made to ensure the accuracy of the floor plan contained here, measurements of doors, windows, rooms and any other items are approximate and no responsibility is taken for any error, omission, or mis-statement. This plan is for illustrative purposes only and should be used as such by any prospective purchaser. The services, systems and appliances shown have not been tested and no guarantee as to their operability or efficiency can be given  
Made with Metropix ©2018