

FOR
SALE



4 Woodward Avenue, Hereford HR2 7FH

£220,000 - Freehold

22, Broad Street, Hereford, HR4 9AP 01432 355455 hereford@flintandcook.co.uk

PROPERTY SUMMARY

Situated in this convenient City location, a 3 bedroom semi-detached house offering ideal first time buyer/small family accommodation. The property has the added benefit of driveway parking, enclosed rear garden, gas central heating, double glazing and we recommend an internal inspection.

POINTS OF INTEREST

- *Semi detached house*
- *3 Bedrooms*
- *Ideal first time buyer/investor accommodation*
- *Gas central heating & double glazing*
- *No onward chain*
- *Must be viewed!*



ROOM DESCRIPTIONS

Canopy Porch

With entrance door leading into the

Entrance Hall

With mat-well, radiator, carpeted stairs leading to the first floor, smoke alarm, gas central heating thermostat and doors to the

Downstairs WC

Vinyl flooring, low flush WC, wash hand-basin with tiled splashback, radiator, extractor.

Kitchen/Diner

Kitchen fitted with matching wall and base units, ample worksurfaces, 1½ bowl stainless steel sink and drainer unit, under-counter space for washing machine and space for free-standing fridge/freezer, electric oven, 4-ring gas hob and extractor over, double glazed window to the rear aspect, radiator and door leading into the

Living Room

Fitted carpet, radiator, double glazed window to the front aspect, double glazed French doors opening onto the rear garden and useful understairs storage cupboard.

First floor landing

Fitted carpet, radiator, loft hatch, window to the side aspect and doors to

Bedroom 1

Fitted carpet, dual aspect double glazed windows, radiator and useful built-in storage cupboard.

Bedroom 2

Fitted carpet, radiator and double glazed window to the rear aspect.

Bedroom 3

Fitted carpet, radiator and double glazed window to the front aspect.

Bathroom

Suite comprising panelled bath with mains fitment shower over, low flush WC, pedestal wash hand-basin with tiled splashback, opaque double glazed window to the rear, vinyl flooring, radiator and extractor.

Outside

To the rear of the property there is a paved patio area which extends round to the side access and gate. Useful outside tap. The remainder of the garden is laid to lawn with an area of decking, enclosed by wooden fencing. Wooden storage shed. To the front of the property there is a brick paved driveway providing off-road parking for 2 vehicles with a paved pathway leading to the front entrance door. The remainder of the garden is laid to lawn with mature hedging.

Services

Mains water, electricity, drainage and gas are connected. Telephone (subject to transfer regulations). Gas-fired central heating.

Outgoings

Council tax band B - payable 2024/25 £1794.59

Water and drainage - rates are payable/metered supply.

Money laundering regulations

Prospective purchasers will be asked to produce identification, address verification and proof of funds at the time of making an offer.

Viewing

Strictly by appointment through the Agent, Flint & Cook, Hereford (01432) 355455.

Directions

Proceed south out of Hereford over Greyfriars Bridge, taking the 2nd exit onto Belmont Road. Continue along Belmont Road, heading under the bridge and taking the left hand turn immediately after, continuing along Belmont Road towards The Oval. Then take the 1st left turn heading around The Oval and take the 3rd left turn onto Woodward Avenue and the property is located on the right hand side, as indicated by the Agent's FOR SALE board. What3words - riders.cross.this

Ground Floor

Approx. 34.9 sq. metres (375.8 sq. feet)

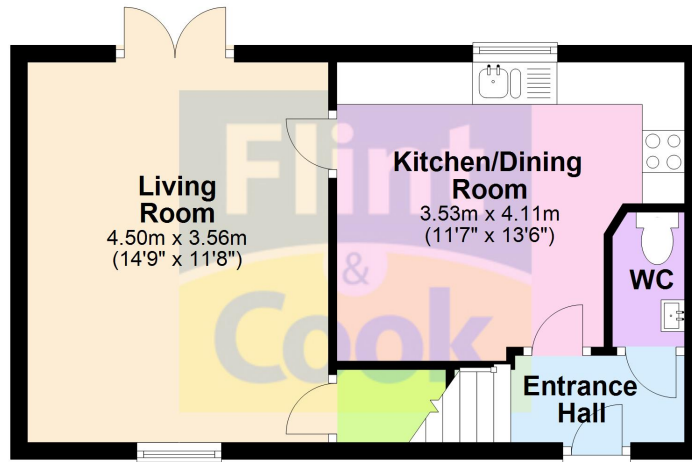

First Floor

Approx. 34.0 sq. metres (366.5 sq. feet)

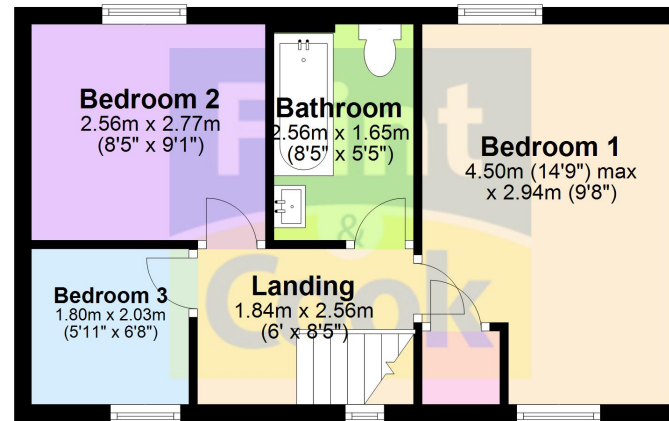

Total area: approx. 69.0 sq. metres (742.3 sq. feet)

This plan is for illustrative purposes only
Plan produced using PlanUp.

These particulars are prepared for the guidance only of prospective purchasers. They are intended to give a fair and overall description of the property and do not constitute the whole or any part of an offer or contract. Any information contained herein (whether in text, plans or photographs) is given in good faith but should not be relied upon as being a statement or representation of fact. Any plans provided by the agents and/or with the sales particulars are intended for guidance purposes only; we cannot guarantee the accuracy and scale of any plans, and they do not form any part of the sales contract. Nothing in these particulars shall be deemed to be a statement that the property is in good condition or otherwise nor that any services or facilities are in good working order. Any movable contents, fixtures and fittings, (whether wired or not) referred to in these property particulars (including any shown in the photographs) are, unless the particulars say otherwise, excluded from the sale. In the event that the buyer proposes to purchase any movable contents or include them in any offer for the property, the buyer cannot in any respect imply any such inclusion from the property particulars. Any areas, measurements or distances referred to herein are approximate only and may be subject to amendment. It should not be assumed that the property has all necessary planning, building regulation or other consents and these matters must be verified by an intending purchaser. The information in these particulars is given without responsibility on the part of the agents or their clients and neither the agents nor their employees have any authority to make or give any representations or warranties whatever in relation to this property.

Flint & Cook Privacy Statement: We take your privacy very seriously. Your data will not be shared with any other parties without your express permission. Our Data protection Policy can be read in full on the Flint & Cook website, www.flintandcook.co.uk

Energy Efficiency Rating		
	Current	Potential
Very energy efficient - lower running costs		
(92+)	A	96
(81-91)	B	83
(69-80)	C	
(55-68)	D	
(39-54)	E	
(21-38)	F	
(1-20)	G	
Not energy efficient - higher running costs		
England, Scotland & Wales		