



## Wymondley Road

Hitchin | Hertfordshire | SG4 9QQ

[www.stonegate-estates.co.uk](http://www.stonegate-estates.co.uk)





# WYMONDLEY ROAD

---

## Property Description

Unravel the mysteries of this spacious detached property nestled in the historic town of Hitchin. Set on a generous corner plot with the potential to extend (STPC), this home boasts five bedrooms, including an en-suite to the master bedroom for regal relaxation.

The property features three reception rooms, a study for scholarly pursuits, and a utility room for practical needs. The refitted kitchen is a chef's delight, perfect for preparing delicious family meals.

Outside, a driveway for three cars and a garage offer ample parking space.

Discover the beauty of this property's well-maintained 2100 sq/ft, offering the perfect sanctuary for your family.

Enrich your lives in this charming home in the heart of Hitchin.

Hitchin, a market town steeped in centuries of history, is a tranquil valley town surrounded by the Chiltern Hills.

Education is key here, with William Ransom School within reach and secondary education available at Hitchin Girls' School and Hitchin Boys' School.

Explore the town center along with the train station, both within walking distance, providing easy access to London, Cambridge, and beyond. Hitchin Railway Station serves as a gateway to various destinations, including St Pancras International and Gatwick Airport.

Book a viewing today and take the first step towards your dream home.

## £995,000 Freehold





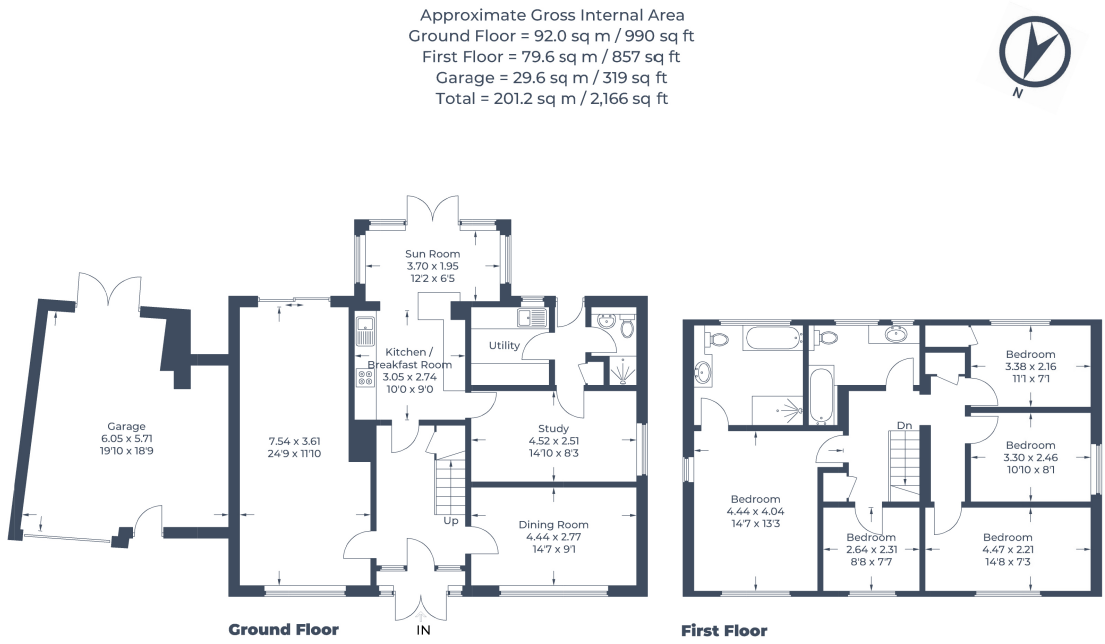

Illustration for identification purposes only.  
measurements are approximate, not to scale.  
© C3 Property Marketing Produced for Stonegates





- 5 Bedroom Detached
- Corner Plot
- Potential to Extend (STPP)
- Great Location
- 3 Reception Rooms
- Ample Off Road Parking & Garage
- William Ransom Catchment
- Study

EPC Rating: C

Stonegate Estate Agents

01462 438979

[sales@stonegate-estates.co.uk](mailto:sales@stonegate-estates.co.uk) | [www.stonegate-estates.co.uk](http://www.stonegate-estates.co.uk)

