

Furlong

Warminster, BA12 9BU

COOPER
AND
TANNER



£210,000 Freehold

3 1 1 EPC D

Description

An end of terrace three bedroom cottage which offers good size accommodation throughout. It is a quirky cottage and is located close to the town centre. In addition the property is offered for sale with NO ONWARD CHAIN. The accommodation comprises an entrance hallway which can be used as a dining room or an office, sitting room, kitchen with a range of wall and base unit, space for appliances, a rear porch which gives access to the rear courtyard garden. Moving upstairs there are three bedrooms and a family bathroom. Outside there is a small courtyard garden.

Furlong, Warminster, BA12

Approximate Area = 850 sq ft / 78.9 sq m

For identification only - Not to scale

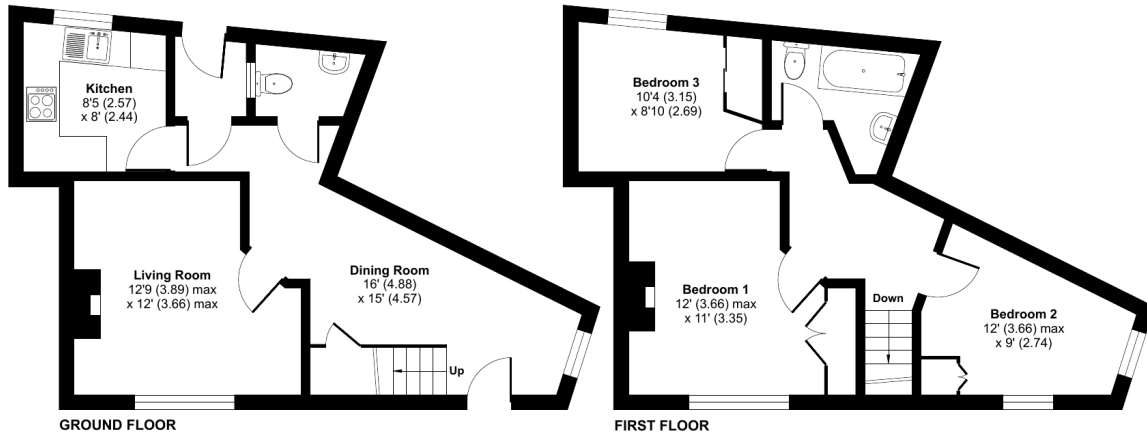

Floor plan produced in accordance with RICS Property Measurement Standards incorporating International Property Measurement Standards (IPMS2 Residential). © nrichcom 2023. Produced for Cooper and Tanner. REF: 1040905



Features

- End Terrace House
- Dining hall/study
- Kitchen
- Sitting Room
- Three Bedrooms
- Family Bathroom
- Courtyard Garden
- Close to town centre
- No onward chain

Local Information

- Council Tax Band B
- Tenure Freehold
- EPC Rating D

WARMINSTER OFFICE

Telephone 01985 215579

48-50, Market Place, Warminster, Wiltshire BA12 9AN

warminster@cooperandtanner.co.uk

**COOPER
AND
TANNER**

Important Notice: These particulars are set out as a general outline only for the guidance of intended purchasers and do not constitute, nor constitute part of, an offer or contract. All descriptions, dimensions, reference to condition and necessary permissions for use and occupation, warranties and other details are given without responsibility and any intending purchasers should not rely on the same as statements or representations of fact but must satisfy themselves by inspection or otherwise as to the correctness of each of them.

