

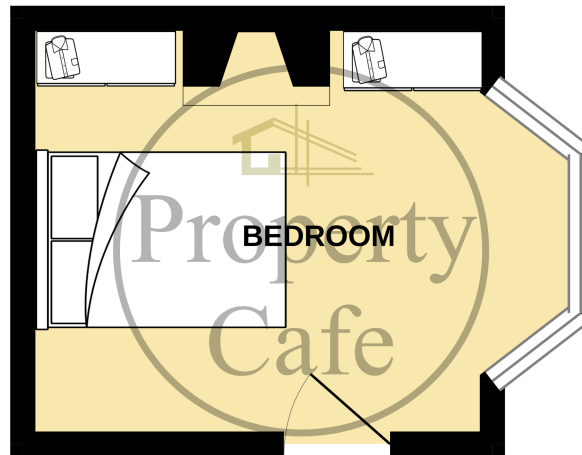

28 Devonshire Road, Hastings, East Sussex, TN34 1NF
£525 pcm

GROUND FLOOR



Whilst every attempt has been made to ensure the accuracy of the floorplan contained here, measurements of doors, windows, rooms and any other items are approximate and no responsibility is taken for any error, omission or mis-statement. This plan is for illustrative purposes only and should be used as such by any prospective purchaser. The services, systems and appliances shown have not been tested and no guarantee as to their operability or efficiency can be given.
Made with Metropix iC5023

Property Cafe are delighted to offer to the lettings market this spacious room to rent situated in the heart of Hastings town centre with its array of local amenities, bars, restaurants and vibrant nightlife. Internally this property offers modern communal living to include a fully equipped modern kitchen, modern bathroom with separate W.C, and a spacious double bedroom with ornamental fireplace. Additional benefits include hardwood flooring, gas central heating, double glazing, neutral decor, full furnishings throughout to include, double bed, wardrobe, work station and a cleaner is also employed to clean the common ways. The property is available to let beginning of June, 2024 and internal viewings are highly recommended. A minimum annual income of £15,750 is required to be eligible for this property. To arrange our internal viewing or for further information, please contact our Hastings office on 01424 224488 Option 2.

1 x week holding fee = £121.15

5 x week security deposit = £605.76

Minimum affordability =£15,750



Bedrooms: 1
Council Tax: Band A
Parking Types: No Parking Available.
Heating Sources: Gas Central.
Electricity Supply: Mains Supply.

- Free wifi
- Single room to let.
- Communal courtyard with decking.
- Town centre location
- All bills included

Water Supply: Mains Supply.
Sewerage: Mains Supply.
Broadband Connection Types: FTTC.
Accessibility Types: Not suitable for wheelchair users.

- Communal cleaner.
- Close to mainline railway and amenities.
- Double glazing.
- Gas central heating.
- Available now