

Sturges Court Flat 7, 70, Sturges Road Wokingham RG40 2HB



A modern purpose built first floor flat with lift access, gas fired underfloor central heating and double glazing providing an impressive EPC-B reading, allocated parking space and pleasant communal gardens, located in one of the best town centre roads and only a few hundred yards from Waitrose. The accommodation which amounts to 603 sq ft and features a 27ft bright and airy open plan lounge/dining/kitchen area with Juliet balcony, two good sized bedrooms and a four piece bathroom. The property retains the balance of a 999 year lease with an annual service charge of £1355.52 plus £709.88 reserve fund payment for any necessary future works and a £1 pa. ground rent payment. No onward chain. For more detailed material property information please click on the various brochure links.

£300,000 Leasehold





Energy Efficiency Rating		Current	Potential
Very energy efficient - lower running costs			
(92+)	A		
(81-91)	B	81	81
(69-80)	C		
(55-68)	D		
(39-54)	E		
(21-38)	F		
(1-20)	G		
Not energy efficient - higher running costs			
England, Scotland & Wales		EU Directive 2002/91/EC 	

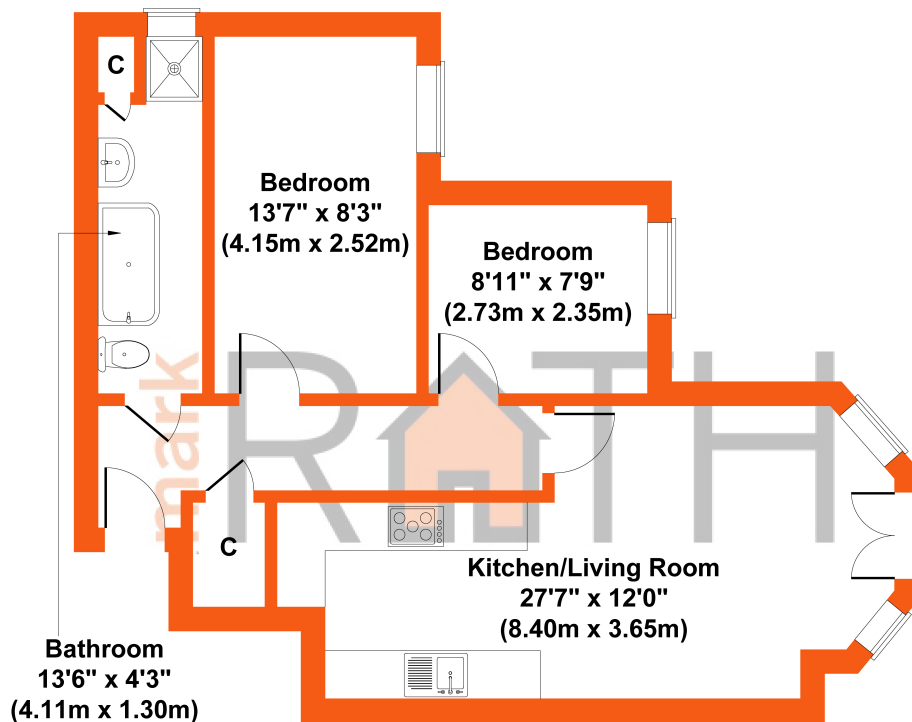

Approx. Gross Internal Floor Area 603 sq. ft. (56.0 sq. m.)

SKETCH PLAN FOR ILLUSTRATIVE PURPOSES ONLY

All measurements walls, doors, windows, fittings and appliances, their sizes and locations, are approximate only. They cannot be regarded as being a representation by the seller, nor their agent.

Produced by The Plan Portal 2026

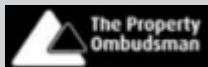

These particulars have been prepared in good faith to give a fair overall view of the property; they do not constitute an offer and will not form part of any contract. We make no representation about the conditions of the property nor that any services or appliances are in good working order; this should be checked by your surveyor. Furthermore, you should not assume that any items or features referred to in these particulars or shown in the photographs are included in the sale price. Your solicitor should check this as part of the normal conveyancing process.