



HILTON KING & LOCKE

SPECIALISTS IN PROPERTY



Flat 3, 19A Upton Park, Slough, Berkshire. SL1 2DA.

£275,000 Leasehold

A delightful light and airy apartment located in this sought after setting, walking distance to the renowned Herschel Park. This property has undergone complete refurbishment in 2018 and is also only a short walk into the Town Centre where you can find a host of amenities, plus Slough Station and Crossrail. There is also no upper chain involved.

Internally there is a central entrance hall which gives you access to a 13'6 x 10'10 living/dining room which offers a lovely twin front aspect, a modern fitted kitchen which has an integrated Neff gas hob and oven, two double bedrooms that both offer a rear aspect and measure 10'4 x 9'6 & 10'4 x 8'7, with one having a modern ensuite shower room. Completing the accommodation is a contemporary styled family bathroom.

Outside to the front of the property there is a car park for residents with one allocated space. There is 96 years left on the lease.



THE AREA

The property is within walking distance to Slough town centre, with Slough railway and Elizabeth line station just 0.7 miles away, and Slough High Street's shops, services and amenities just 0.4 miles away. There are also local primary, secondary and grammar schools within a short walk, as well as Herschel Park.



Important Notice

Particulars: These particulars are not an offer or contract, nor part of one. You should not rely on statements by Hilton King & Locke Ltd in the particulars or by word of mouth or in writing as being factually accurate about the property, its condition or its value. Hilton King & Locke Ltd does not have any authority to make any representations about the property, and accordingly any information given is entirely without responsibility on the part of the agents, seller(s) or lessor(s).

Photographs etc: The photographs show only certain parts of the property as they appeared at the time they were taken. Areas, measurements and distances given are approximate only.



The Broadway
Farnham Common Buckinghamshire SL2 3QH

Tel: 01753 643555
fc@hklhome.co.uk

Flat 3, 19A Upton Park

Approximate Gross Internal Area

49.3 sq m / 531 sq ft

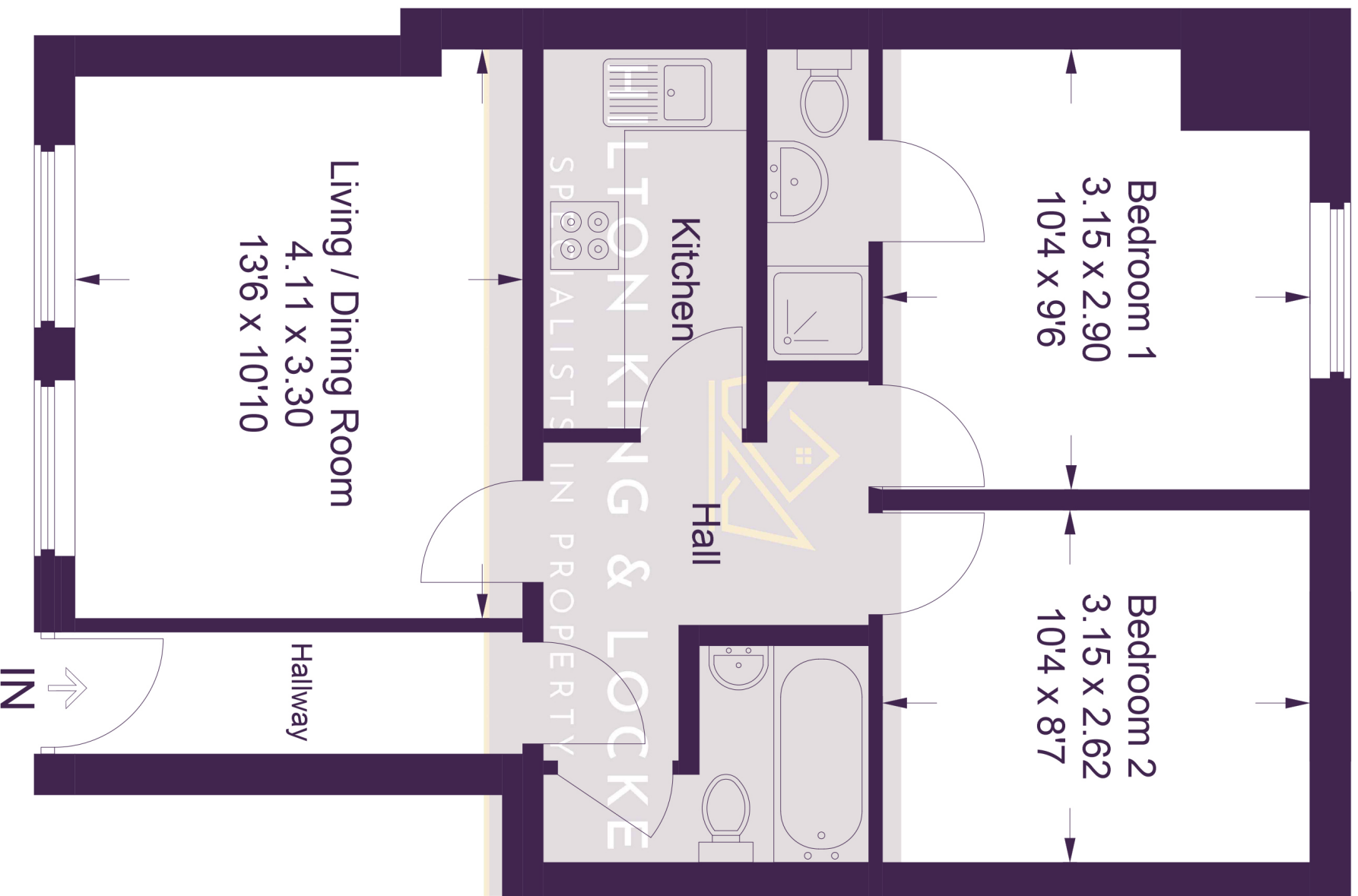

This plan is for layout guidance only. Not drawn to scale unless stated. Windows and door openings are approximate. Whilst every care is taken in the preparation of this plan, please check all dimensions, shapes and compass bearings before making any decisions reliant upon them.