



Hamil Road,
Burslem

 **OneAgency**

01782 970222

hello@oneagencygroup.co.uk



 OneAgency



 OneAgency

£550 pcm

A two bedroom flat in the popular location of Burslem. The property benefits from a ground floor kitchen, lounge, two bedrooms, first floor bathroom and walk in wardrobe area. The property is located close to amenities, commuter links and schools. An ideal property for a single occupier or couple. Viewing is highly advised!



 OneAgency



Ground Floor

Hall

Entered through the rear door, plumbing for a washing machine, window and vinyl flooring.

Kitchen

3.53m x 2.75m (11' 7" x 9' 0") A range of wall and base units with worktops, stainless steel sink basin, cooker, space for a fridge/freezer, dining table and chairs, boiler to the wall, radiator and vinyl flooring.

First Floor

Lounge

3.58m x 3.56m (11' 9" x 11' 8") Two double glazed windows, radiator and carpet flooring.



Bedroom One

2.65m x 2.64m (8' 8" x 8' 8") A double glazed window, radiator and carpet flooring.

Bedroom Two

2.68m x 1.94m (8' 10" x 6' 4") A double glazed window, radiator and carpet flooring.

Bathroom

2.56m x 1.94m (8' 5" x 6' 4") A white suite with bath, pedestal hand wash basin, windows, storage cupboard, radiator and vinyl flooring.

Walk in Wardrobe

Rail hanger for clothing and carpet flooring.

External

A paved yard to the rear with gated access.

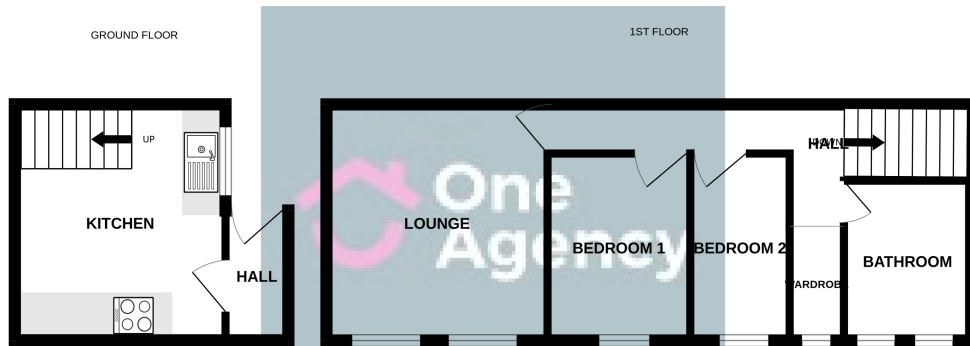

Whilst every attempt has been made to ensure the accuracy of the floorplan contained here, measurements of doors, windows, rooms and any other items are approximate and no responsibility is taken for any error, omission or mis-statement. This plan is for illustrative purposes only and should be used as such by any prospective purchaser. The services, systems and appliances shown have not been tested and no guarantee as to their operability or efficiency can be given.
Made with Metropix ©2023

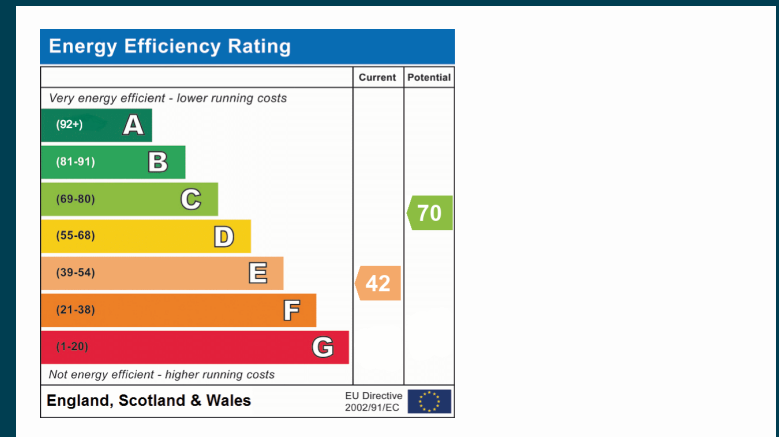

OneAgency, 9 & 10 Ridge House Drive, Festival Park, Stoke-on-Trent, ST1 5SJ

01782 970222

hello@oneagencygroup.co.uk

Every attempt has been made to ensure accuracy, however, all measurements are approximate and for illustrative purposes only. **Not to scale.**

In accordance with The Consumer Protection from Unfair Trading Regulations 2008 the following particulars have been prepared in good faith and they are not intended to constitute part of an offer or contract. We have not carried out a structural survey and the services, appliances and specific fittings have not been tested. All photographs, measurements, floor plans and distances referred to are given as a guide only and should not be relied upon for the purchase of carpets or any other fixtures and fittings. Lease details, service charges and ground rent (where applicable) are given as a guide only and should be checked and confirmed by your Solicitor prior to exchange of contracts.