

PAUL ALEXANDER
MORTGAGE CONSULTANTS

For all insurance and mortgage needs,
please call Paul Alexander Mortgage Consultants
on 020 8997 3915

LONDON'S LOCAL AGENT
enquiries@orchardsoflondon.com
020 3962 6000 | orchardsoflondon.com
Westworld West Gate London W5 1DT

LIME GROVE

£1,712 pcm

- Exceptional period apartment
- Bright reception room with wooden floors
- Two double bedrooms
- Smart family bathroom
- Desirable newly refurbished kitchen
- Presented in immaculate condition
- Excellent transport links with Shepherds Bush Market, Goldhawk Road (Circle and Hammersmith & City Line) and Shepherd's Bush station (Central Line and Overground)

within walking distance

LONDON'S LOCAL AGENT
enquiries@orchardsoflondon.com
020 3962 6000 | orchardsoflondon.com
Westworld West Gate London W5 1DT

Orchards of London are delighted to offer to the market for let an exceptional apartment, set within a beautiful period building in the heart of Shepherd's Bush. This property comprises of a bright reception room with large windows that allow in plenty of natural light, an elegant feature fire place, modern kitchen with fitted appliances and a master bedroom with excellent fitted storage. You can also find a second stunning double bedroom and a smart family bathroom. Lime Grove is ideally located close to shops, bars and restaurants while also ideal for commuters. Excellent transport links at Shepherd's Bush Market, Goldhawk Road (Circle / Hammersmith & City Line) and Shepherd's Bush station (Central Line / Overground) all within walking distance.



Approximate Gross Internal Area = 63.7 sq m / 686 sq ft

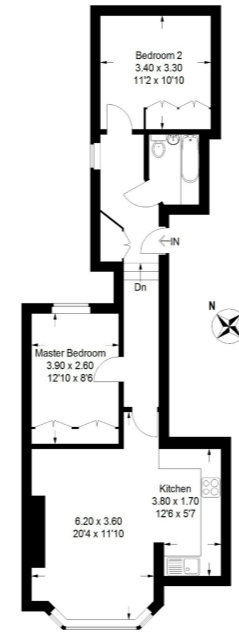

Illustration for identification purposes only, measurements are approximate, not to scale. FloorplansUsketch.com © 2015 (ID 179757)