



**Odette Court, Station Road, Borehamwood, WD6**

**£335,000**



## Odette Court, Station Road, Borehamwood, WD6

An ideally located and generously proportioned two bedroom, two bathroom apartment located on the third floor (with lift) with balcony and an allocated parking space.

This fine apartment would make an ideal first time purchase or buy to let investment and further benefits from a spacious open plan kitchen/reception, two spacious bedrooms and delightful balcony.

Odette Court is perfectly situated just yards away from Elstree & Borehamwood station (Thameslink) with the local shops, amenities and restaurants found on Shenley Road also close by.

### Features

- Balcony
- Allocated Parking Space
- Two Double Bedrooms
- Two Bathrooms
- Yards Away from Elstree & Borehamwood station
- Long Lease
- Ideal First Time Purchase or Buy-To-Let Investment
- Spacious Open Plan Kitchen/Reception
- Third Floor (with lift)







Odette Court, Station  
Road, Borehamwood,  
WD6

## Odette Court, WD6 1GQ

Approx Gross Internal Area = 67.92 sq m / 731 sq ft

Balcony = 7.77 sq m / 84 sq ft

Total = 75.69 sq m / 814 sq ft

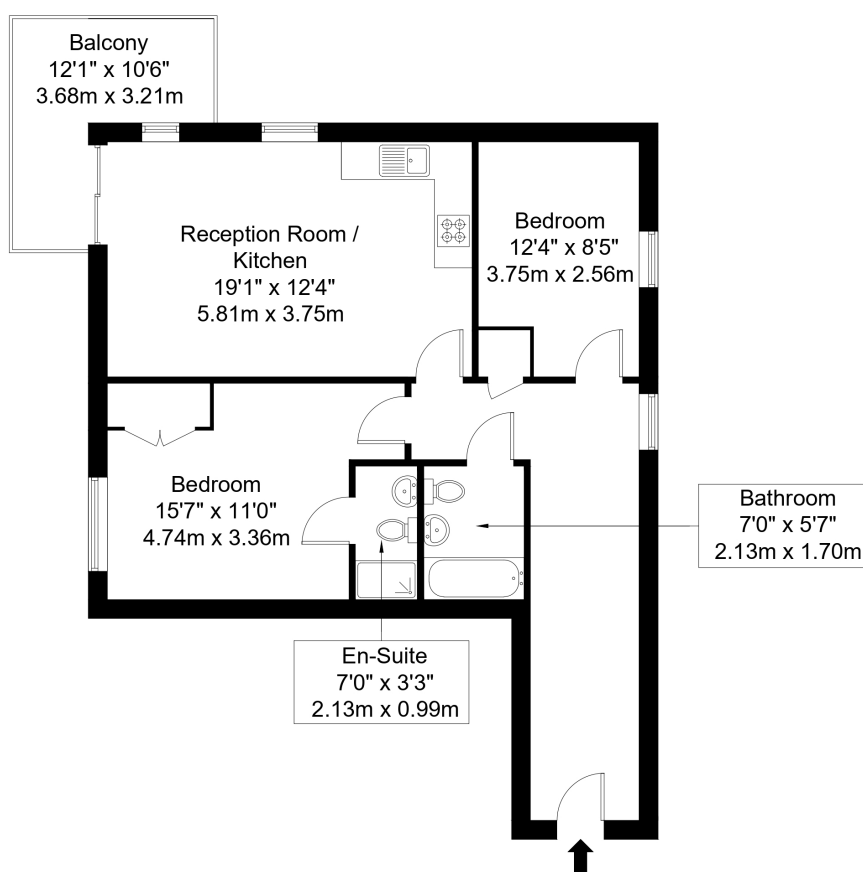
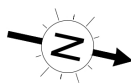

Third Floor

Ref :

Copyright

**B L E U  
P L A N**

The Floor plan is not to scale and measurements and areas shown are approximate and therefore should be used for illustrative purposes only. The plan has been prepared in accordance with the RICS code of Measuring Practice and whilst we have confidence in the information produced it must not be relied on. Maximum lengths and widths are represented on the floor plan. If there is any aspect of particular importance, you should carry out or commission your own inspection of the property.

Copyright @ BleuPlan