

Truuli



Sunny Bank, London, SE25

£575,000 Freehold

- Victorian family home
- Period features throughout
- Modern and Stylish Kitchen / Breakfast room
- Polished concrete work tops
- Engineered real wood flooring
- Bright and airy throughout
- Under floor heating in kitchen and up stairs bathroom
- Crittal windows & doors to rear aspect
- Landscaped rear garden
- Off street parking
- Short walk to Norwood Junction railway station & local amenities

2, Lansdowne Road, Croydon, London, CR9 2ER

Tel: 0330 043 0002

Email: save@truuli.co.uk Web: www.truuli.co.uk

Sunny Bank, London, SE25

£575,000 Freehold

Please click to read vendor comments and arrange a viewing for this recently renovated three-bedroom Victorian family home, ideally located in the cul-da-sac of Sunny bank.

Ground Floor
647 sq.ft. (60.1 sq.m.) approx.

1st Floor
442 sq.ft. (41.1 sq.m.) approx.

2nd Floor
229 sq.ft. (21.2 sq.m.) approx.

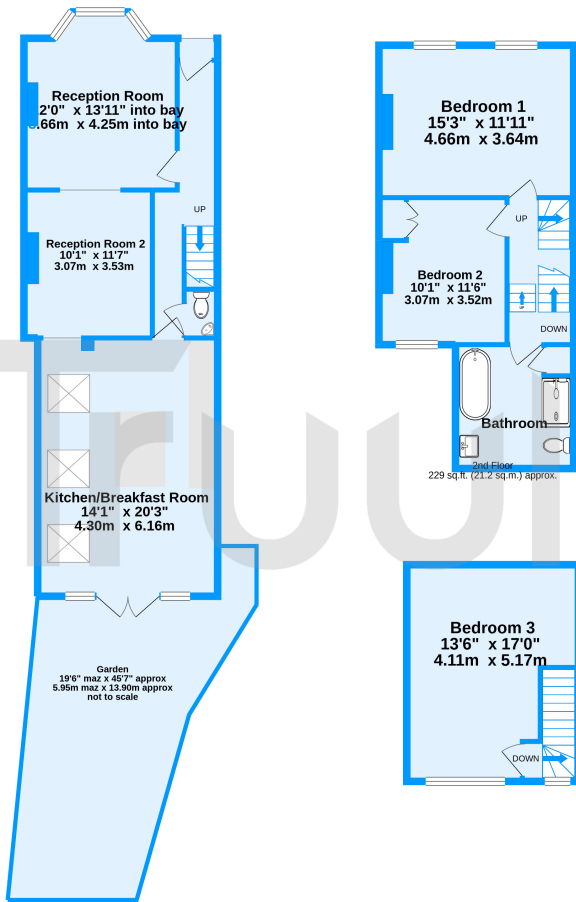

Sunny Bank, London, SE25

TOTAL FLOOR AREA : 1317 sq.ft. (122.4 sq.m.) approx.

Whilst every attempt has been made to ensure the accuracy of the floorplan contained here, measurements of doors, windows, rooms and any other items are approximate and no responsibility is taken for any error, omission or mis-statement. This plan is for illustrative purposes only and should be used as such by any prospective purchaser. The services, systems and appliances shown have not been tested and no guarantee as to their operability or efficiency can be given.
Made with Metropro ©2021

Energy Efficiency Rating		Environmental Impact (CO ₂) Rating	
	Current	Potential	Predicted
<i>Very energy efficient - lower running costs</i>			
(92 to 100) A			
(81 to 91) B			
(69 to 80) C		75	
(55 to 68) D			
(39 to 54) E	51		
(21 to 38) F			
(1 to 20) G			
<i>Not energy efficient - higher running costs</i>			
EU Directive 2002/91/EC			
England, Wales & N.Ireland			
<i>Very environmentally friendly - lower CO₂ emissions</i>			
(92 to 100) A			
(81 to 91) B			
(69 to 80) C			
(55 to 68) D			
(39 to 54) E			
(21 to 38) F			
(1 to 20) G			0
<i>Not environmentally friendly - higher CO₂ emissions</i>			
EU Directive 2002/91/EC			
England, Wales & N.Ireland			

