



2 Chapel Court, Langford, Bedfordshire, SG18 9JS

Guide Price £160,000

**** FOR SALE BY ONLINE AUCTION ** POST AUCTION OFFERS INVITED **** Two bedroom first floor apartment with two allocated parking spaces. Good sized accommodation with en-suite shower room to master bedroom and balcony off the dining room/bedroom. Possible investment opportunity (as currently tenanted) or ideal first home.



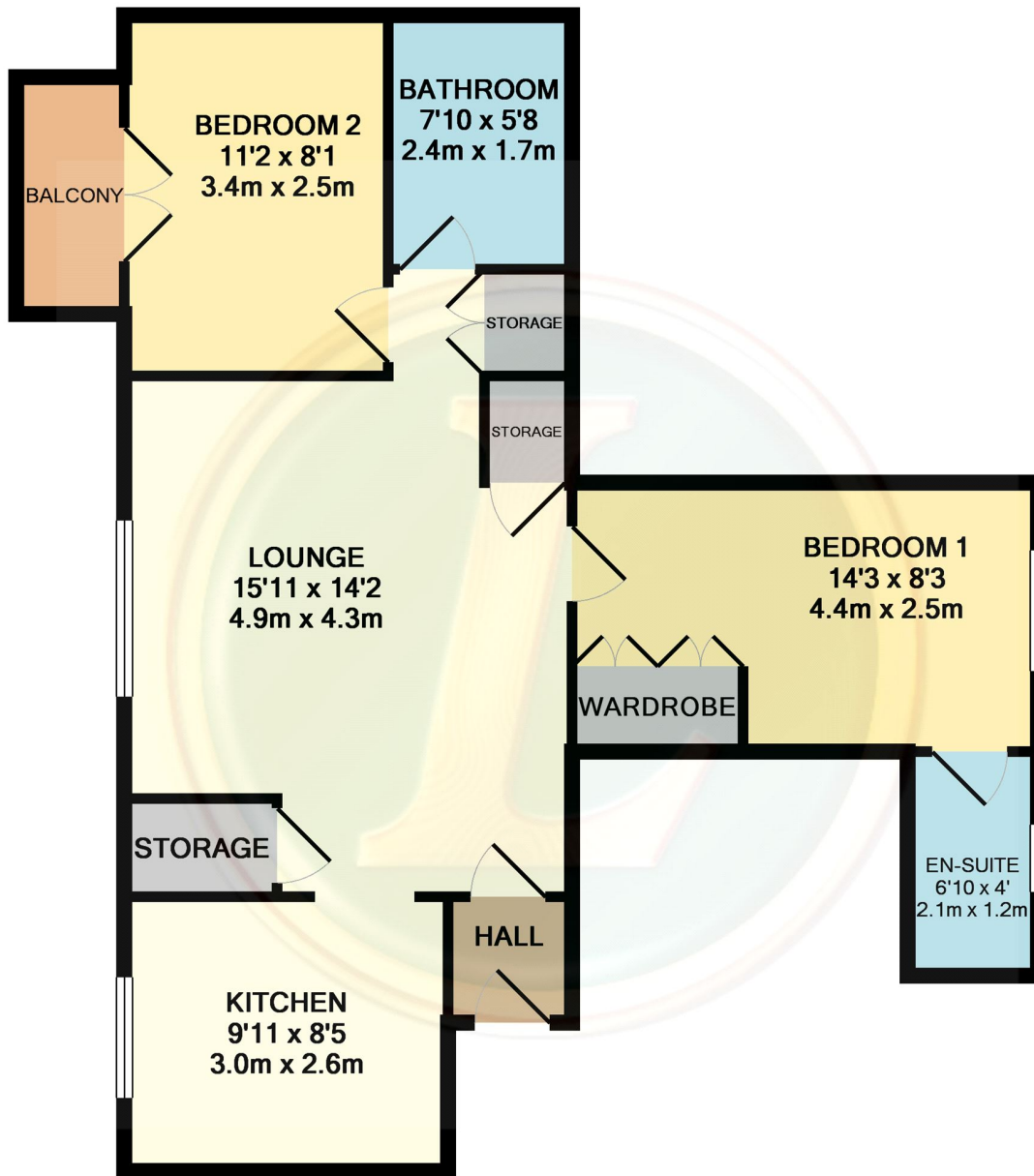

- TWO BEDROOM FIRST FLOOR FLAT
- AVAILABLE CHAIN FREE
- LARGE LOUNGE
- EN-SUITE PLUS BATHROOM
- BALCONY
- TWO ALLOCATED PARKING SPACES
- GAS CENTRAL HEATING
- BUYERS FEE APPLIES
- AUCTION PACK AVAILABLE ON REQUEST
- EPC C / COUNCIL TAX BAND C



TOTAL APPROX. FLOOR AREA 641 SQ.FT. (59.6 SQ.M.)
 Measurements are approximate. Not to scale. Illustrative purposes only
 Made with Metropix ©2017