

Truuli



College Green, London, SE19

£150,000 Leasehold

- Chain free
- In need of cosmetic work throughout
- Bright and airy throughout
- Excellent views of South London
- Close proximity to Crystal Palace "Triangle", Park and Overground station
- Cash buyers only

Southbridge Place, Surrey, CR0 4HA

Tel: 0330 043 0002

Email: save@truuli.co.uk Web: www.truuli.co.uk

College Green, London, SE19

£150,000 Leasehold

*** CASH BUYERS ONLY *** Located on the 7th floor of this purpose-built building is this adequately spaced double-bedroom apartment with excellent views of the Crystal palace area. In need of modernisation, this property is priced for a swift sale with added bonus of being chain free.

7th Floor
546 sq.ft. (50.7 sq.m.) approx.

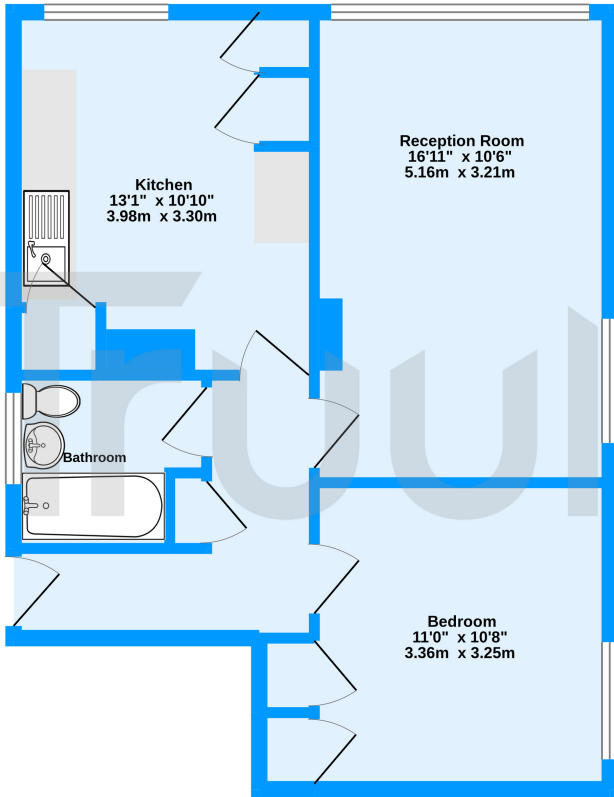

College Green, South Norwood, SE19

TOTAL FLOOR AREA: 546 sq.ft. (50.7 sq.m.) approx.

Whilst every attempt has been made to ensure the accuracy of the floorplan contained here, measurements of doors, windows, rooms and any other items are approximate and no responsibility is taken for any error, omission or mis-statement. This plan is for illustrative purposes only and should be used as such by any prospective purchaser. The services, systems and appliances shown have not been tested and no guarantee as to their operability or efficiency can be given.
Made with Metropix ©2022

Energy Efficiency Rating		
	Current	Potential
Very energy efficient - lower running costs		
(92-100) A		
(81-91) B		
(69-80) C		
(55-68) D	62	67
(39-54) E		
(21-38) F		
(1-20) G		
Not energy efficient - higher running costs		
EU Directive 2002/91/EC 