

FOR
SALE



208 Belmont Road, Hereford HR2 7HA

£205,000 - Freehold

22, Broad Street, Hereford, HR4 9AP 01432 355455 hereford@flintandcook.co.uk

PROPERTY SUMMARY

A 3-bedroom semi-detached property situated in a popular residential location with driveway parking, garage and requiring modernisation throughout.

POINTS OF INTEREST

- 3 bedroom semi detached house
- Popular residential area
- Garage & driveway parking
- Requires modernisation



ROOM DESCRIPTIONS

Front door leads into the Entrance Hall

Fitted carpet, radiator, window to the side aspect, cupboard housing the fuseboard and meters, carpeted staircase leading to the first floor and doors leading into the

Kitchen

Matching wall and base units, worksurfaces, stainless steel sink and drainer, space for free-standing cooker and free-standing fridge/freezer, under-counter space for washing machine, gas central heating boiler, understairs storage cupboard/pantry, radiator, vinyl flooring, door and window leading to the rear porch and opening into the

Dining Room

Wooden flooring, radiator, sliding doors into the rear garden.

Living Room

Fitted carpet, radiator, bay window to the front.

Rear Porch

Fitted carpet, windows and door to the rear.

First floor landing

Fitted carpet, window to the side aspect, radiator, airing cupboard with hot water cylinder.

Separate WC

Low flush cistern, opaque window and tiled floor.

Bathroom

Suite comprising panelled bath with electric shower over, pedestal wash hand-basin, opaque window, tiled floor, heated towel rail.

Bedroom 1

Fitted carpet, radiator, window to the front and built-in wardrobes with sliding doors.

Bedroom 2

Fitted carpet, radiator, window to the rear aspect and built-in cupboard.

Bedroom 3

Fitted carpet, radiator, window to the front aspect.

Outside

To the front of the property iron gates provide access to the concrete driveway with parking for several vehicles leading to the rear and GARAGE with up-and-over door, light and power. The remainder of the front garden is laid to lawn, enclosed by brick-walling and fencing. To the rear, there is a paved patio area leading to the remainder of the garden which is mainly laid to lawn and enclosed by hedging and fencing together with a greenhouse.

Services

Mains water, electricity, drainage and gas are connected. Telephone (subject to transfer regulations). Gas-fired central heating.

Outgoings

Council tax band B - payable 2023/24 £1713.95

Water and drainage - rates are payable/metered supply.

Money laundering regulations

Prospective purchasers will be asked to produce identification, address verification and proof of funds at the time of making an offer.

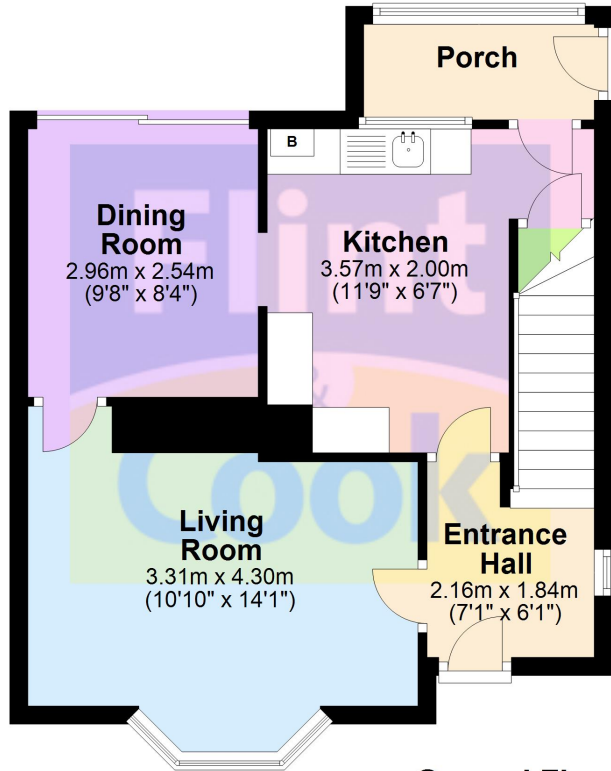
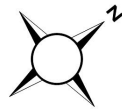

Ground Floor
Approx. 41.5 sq. metres (446.5 sq. feet)

First Floor
Approx. 40.7 sq. metres (438.6 sq. feet)



Total area: approx. 82.2 sq. metres (885.1 sq. feet)

This plan is for illustrative purposes only
Plan produced using PlanUp.

These particulars are prepared for the guidance only of prospective purchasers. They are intended to give a fair and overall description of the property and do not constitute the whole or any part of an offer or contract. Any information contained herein (whether in text, plans or photographs) is given in good faith but should not be relied upon as being a statement or representation of fact. Any plans provided by the agents and/or with the sales particulars are intended for guidance purposes only; we cannot guarantee the accuracy and scale of any plans, and they do not form any part of the sales contract. Nothing in these particulars shall be deemed to be a statement that the property is in good condition or otherwise nor that any services or facilities are in good working order. Any movable contents, fixtures and fittings, (whether wired or not) referred to in these property particulars (including any shown in the photographs) are, unless the particulars say otherwise, excluded from the sale. In the event that the buyer proposes to purchase any movable contents or include them in any offer for the property, the buyer cannot in any respect imply any such inclusion from the property particulars. Any areas, measurements or distances referred to herein are approximate only and may be subject to amendment. It should not be assumed that the property has all necessary planning, building regulation or other consents and these matters must be verified by an intending purchaser. The information in these particulars is given without responsibility on the part of the agents or their clients and neither the agents nor their employees have any authority to make or give any representations or warranties whatever in relation to this property.

Flint & Cook Privacy Statement: We take your privacy very seriously. Your data will not be shared with any other parties without your express permission. Our Data protection Policy can be read in full on the Flint & Cook website, www.flintandcook.co.uk

| Energy Efficiency Rating | | |
|---|-----------|-----------|
| | Current | Potential |
| Very energy efficient - lower running costs | | |
| (92+) | A | |
| (81-91) | B | |
| (69-80) | C | |
| (55-68) | D | |
| (39-54) | E | |
| (21-38) | F | |
| (1-20) | G | |
| Not energy efficient - higher running costs | | |
| | | 82 |
| | 60 | |
| England, Scotland & Wales | | |
| EU Directive 2002/91/EC | | |