

FOR SALE

£275,000

Lloyd Drive, Greasby, Wirral. CH49 1TB



Popular Family Location! This home has been lovingly maintained and credit has to go to the home owners for the immaculate presentation throughout. Bursting with kerb appeal this is a home that has to be viewed to fully appreciate what is on offer.





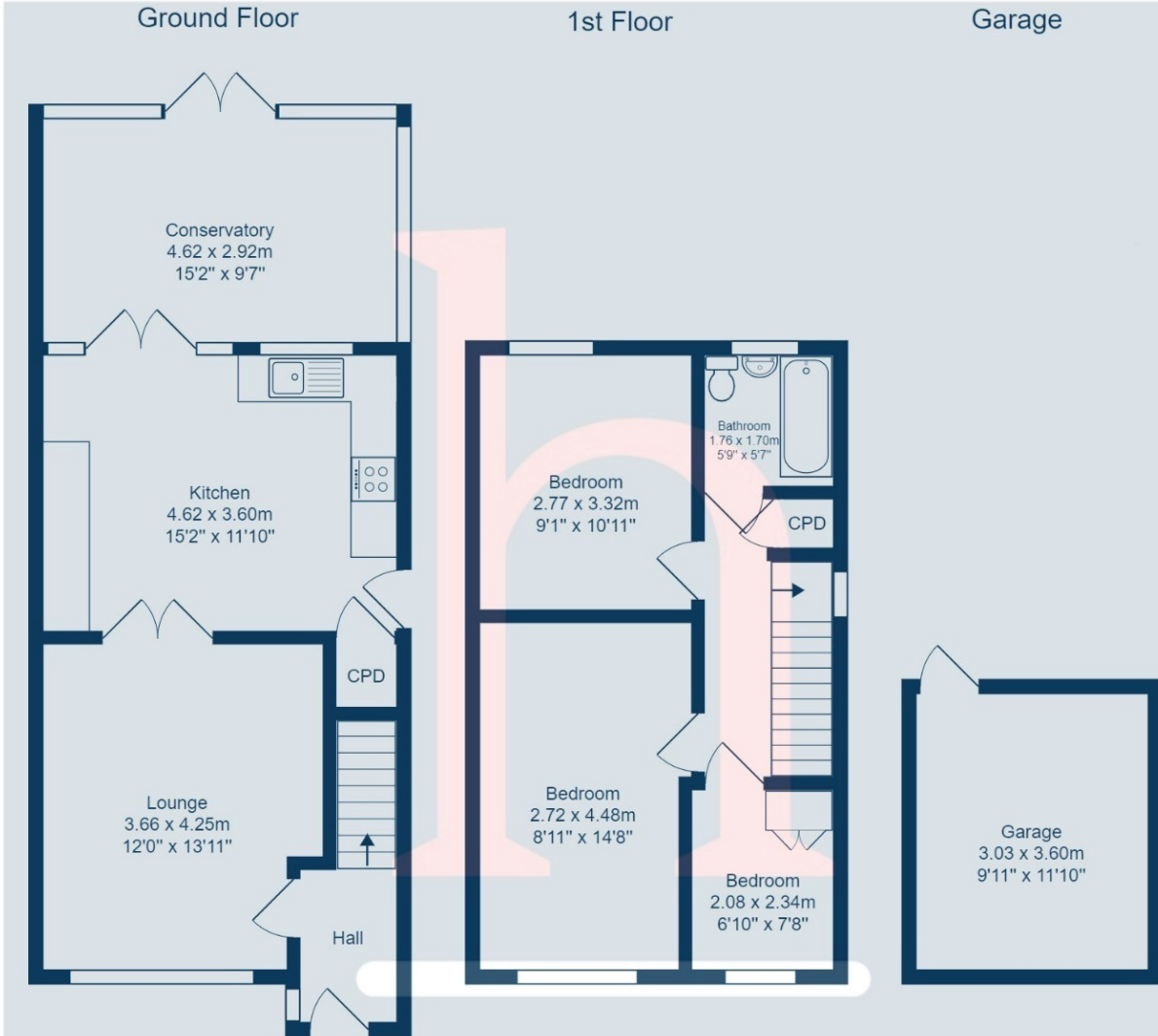

Total Area: 89.5 m² ... 964 ft² (excluding garage)
 All measurements are approximate and for display purposes only.

| Energy Efficiency Rating | | Current | Potential |
|----------------------------------------------------|----------|--------------------------------------------------------------------------------------------------------------|-----------|
| <i>Very energy efficient - lower running costs</i> | | | |
| (92+) | A | | |
| (81-91) | B | | 85 |
| (69-80) | C | | |
| (55-68) | D | 69 | |
| (39-54) | E | | |
| (21-38) | F | | |
| (1-20) | G | | |
| <i>Not energy efficient - higher running costs</i> | | | |
| England, Scotland & Wales | | EU Directive 2002/91/EC  | |