

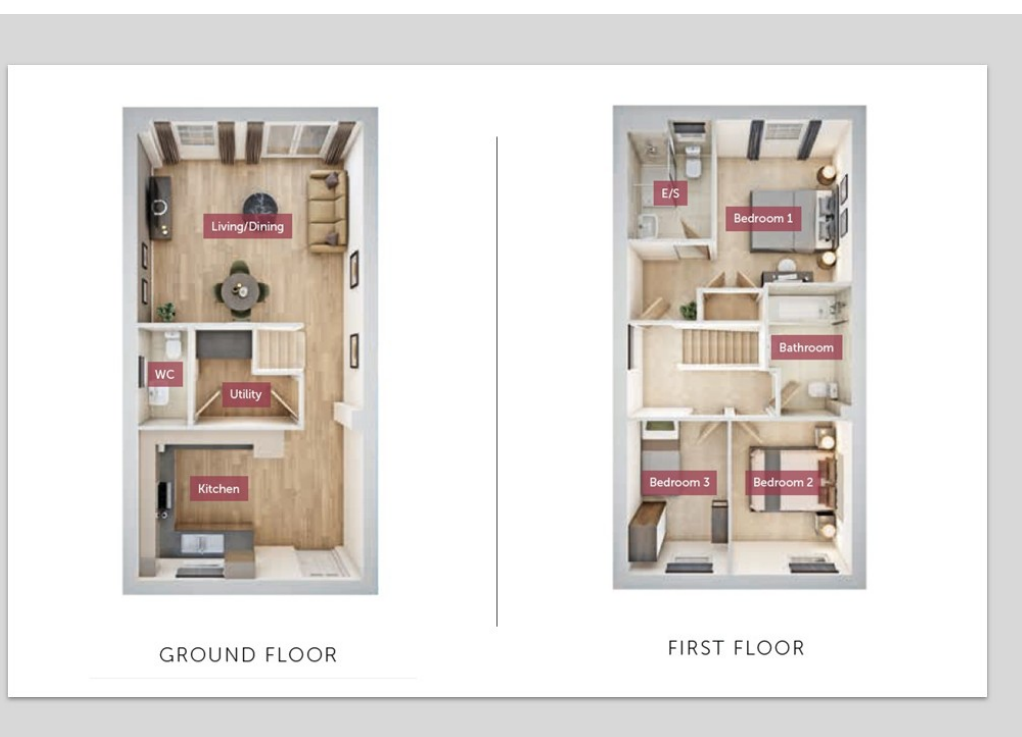

## Corby Glen

£147,000



Rosedale Property Agents are delighted to offer for sale this superb property at The Orchards (Plot 56). A three bedroom property available through the Home Reach Shared Ownership scheme – A perfect opportunity to step onto the property ladder. Situated on the outskirts of the sought-after village of Corby Glen, this property combines the charm of countryside living with the convenience of having the A1 which is less than 5 miles away. The house itself offers a semi-open-plan bright and modern interior with contemporary kitchen and comfortable lounge. To the first floor are three bedrooms, a Master ensuite and a modern family bathroom. Outside, you'll find an enclosed rear garden and off road parking to the front, complete with EV charger. With shares available from as little as 50%, this is a fantastic opportunity to own your very own, brand new home in a highly desirable location. If you're a first-time buyer, looking to downsize or are curious if this could be your best option, call our office to understand how the process works and to get your viewing booked in today. THE PRICE SHOWN IS FOR A 60% SHARE - FULL MARKET VALUE IS £245,000 (shares are available from 50%).