



# Millstream Close

Hitchin,  
Hertfordshire, SG4 0DB  
Guide Price £370,000

COUNTRY PROPERTIES  
PART OF HUNTERS



Set within a quiet cul-de-sac area of the Millstream Close development is this delightful three bedroom home.

This well presented property is within a mile of both the Hitchin town centre and the mainline train station, making it appealing for all types of buyer. The accommodation of this property is versatile and well balanced featuring a bright living room with a separate kitchen / diner on the ground floor, three bedrooms and a family bathroom on the first floor. To the rear there is a private and enclosed garden backing on to a wooded area and the River Purwell. To the front there is allocated parking.

Hitchin is a charming medieval market town and has many fine Tudor and Georgian buildings, particularly around the market square. Near to the market square stands the large medieval parish church of St Mary. The town provides good shopping as well as a swimming pool, football team, two theatres, a wide variety of restaurants and pubs and highly regarded girls and boys schools. There is also a mainline railway station providing direct access to Kings Cross and Cambridge.

- Quiet cu-de-sac location
- Three bedroom family home
- Separate kitchen / diner
- Allocated parking to front
- 0.8 miles, 15 min walk to Hitchin train station (as per Google maps)
- 0.8 mile, 15 mins walk to Hitchin town centre (as per Google maps)











Floor 0 Building 1

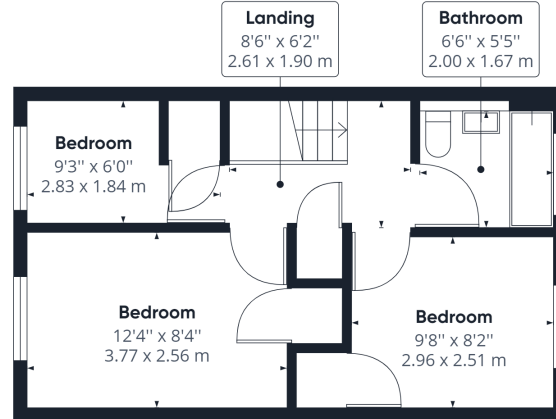

Floor 1 Building 1

Approximate total area<sup>(1)</sup>

706.54 ft<sup>2</sup>  
65.64 m<sup>2</sup>

Reduced headroom

8.62 ft<sup>2</sup>  
0.80 m<sup>2</sup>

(1) Excluding balconies and terraces

⌄ Reduced headroom  
(below 1.5m/4.92ft)

While every attempt has been made to ensure accuracy, all measurements are approximate, not to scale. This floor plan is for illustrative purposes only.

GIRAFFE360

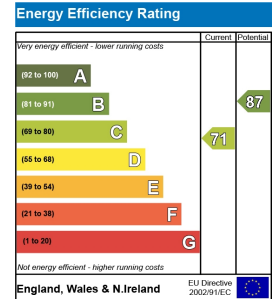

All measurements are approximate and quoted in metric with imperial equivalents and for general guidance only and whilst every attempt has been made to ensure accuracy, they must not be relied on. The fixtures, fittings and appliances referred to have not been tested and therefore no guarantee can be given and that they are in working order. Internal photographs are reproduced for general information and it must not be inferred that any item shown is included with the property. For a free valuation, contact the numbers listed on the brochure.

Viewing by appointment only

Country Properties | 6, Brand Street | SG5 1HX

T: 01462 452951 | E: hitchin@country-properties.co.uk

www.country-properties.co.uk

