



Two Bedroom Terraced House
Silverbank, Chatham, Kent, ME5 0LQ

£250,000
Freehold

Silverbank, Chatham, Kent, ME5 0LQ

£250,000

Freehold

Description

Being offered with no chain is this two bedroom terraced home which would be excellent for first time buyers or investors alike. Situated in a popular location and close to local amenities and bus services into Chatham Town Centre. Accommodation comprises of entrance hall with staircase to the first floor, the kitchen is to the front which is open plan to the lounge/diner and the kitchen comprises of wall and base units, breakfast bar and worksurfaces over. The lounge is to the rear with side patio doors leading out to the garden. Moving upstairs, you have two bedrooms and a bathroom. Externally offers a rear garden, laid to lawn with patio area and 2 allocated parking spaces to the front.

Please call the Walderslade Sales Team for further details.

Key Features

- No Forward Chain
- Ideal First Time Buyers Home
- Open Plan Living
- Cul-de-sac position
- Allocated Parking Space
- Two Bedrooms
- Close to Local Amenities
- Garden

Local Area

Chatham is located within the Medway towns with good transfer links by rail into Central London and Ebbsfleet International plus road connections to the M2/M25 & M20. Amenities include a bustling Town Centre, the Historic Dockyard, Capstone Ski & Snowboard centre and nearby Gillingham FC and Rochester Castle & Cathedral.

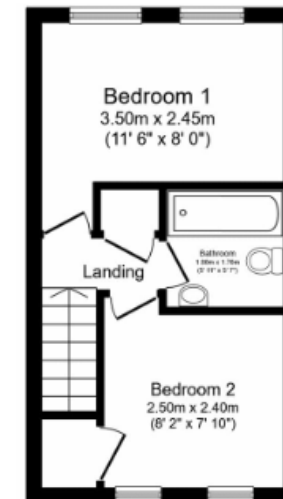
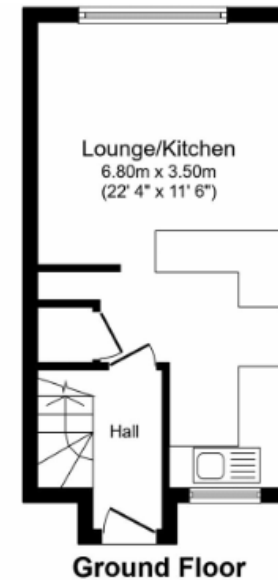

First Floor

Total floor area 47.5 sq.m. (511 sq.ft.) approx

This floor plan is for illustrative purposes only. It is not drawn to scale. Any measurements, floor areas (including any total floor area), openings and orientation are approximate. No details are guaranteed. They cannot be relied upon for any purpose and they do not form part of any agreement. No liability is taken for any error, omission or misstatement. A party must rely upon its own inspection(s). Plan produced for Your Move. Powered by www.focagent.com



Property Location

Silverbank, Chatham, Kent, ME5 0LQ

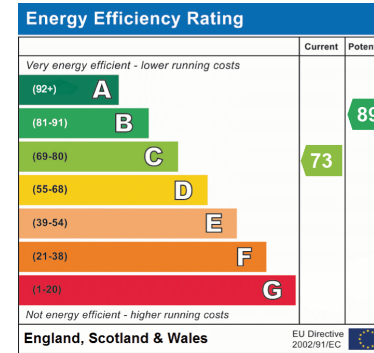

Tenure	Freehold
Lease Term	N/A
Ground Rent	N/A
Service Charge	N/A
Local Authority	Medway
Council Tax	Band C

Greyfox Walderslade

Unit 2, Thetford House
Walderslade Village Centre
Walderslade Road
Chatham
Kent

ME5 9LR

Tel: 01634 672227 Email:
walderslade@greyfox.co.uk

Greyfox Rainham

67C High Street
Rainham
Kent
ME8 7HS

Tel: 01634 377737 Email:
rainham@greyfox.co.uk

Agent Notes

These particulars are prepared as a general guide to a broad description of the property and should not be relied upon as a statement or representation of fact and do not constitute part of an offer or contract. The seller does not make or give nor do our employees or Greyfox have authority to make or give any representation or warranty to the property. We have not carried out a structural survey and the services, appliances and specific fittings have not been tested. All photographs, measurements, floorplans and distances referred to are given as a guide only and should not be relied upon for the purchase of carpets or any other fixtures or fittings. Lease details, service charges and ground rent (where applicable) and council tax are given as a guide only and should be checked and confirmed by you on inspection and your solicitor prior to exchange of contracts. If there are any points of particular importance to you we will be pleased to check the information for you and to confirm that the property remains available. This is particularly important should you be travelling some distance to view and where statements have been made by us to the effect that the information has not been verified. The copyright of all details, photographs and floorplans remain exclusive to Greyfox. For details of our privacy policy and referral fee arrangements with any of our selected partner companies please visit <https://www.greyfox.co.uk/legal/privacy> and <https://www.greyfox.co.uk/referral-fees>.