



daniels
danielsestateagents.co.uk

daniels
danielsestateagents.co.uk



High Street, Harlesden, London NW10 4ST
£500,000 - Share of Freehold



PROPERTY DESCRIPTION

OVER 800 SQFT OF LIVING SPACE...

A delightfully presented TWO DOUBLE BEDROOM ground floor flat located within close proximity to Willesden Junction bakerloo and overground station.

The property boasts BAY FRONTED RECEPTION ROOM, KITCHEN BREAKFAST ROOM with access TO PRIVATE SOUTH WEST FACING REAR GARDEN with two access points one via the side of the building and the second via the kitchen, FITTED BATHROOM and TWO DOUBLE BEDROOMS at the rear. The property is unique and is split level at the rear of the building offering a bedroom on both the ground floor and first floor levels.

Shops, restaurants and bars are only a moments walk away.

POINTS OF INTEREST

- TWO DOUBLE BEDROOMS
- SPLIT LEVEL FLAT
- PERIOD CONVERSION
- WELL PRESENTED
- CLOSE TO WILLESDEN JUNCTION STATION
- KITCHEN / DINER
- PRIVATE SOUTH WEST FACING GARDEN
- LEASEHOLD REMAINING OVER 90 YEARS

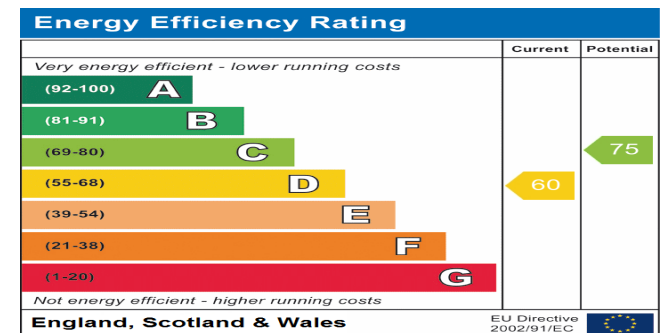



High Street, NW10

CAPTURE DATE 19/01/2023 LASER SCAN POINTS 53,216,605

GROSS INTERNAL AREA

74.45 sqm / 801.37 sqft

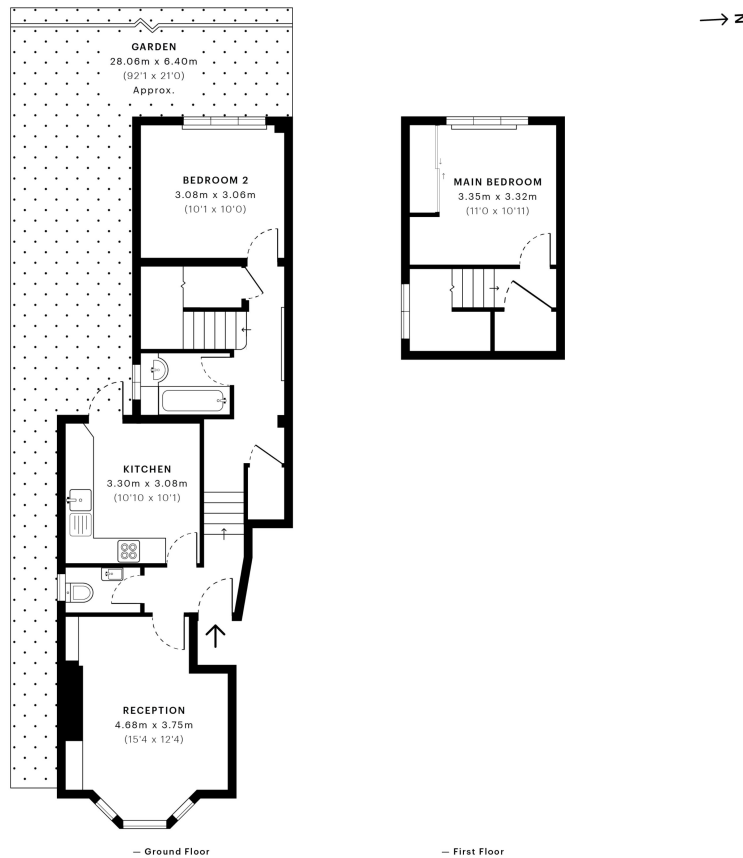

GROSS INTERNAL AREA (GIA)
The interior of the property
74.45 sqm / 801.37 sqft

NET INTERNAL AREA (NIA)
Excludes walls and external features
Includes mezzanine, restricted head height
66.67 sqm / 717.63 sqft

EXTERNAL STRUCTURAL FEATURES
Balconies, terraces, verandas etc.
0.00 sqm / 0.00 sqft

RESTRICTED HEAD HEIGHT
Limited use areas under 1.8m
0.00 sqm / 0.00 sqft



Spec Verified floor plans are produced in accordance with Royal Institution of Chartered Surveyors' Property Measurement Standards. Plans and garden area illustrative only and excluded from all area calculations. Due to rounding, numbers may not add up precisely. All measurements shown for the individual room lengths and widths are the maximum points of measurements captured in the scan.

PMR 58 RESIDENTIAL: 70.29 sqm / 758.79 sqft
PMR 30 RESIDENTIAL: 68.87 sqm / 739.63 sqft

SPEC ID: 563c676b1f7c710dfb63adaf