

Peter Lane & Partners, for themselves as agents for the Vendors or Lessors of this property give notice that these particulars are produced in good faith and are to act purely as a guide to the property and therefore do not constitute any part of any contract. Peter Lane & Partners or any employee thereof do not have the authority to make or give any warranty, guarantee or representation whatsoever in relation to this property.

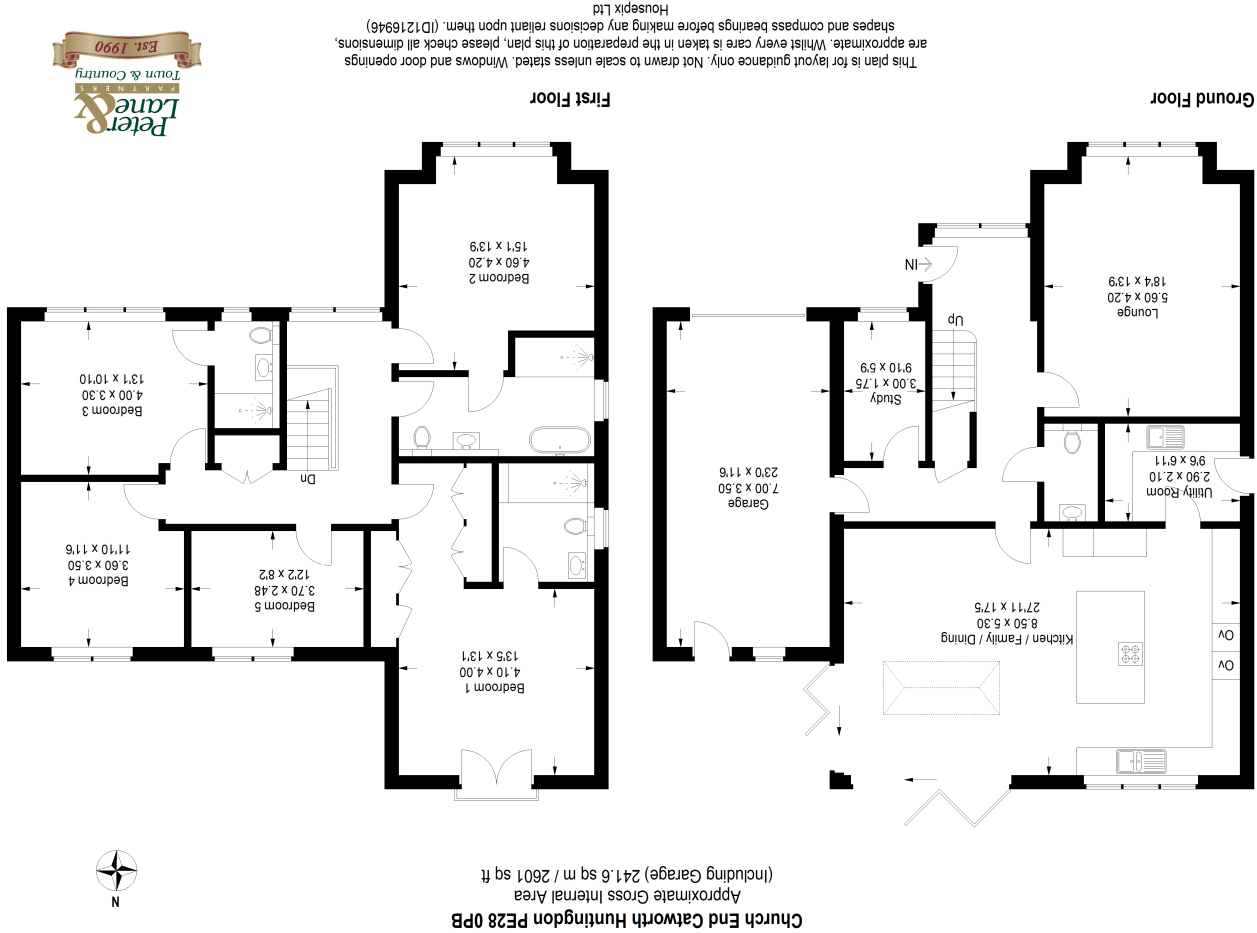

Huntingdon  
60 High Street  
Tel : 01480 414800  
Huntingdon  
St Neots  
Tel : 01480 406400  
Huntingdon  
32 Market Square  
Tel : 01480 860400  
Huntingdon  
24 High Street  
Tel : 01480 860400  
Huntingdon  
15 Thayer St, London  
Tel : 0870 1127099  
Mayfair Office  
Cashel House

www.peterlane.co.uk Web office open all day every day  
Kimbolton Office: 01480 860400



23A Church End • Catworth • Cambridgeshire • PE28 0PB



23A CHURCH END ● CATWORTH  
● CAMBRIDGESHIRE ● PE28 0PB  
OFFERS OVER £950,000

- Outstanding New Home in village location enjoying uninterrupted countryside views.
- Generously proportioned with around 2,350 square feet of wonderfully versatile living, entertaining and homeworking space.
- Welcoming reception hall with guest cloakroom.
- Stunning 28ft x 17ft kitchen/dining/family room with granite counters, quality cabinets and extensive glazing including large rooflight and two sets of bi-folding to the garden terrace.
- Adjacent laundry/utility room.
- Well-proportioned formal lounge and separate study/home office.
- Principal bedroom features dressing area with built-in wardrobes, en suite and Juliet balcony offering fabulous views over the garden and fields beyond.
- Four further double bedrooms, including guest room with en suite shower.
- Well-appointed 'Jack & Jill' family bathroom with bath and separate shower.
- Large garage, EV charging point and extensive parking/turning space.



A recently completed, generously proportioned village residence on generous plot with 2,350 sq. ft. of stunning accommodation and unrivalled views over open countryside.

