



This beautifully kept detached property has been proficiently extended, creating a stunning family home suitable for a large family, and is located within walking distance of all three local grammar schools.

The ground floor comprises three reception rooms, including a spacious sitting room with separate 11ft study/TV room, and an exceptional 25ft kitchen diner across the back of the property. A ground floor bedroom also benefits access to en-suite downstairs shower room.

The kitchen features a fantastic range of shaker-style cupboards and integrated appliances, all complemented by wooden worktops and underfloor heated tiled floor, giving a cosy cottage appeal to the extended portion of the property. Four skylight windows and French doors overlooking the delightful rear garden provide all day sunlight. Additionally there is a convenient utility room with space for white goods.

Four double bedrooms benefit from a range of fitted wardrobes, whilst the master bedroom, stretching 13ft, occupies another en-suite shower room.





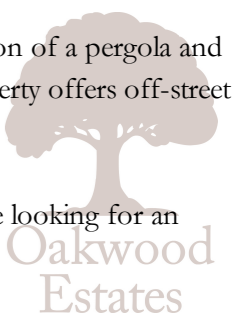
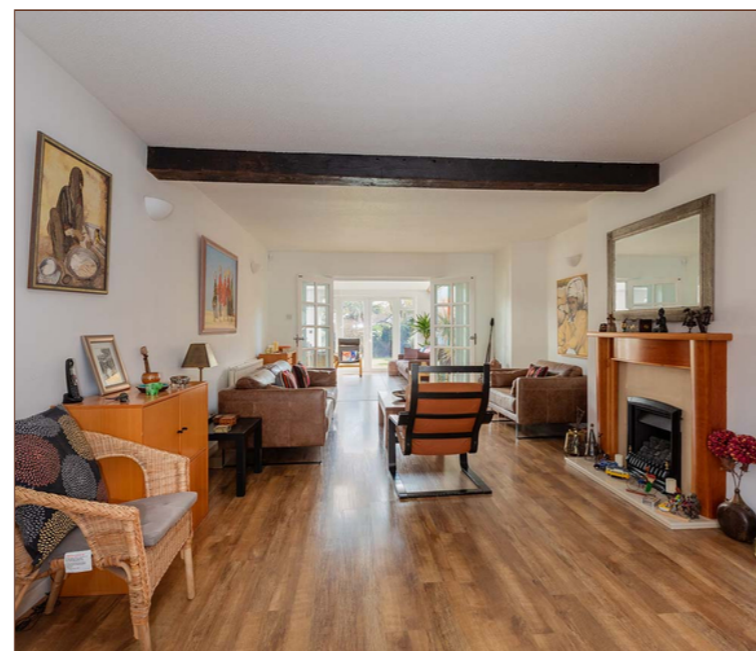



The attractive rear garden is of substantial size and has been immaculately landscaped, enjoying the addition of a pergola and shrubbery borders, creating a quiet sanctuary for outdoor enthusiasts. A driveway to the front of the property offers off-street parking for up to three cars.

The house has been kept to an extremely high standard, providing a charming family home for those looking for an immediate move.



# Property Information

# Floor Plan

-  STUNNING FIVE BEDROOM DETACHED FAMILY HOME
-  22FT LIVING ROOM WITH SEPARATE STUDY / TV LOUNGE TO THE FRONT
-  LARGE REAR EXTENSION
-  FITTED WARDROBES & EN-SUITE TO MASTER
-  DRIVEWAY PARKING FOR 3 CARS
-  OUTSTANDING 25FT MODERN KITCHEN
-  GROUND FLOOR BEDROOM WITH EN-SUITE SHOWER
-  CONVENIENT UTILITY ROOM
-  BEAUTIFULLY LANDSCAPED EAST-FACING GARDEN WITH PERGOLA AND THREE STORAGE UNITS
-  WALKING DISTANCE TO ALL THREE LOCAL GRAMMAR SCHOOLS

					
x5	x3	x3	x3	Y	N
Bedrooms	Reception Rooms	Bathrooms	Parking Spaces	Garden	Garage

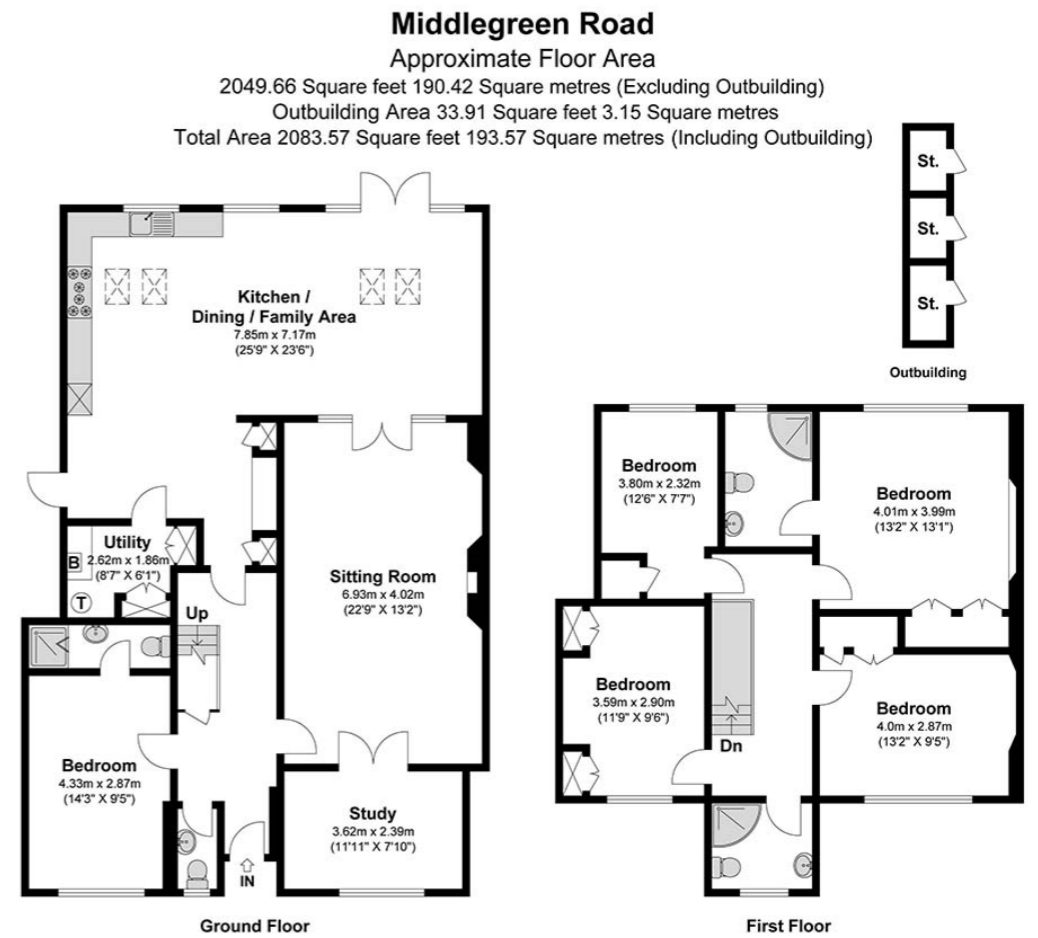

Illustrations are for identification purposes only, measurements are approximate, not to scale

Prospective purchasers should be aware that these sales particulars are intended as a general guide only and room sizes should not be relied upon for carpets or furnishing. We have not carried out any form of survey nor have we tested any appliance or services, mechanical or electrical. All maps are supplied by Goview.co.uk from Ordnance Survey mapping. Care has been taken in the preparation of these sales particulars, which are thought to be materially correct, although their accuracy is not guaranteed and they do not form part of any contract.

### Transport Links

#### NEAREST STATIONS:

Langley - 1.2 miles

Slough - 1.2 miles

Datchet - 2.5 miles

### Local Schools

#### PRIMARY SCHOOLS

Ryvers School

0.3 miles away

The Langley Academy Primary

0.5 miles away

Castlevew Primary School

0.7 miles away

Langley Hall Primary School

0.8 miles away

#### SECONDARY SCHOOLS

Langley Academy

0.5 miles away

St Bernard's Catholic Grammar School

0.6 miles away

Langley Grammar School

0.7 miles away

Upton Court Grammar School

0.8 miles away

Ditton Park Academy

0.9 miles away

Long Close School

1.1 miles away

#### Council Tax

Band G

