



Cardwell Street,
Northwood



OneAgency

01782 970222

hello@oneagencygroup.co.uk



Offers in Excess of £100,000

A three bedroom mid terraced house in the popular location of Northwood. Benefitting from modern accommodation, double glazing and good sized rear yard. An ideal first time buy or buy to let investment. Close to Hanley Town Centre, commuter links, schools and amenities. Viewing is highly advised. No Chain!





Ground Floor

Reception Room One

3.39m x 3.09m (11' 1" x 10' 2") UPVC front door, double glazed window to the front, radiator and laminate flooring.

Reception Room Two

3.39m x 3.41m (11' 1" x 11' 2") A double glazed window to the rear, radiator and laminate flooring.

Kitchen

3.30m x 1.23m (10' 10" x 4' 0") A range of wall and base units with worktops, stainless steel sink basin with mixer tap, integral oven and gas hob with extractor hood over, plumbing for a washing machine, double glazed window and laminate flooring.

Bathroom

2.15m x 1.82m (7' 1" x 6' 0") A white suite with bath, pedestal hand wash basin, low level W/C, tiled walls, double glazed window and laminate flooring.

First Floor

Bedroom One

4.32m x 3.07m (14' 2" x 10' 1") A double glazed window to the front, radiator and carpet flooring.

Bedroom Two

3.95m x 2.07m (13' 0" x 6' 9") A fitted wardrobe unit, double glazed window to the rear, radiator and carpet flooring.

Bedroom Three

3.95m x 2.07m (13' 0" x 6' 9") A fitted wardrobe unit, double glazed window to the rear, radiator and carpet flooring.

External

A paved yard area, steps leading to lawned section and gated access.

AGENTS NOTES

The council tax band is A. The local authority is Stoke-on-Trent.

GROUND FLOOR

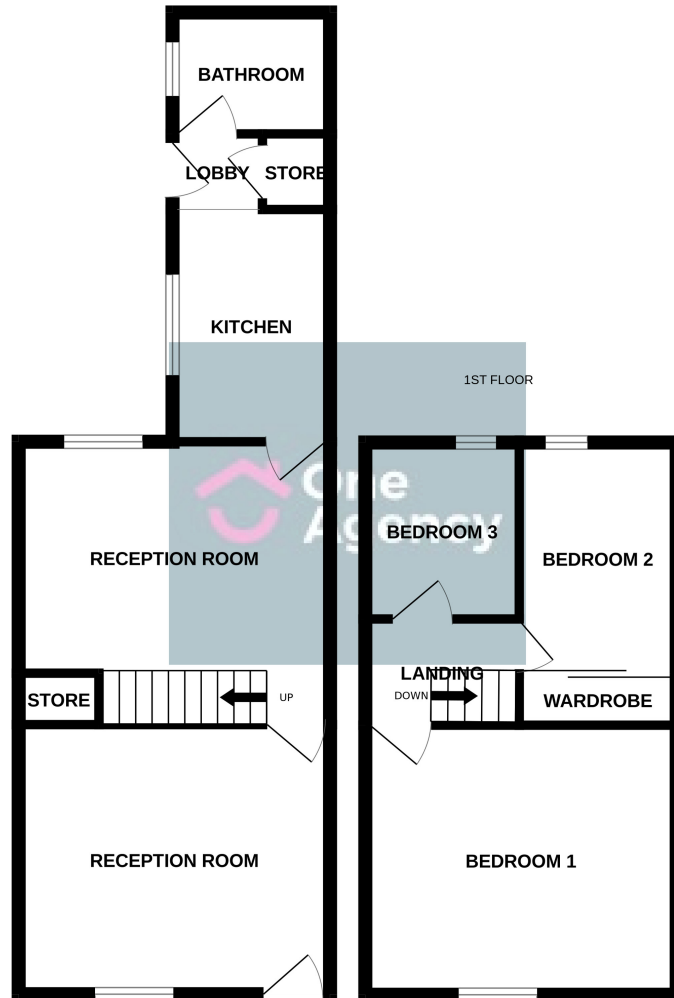

Whilst every attempt has been made to ensure the accuracy of the floorplan contained here, measurements of doors, windows, rooms and any other items are approximate and no responsibility is taken for any error, omission or mis-statement. This plan is for illustrative purposes only and should be used as such by any prospective purchaser. The services, systems and appliances shown have not been tested and no guarantee as to their operability or efficiency can be given.
Made with Metropix ©2023

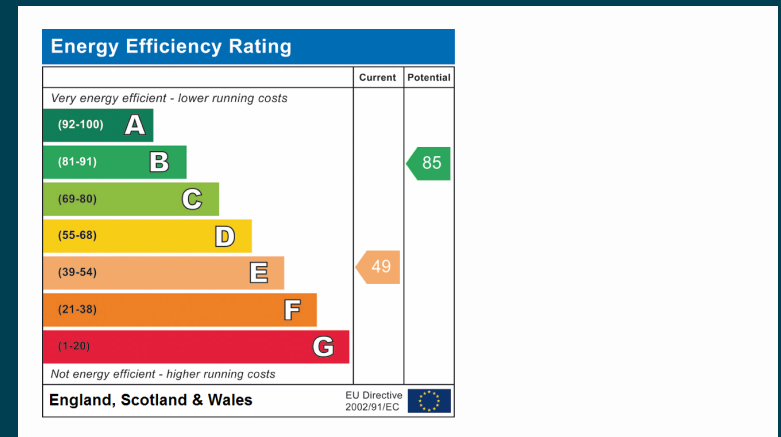

OneAgency, 9 & 10 Ridge House Drive, Festival Park, Stoke-on-Trent, ST1 5SJ

01782 970222

hello@oneagencygroup.co.uk

Every attempt has been made to ensure accuracy, however, all measurements are approximate and for illustrative purposes only. **Not to scale.**

In accordance with The Consumer Protection from Unfair Trading Regulations 2008 the following particulars have been prepared in good faith and they are not intended to constitute part of an offer or contract. We have not carried out a structural survey and the services, appliances and specific fittings have not been tested. All photographs, measurements, floor plans and distances referred to are given as a guide only and should not be relied upon for the purchase of carpets or any other fixtures and fittings. Lease details, service charges and ground rent (where applicable) are given as a guide only and should be checked and confirmed by your Solicitor prior to exchange of contracts.