



## Habershon Drive, FRIMLEY, Surrey GU16 9TW

PRICE £300,000 Freehold

\*NO ONWARD CHAIN\* Jigsaw Estates are pleased to present to the market this end of terrace property situated in a quiet cul-de-sac location on the popular Cheylesmore Park development on the Frimley & Camberley borders. The property is a 5 minute walk from Pine Ridge Gold Club and also within close proximity of local amenities including a number of shops on the neighbouring Heatherside development. Accommodation comprises two bedrooms, lounge/diner and kitchen. Further benefits include a shower room, double glazing and a secluded rear garden with side access. There is an adjacent communal parking area which has plenty of parking spaces. In our opinion this would make an ideal first time or investment purchase.

Mis-descriptions Act: We wish to inform prospective purchasers that we have not carried out a detailed survey or tested the services, appliances and specific fittings including any heating system for this property. Floorplans shown are for illustrative purposes only and are not drawn to scale.



- COUNCIL TAX BAND = C
- TWO BEDROOMS
- REAR GARDEN
- WALKING DISTANCE TO LOCAL AMENITIES
- NO ONWARD CHAIN
- LOUNGE/DINER
- QUIET CUL-DE-SAC LOCATION

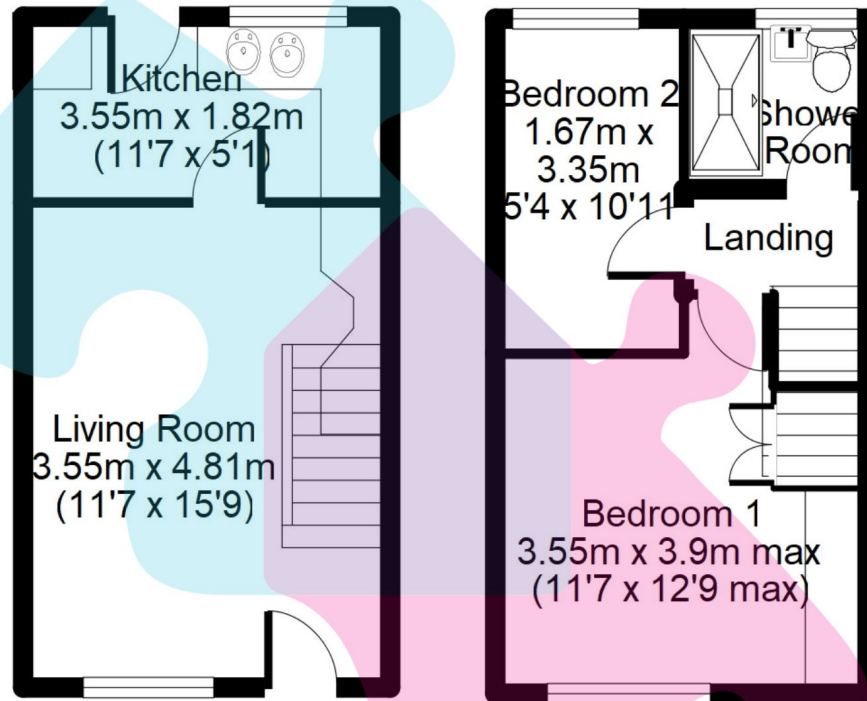

Approx. Total Floor Area:  
48 Sq M = 516 Sq Ft

Floorplan is for Illustration purposes only.  
All measurements are approximate and should be verified.

