



Flat 2 122 Bucks Road, Douglas.

Well presented first-floor flat in convenient central location



£139,950 Leasehold

PROPERTY DESCRIPTION

Situated in the heart of Douglas, this charming one-bedroom apartment offers a perfect blend of modern living and central convenience. Positioned on the first floor, the flat boasts a bright and spacious lounge/diner that forms the heart of the home, ideal for relaxing or entertaining guests. Large windows flood the space with natural light, complementing the sleek, modern kitchen which is equipped with all the essentials to inspire your culinary creativity.

The double bedroom is nicely sized and features built-in wardrobes, providing excellent storage solutions while maintaining a clean, uncluttered feel. The neutral décor throughout enhances the sense of space and light, creating a welcoming and comfortable atmosphere that you will be proud to call home.

Location is key, and this flat excels in providing an enviable central location within Douglas. Just minutes away from local shops, cafes, restaurants, and transport links, everything you need is within easy reach.

The property is currently let, offering an immediate return on investment. Positioned in the heart of Douglas, it benefits from consistently high rental demand from working professionals, thanks to its close proximity to the town centre and key business hubs. Competitive pricing combined with a strong rental profile makes this an excellent prospect for investors seeking a well-located, income-generating asset.

FEATURES

- Well Presented 1st Floor Flat
- Central Location in Douglas
- Spacious Lounge/Diner with Modern Kitchen
- Double Bedroom with Fitted Wardrobes
- Modern Bathroom



Property Images



FLOORPLAN



GROUND FLOOR
443 sq.ft. (41.2 sq.m.) approx.

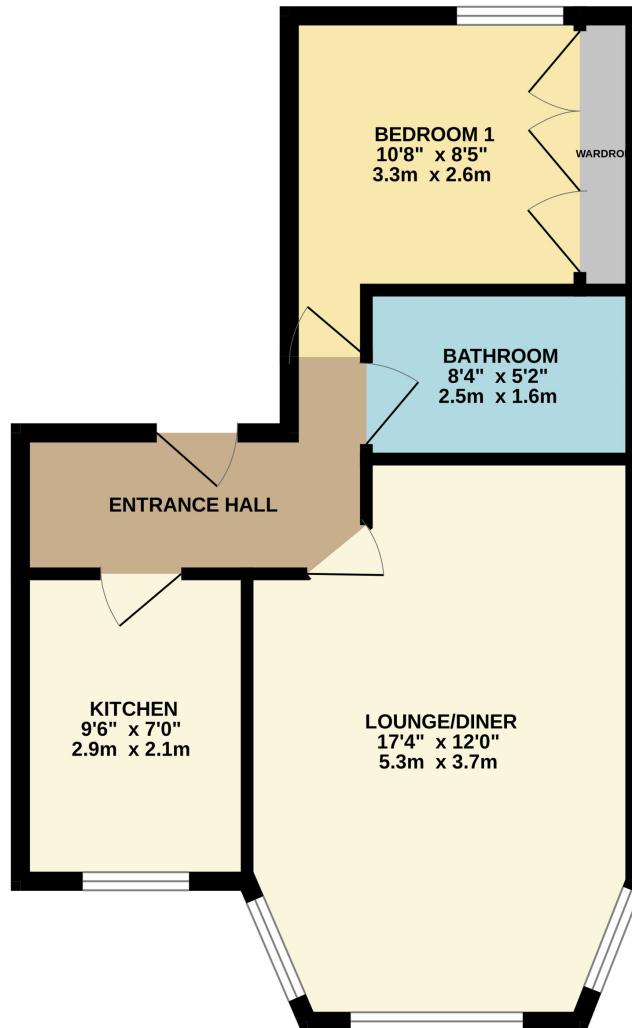

TOTAL FLOOR AREA : 443 sq.ft. (41.2 sq.m.) approx.

Whilst every attempt has been made to ensure the accuracy of the floorplan contained here, measurements of doors, windows, rooms and any other items are approximate and no responsibility is taken for any error, omission or mis-statement. This plan is for illustrative purposes only and should be used as such by any prospective purchaser. The services, systems and appliances shown have not been tested and no guarantee as to their operability or efficiency can be given.
Made with Metropix ©2026

DISCLAIMER: Whilst Manxmove Ltd believe that these details are correct, neither Manxmove Ltd or their clients guarantee their accuracy in any way. Consequently, these details are not to be used to form part of any legally binding contract. Prospective purchasers or tenants are advised to visit this property to satisfy themselves as to the correctness of these details. Please note, we use wide angle camera lenses in order to show as much of each room as possible. This is not intended to mislead any prospective purchasers or tenants in any way and an honest verbal description is always available prior to viewing if required.

Manxmove Estate Agents - Douglas
Victoria Road, Douglas, IM2 4HD
01624 619966
info@manxmove.im